

+

SPEZIFIKATION 2021/2022

FÜR FAHRZEUGE • specification for cars • спецификация автомобилей



**AUCH ONLINE! FIND ON WEBSITE!
ТАКЖЕ НА САЙТЕ!**

**Scheibenwischer finden - ganz einfach.
The easy way to find a wiper blade.
Простой способ найти щётку.**

www.heyner.com



Spezielles Adaptersystem

special adapter system • специальная система адаптеров



Art.-Nr. 300 030
TOP LOCK B - TLB
Adapter*



Art.-Nr. 300 130
SIDE LOCK - SL
Adapter



Art.-Nr. 300 230
TOP LOCK - TL
Adapter



Art.-Nr. 300 330
PINCH TAB - PT
Adapter



Art.-Nr. 300 430
BAYONET LOCK - BL
Adapter

* Adapter ist nur für die Sortimente HYBRID, ALL SEASONS & SUPER FLAT PREMIUM geeignet. • adapter is suitable for the HYBRID, ALL SEASONS & SUPER FLAT PREMIUM assortments only • Адаптер подходит только для assortиментов HYBRID, ALL SEASONS & SUPER FLAT PREMIUM.



Art.-Nr. 300 530
SLIM TOP - ST
Adapter



Art.-Nr. 300 730
CENTRAL LOCK - CL
Adapter



Art.-Nr. 300 830
TOP LOCK A/C - TLAC/C
Adapter



Art.-Nr. 300 930
TOP LOCK M - TLM
Adapter



Art.-Nr. 298 000
HOOK ONE - B1
Adapter



Germany

PREMIUM-WISCHERBLÄTTER

wiper blades • щётки стеклоочистителей

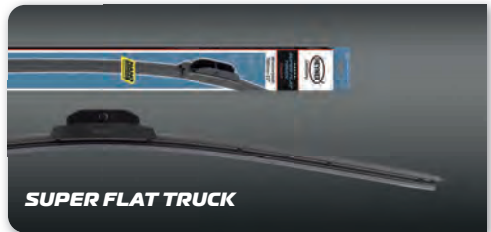
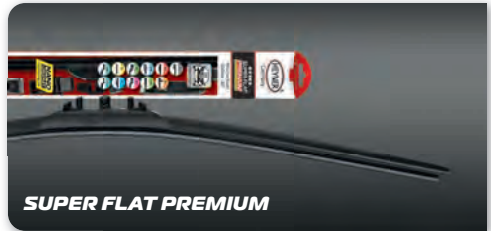



Spezielles Adaptersystem

special adapter system • специальная система адаптеров



Art.-Nr. 300 030
TOP LOCK B - TLB
Adapter*



Art.-Nr. 300 130
SIDE LOCK - SL
Adapter



Art.-Nr. 300 230
TOP LOCK - TL
Adapter



Art.-Nr. 300 330
PINCH TAB - PT
Adapter



Art.-Nr. 300 430
BAYONET LOCK - BL
Adapter

* Adapter ist nur für das Sortiment SUPER FLAT geeignet. • adapter is suitable for the SUPER FLAT assortment only • Адаптер подходит только для ассортимента SUPER FLAT.



Art.-Nr. 300 530
SLIM TOP - ST
Adapter



Art.-Nr. 300 730
CENTRAL LOCK - CL
Adapter



Art.-Nr. 300 830
TOP LOCK A/C-
TLA/C Adapter



Art.-Nr. 300 930
TOP LOCK M - TLM
Adapter





Wischerblätter

wiper blades • щётки стеклоочистителей



SUPER FLAT



UNIVERSAL



SPECIAL



START



TRUCK



WINTER



REAR CLASSIC



REAR FLAT



ist ein eingetragenes Warenzeichen der alca mobil logistics + services gmbh.

Symbol	Product	Information
Frontwischerblatt / windscreen wiper blade / Передняя щётка		
B1	HOOK ONE Adapter / HOOK ONE adapter / HOOK ONE адаптер - inklusive / inclusive / включён	
TLB	TOP LOCK B-Adapter separat erhältlich / separately / отдельно	<i>nur / only / только HYBRID, ALL SEASONS, SUPER FLAT PREMIUM & SUPER FLAT</i>
SL	SIDE LOCK-Adapter separat erhältlich / separately / отдельно	
TL	TOP LOCK-Adapter separat erhältlich / separately / отдельно	
TL ^{BF}		BF: Butterfly-System (z.B. FORD FOCUS III) siehe Seite 77 / see page 77 / на стр. 77
PT	PINCH TAB-Adapter separat erhältlich / separately / отдельно	
BL	BAYONET LOCK-Adapter separat erhältlich / separately / отдельно	FLAT TAB-Wischerarm (z.B. AUDI A6 Allroad 4FH)
BLFT		
ST	SLIM TOP-Adapter separat erhältlich / separately / отдельно	Mini-SIDE LOCK-Wischerarm (z.B. MERCEDES-BENZ E-KLASSE W211)
STSL		
CL	CENTRAL LOCK-Adapter separat erhältlich / separately / отдельно	
TLA	TOP LOCK A/C Adapter separat erhältlich / separately / отдельно	TOP LOCK A-Wischerarm (z.B. TOYOTA AVENTIS T27)
TLC		TOP LOCK C-Wischerarm (z.B. TOYOTA C-HR)
TLM	TOP LOCK M Adapter separat erhältlich / separately / отдельно	TOP LOCK M-Wischerarm (z.B. MERCEDES-BENZ E-KLASSE W213)
TR	TRUCK-Wischerblatt / TRUCK-wiper blade / TRUCK-щётка Adapter inklusive / adapter inclusive / адаптер включён	TRUCK-Wischerblatt notwendig. TRUCK wiper blade necessary. Необходима щётка TRUCK
Heckwischerblätter / rear wiper blades / стеклоочиститель заднего стекла		
R0	REAR FLAT Heckwischer / rear wiper / задняя щётка Adapter inklusive / adapter inclusive / адаптер включён	Direkte Montage ohne Adapter. Direct installment without adapter. Простой монтаж без адаптера.
R1	REAR FLAT Heckwischer / rear wiper / задняя щётка Adapter inklusive / adapter inclusive / адаптер включён	
R2	REAR FLAT Heckwischer / rear wiper / задняя щётка Adapter inklusive / adapter inclusive / адаптер включён	
R3	REAR FLAT Heckwischer / rear wiper / задняя щётка Adapter inklusive / adapter inclusive / адаптер включён	
R4	REAR FLAT Heckwischer / rear wiper / задняя щётка Adapter inklusive / adapter inclusive / адаптер включён	
RA	REAR CLASSIC Heckwischer / rear wiper / задняя щётка Adapter inklusive / adapter inclusive / адаптер включён	
RB	REAR CLASSIC Heckwischer / rear wiper / задняя щётка Adapter inklusive / adapter inclusive / адаптер включён	
RD	REAR CLASSIC Heckwischer / rear wiper / задняя щётка Adapter inklusive / adapter inclusive / адаптер включён	
RD+	REAR CLASSIC Heckwischer / rear wiper / задняя щётка Adapter inklusive / adapter inclusive / адаптер включён	Adapter nur mit RD Adapter nutzbar. Adapter usable only with the RD adapter. Адаптер только с RD адаптер.
RE	REAR CLASSIC Heckwischer / rear wiper / задняя щётка Adapter inklusive / adapter inclusive / адаптер включён	<i>nur / only / только HEYNER REAR CLASSIC</i>
RG	REAR CLASSIC Heckwischer / rear wiper / задняя щётка Adapter inklusive / adapter inclusive / адаптер включён	

Autemarke / car-type марка автомобиля		Baujahr year of manufacture год выпуска			Fahrer / Driver водитель			Beifahrer Passenger пассажир			Heck / Rear заднее стекло C=CLASSIC/F=FLAT		
					cm	inch	Ad	cm	inch	Ad	cm	inch	Ad
ALFA ROMEO													
33	907A	Jul 90 → Sep 94	45	18	B1	45	18	B1					
146	930	Dez 94 → Jan 01	53	21	B1	48	19	B1					
147	937	Jan 01 → Jun 05	56	22	B1	40	16	B1					
		Apr 05 → Mrz 10	56	22	SL	40	16	SL					
156	932	Okt 97 → Sep 05	56	22	B1	50	20	B1					
156 Sportwagon	932	Jun 00 → Dez 05	56	22	B1	50	20	B1					
159	939	Sep 05 → Nov 11	58	23	SL	45	18	SL					
159 Sportwagon	939	Mrz 06 → Dez 10	58	23	SL	45	18	SL					
166	939	Okt 98 → Jun 07	53	21	B1	48	19	B1					
BRERA		Jan 06 → Dez 10	58	23	SL	45	18	SL					
GIULIETTA	940	Apr 10 →	60	24	TL	45	18	TL	C35	C14	RD		
GT	937	Nov 03 → Apr 05	56	22	B1	40	16	B1					
		Apr 05 → Sep 10	56	22	SL	40	16	SL					
GTV	916C	Mai 98 → Okt 05	56	22	B1	50	20	B1					
MITO	955	Sep 08 →	65	26	PT	38	15	PT	C30	C12	RD		
SPIDER	916S	Jun 95 → Apr 05	56	22	B1	50	20	B1					
	939	Sep 06 → Dez 10	58	23	SL	45	18	SL					
ASTON MARTIN													
DBS Vantage Coupé		Sep 07 →	65	26	TL	50	20	TL					
DBS Volante Cabriolet		Sep 07 →	65	26	TL	50	20	TL					
RAPIDE Coupé		Mrz 10 →	65	26	TL	50	20	TL					
V8 Vantage Coupé		Okt 08 →	65	26	TL	50	20	TL					
V8 Vantage Roadster		Okt 08 →	65	26	TL	50	20	TL					
V12 Vantage Coupé		Sep 09 →	65	26	TL	50	20	TL					
VIRAGE Vantage Coupé		Jun 11 →	65	26	TL	50	20	TL					
VIRAGE Volante Cabriolet		Jun 11 →	65	26	TL	50	20	TL					
AUDI													
80	B4	Sep 91 → Dez 94	53	21	B1	53	21	B1					
80 Avant	B4	Sep 91 → Jul 95	53	21	B1	53	21	B1	C40	C16	RD+		
100	C4	Dez 90 → Jun 94	56	22	B1	53	21	B1					
100 Avant	C4	Sep 91 → Jun 94	56	22	B1	53	21	B1	45	18	B1		

A
B
C
D
E
F
G
H
I
J
K
L
M
N
O
P
Q
R
S
T
U
V
W
X
Y
Z

Automarke / car-type марка автомобиля	Baujahr year of manufacture год выпуска	Fahrer / Driver водитель			Beifahrer Passenger пассажир			Heck / Rear заднее стекло C=CLASSIC / F=FLAT			
		cm	inch	Ad	cm	inch	Ad	cm	inch	Ad	
... AUDI											
A1	8X1, 8XF	Mai 10 →	60	24	ST	40	16	ST	F35	F14	R0
A1 Sportback	8XA, 8XK	Sep 11 →	60	24	ST	40	16	ST	F30	F12	R0
	GBA	Jul 19 →	65	26	ST	45	18	ST	F25	F10	R0
A2	8Z0	Feb 00 → Jun 01	70	28	TR						
		Jul 01 → Aug 05	70	28	SL						
A3	8L1	Sep 96 → Mai 03	53	21	B1	48	19	B1	C35	C14	RD+
	8P1	Jun 03 → Nov 04	60	24	SL	48	19	SL			
		Dez 04 → Aug 12	60	24	PT	48	19	PT			
8V1	Feb 13 →	65	26	ST	48	19	ST	F35	F14	R0	
A3 Cabriolet	8P7	Apr 08 → Mai 13	60	24	PT	45	18	PT			
	8V7	Okt 13 →	65	26	ST	48	19	ST			
A3 Limousine	8VS	Okt 13 →	65	26	ST	48	19	ST			
A3 Sportback	8PA	Sep 04 → Nov 04	60	24	SL	48	19	SL			
		Dez 04 → Mrz 13	60	24	PT	48	19	PT			
	8VA	Mrz 13 →	65	26	ST	48	19	ST	F35	F14	R0
A4	8D2, B5	Nov 94 → Dez 98	53	21	B1	53	21	B1			
	8E2, B6	Jul 02 → Dez 04	56	22	CL	53	21	CL			
	8EC, B7	Nov 04 → Jun 08	56	22	CL	53	21	CL			
	8K2, B8	Sep 08 → Aug 15	60	24	ST	50	20	ST			
	B9	Mai 15 →	60	24	ST	50	20	ST			
A4 Allroad	8KH, B8	Apr 09 → Apr 16	60	24	ST	50	20	ST	F40	F16	R0
	8WH, B9	Jan 16 →	60	24	ST	50	20	ST	F40	F16	R0
A4 Avant	8D5, B5	Nov 94 → Dez 98	53	21	B1	53	21	B1	C35	C14	RD+
	8E5, B6	Nov 03 → Dez 04	56	22	CL	53	21	CL			
	8ED, B7	Nov 04 → Jun 08	56	22	CL	53	21	CL			
	8K5, B8	Apr 08 → Aug 15	60	24	ST	50	20	ST	F40	F16	R0
	B9	Mai 15 →	60	24	ST	50	20	ST	F40	F16	R0
A4 Cabriolet	8H7, 8HE, B6, B7	Dez 03 → Mrz 09	56	22	CL	53	21	CL			
A5	8T3	Sep 07 → Okt 07	60	24	TL	50	20	TL			
		Nov 07 → Jan 17	60	24	ST	50	20	ST			
	F53	Jun 16 →	60	24	ST	50	20	ST			
A5 Cabriolet	8F7	Mrz 09 → Jan 17	60	24	ST	50	20	ST			
	F57	Jan 16 →	60	24	ST	50	20	ST			
A5 Sportback	8TA	Sep 09 → Jan 17	60	24	ST	50	20	ST			
	F5A	Jun 16 →	60	24	ST	50	20	ST			

Autemarke / car-type марка автомобиля		Baujahr year of manufacture год выпуска	Fahrer / Driver водитель			Beifahrer Passenger пассажир			Heck / Rear заднее стекло C=CLASSIC/F=FLAT		
			cm	inch	Ad	cm	inch	Ad	cm	inch	Ad
A6	4A, C4	Jun 94 → Okt 97	56	22	B1	53	21	B1			
	4B, C5	Apr 97 → Mai 01	56	22	B1	53	21	B1			
		Jun 01 → Mai 04	56	22	CL	53	21	CL			
	4F2, C6	Jul 04 → Mrz 11	56	22	BLFT	56	22	BLFT			
A6 ALLROAD	4FH, C6	Mai 06 → Aug 11	56	22	BLFT	56	22	BLFT			
	4GH	Jan 12 →	65	26	ST	53	21	ST	F30	F12	R0
A6 Avant	4A, C4	Jun 94 → Okt 97	56	22	B1	53	21	B1	45	18	B1
	4B, C5	Feb 98 → Mai 01	56	22	B1	53	21	B1	38	15	B1
		Jun 01 → Jan 05	56	22	CL	53	21	CL	38	15	B1
	4F5, C6	Jun 05 → Mrz 11	56	22	BLFT	56	22	BLFT			
4G5, C7	Mai 11 →	65	26	ST	53	21	ST	F30	F12	R0	
A6 Avant Allroad	4BH, C5	Mai 00 → Aug 05	53	21	CL	53	21	CL			
A7 Sportback	4GA	Okt 10 →	60	24	ST	50	20	ST			
A8	4D2, 4D8	Jun 94 → Sep 02	56	22	B1	53	21	B1			
	4E	Jul 03 → Jul 10	60	24	CL	58	23	CL			
	4H	Jun 10 →	65	26	ST	53	21	ST			
CABRIOLET	8G7, B4	Jun 91 → Aug 00	56	22	B1	53	21	B1			
Q2	GAB	Jun 16 →	60	24	ST	48	19	ST	F30	F12	R0
Q3	8U	Jun 11 → Okt 18	60	24	ST	50	20	ST	F40	F16	R0
Q3 / Q3 Sportback	F3B, F3N	Jul 18 →	60	24	ST	50	20	ST	F30	F12	R0
Q5	8RB	Nov 08 → Mai 17	60	24	ST	50	20	ST	F30	F12	R0
	FYB	Mai 16 →	60	24	ST	50	20	ST	F38	F15	R0
Q7	4L	Mrz 06 → Aug 15	65	26	PT	65	26	PT			
	4M	Jan 15 →	65	26	ST	50	20	ST	F38	F15	R0
TT	8N3	Okt 98 → Apr 03	53	21	B1	53	21	B1			
		Mai 03 → Jun 06	53	21	SL	53	21	SL			
	8J3	Jul 06 → Aug 15	56	22	PT	53	21	PT			
	FV3	Jul 14 →	60	24	ST	50	20	ST			
TT Roadster	8N9	Okt 99 → Apr 03	53	21	B1	53	21	B1			
		Mai 03 → Jun 06	53	21	SL	53	21	SL			
	8J9	Mai 08 → Jun 14	56	22	PT	53	21	PT			
	FV9	Nov 14 →	60	24	ST	50	20	ST			
V8	44, 4C	Okt 91 → Feb 94	56	22	B1	53	21	B1			
BENTLEY											
ARNAGE 2		1999 → 2009	60	24	B1	60	24	B1			
AZURE		1995 → 2006	56	22	B1	56	22	B1			

A
B
C
D
E
F
G
H
I
J
K
L
M
N
O
P
Q
R
S
T
U
V
W
X
Y
Z

Automarke / car-type марка автомобиля	Baujahr year of manufacture год выпуска	Fahrer / Driver водитель			Beifahrer Passenger пассажир			Heck / Rear заднее стекло C=CLASSIC / F=FLAT			
		cm	inch	Ad	cm	inch	Ad	cm	inch	Ad	
BMW											
1	E87	Sep 04 → Aug 18	50	20	PT	50	20	PT	F25	F10	R3
	E81	Sep 07 → Dez 11	50	20	PT	50	20	PT			
	F20	Sep 11 → Jun 19	56	22	PT	45	18	PT	C30	C12	RA
	F21	Sep 12 →	56	22	PT	45	18	PT	C30	C12	RB
1 Cabriolet	E88	Mrz 08 → Okt 13	50	20	PT	50	20	PT			
1 Coupe	E82	Okt 07 → Okt 13	50	20	PT	50	20	PT			
2 Active Tourer	F45	Sep 14 →	65	26	TL	48	19	TL	C30	C12	RB
2 Gran Tourer	F46	Jul 14 →	65	26	TL	48	19	TL	F25	F10	R2
2 Cabriolet	F23	Mrz 14 →	56	22	PT	45	18	PT			
2 Coupe	F22	Mrz 14 →	56	22	PT	45	18	PT			
3	E36	Sep 90 → Feb 98	53	21	B1	50	20	B1			
	E46	Apr 98 → Feb 05	60	24	B1	50	20	B1			
	E90	Jan 05 → Aug 09	60	24	SL	48	19	SL			
		Sep 09 → Okt 11	60	24	PT	48	19	PT			
	F30, F35, F80	Feb 12 → Okt 18	60	24	PT	48	19	PT			
	G20, G80	Mrz 19 →	60	24	PT	48	19	PT			
3 Cabriolet	E36	Mrz 93 → Apr 99	53	21	B1	50	20	B1			
	E46	Apr 00 → Aug 06	60	24	B1	48	19	B1			
	E93	Okt 06 → Aug 09	60	24	SL	45	18	SL			
		Sep 09 → Okt 13	60	24	PT	40	16	PT			
3 Compact	E36	Mrz 94 → Aug 00	50	20	B1	50	20	B1	45	18	B1
	E46	Jun 01 → Dez 04	60	24	B1	48	19	B1			
3 Coupe	E36	Mrz 92 → Apr 99	53	21	B1	50	20	B1			
	E46	Apr 99 → Mai 06	60	24	B1	48	19	B1			
	E92	Sep 06 → Aug 09	60	24	SL	45	18	SL			
		Sep 09 → Jun 13	60	24	PT	40	16	PT			
3 GRAN TURISMO	F34	Jun 13 →	60	24	PT	48	19	PT			
3 Touring	E36	Mrz 95 → Okt 99	53	21	B1	50	20	B1	C35	C14	RD+
	E46	Okt 99 → Feb 05	60	24	B1	48	19	B1			
	E91	Sep 05 → Aug 09	60	24	SL	48	19	SL	F35	F14	R0
		Sep 09 → Mai 12	60	24	PT	48	19	PT	F35	F14	R0
	F31	Sep 12 → Jun 19	60	24	PT	48	19	PT	F30	F12	R0
	G21, G80	Jul 19 →	60	24	PT	48	19	PT	F30	F12	R0
4 Cabriolet	F33, F83	Mrz 14 →	60	24	PT	45	18	PT			
4 Coupe	F32, F82	Sep 13 →	60	24	PT	45	18	PT			

SPZIFIKATION FÜR FAHRZEUGE / Specification for cars • Спецификация автомобилей

Autemarke / car-type марка автомобиля		Baujahr year of manufacture год выпуска	Fahrer / Driver водитель			Beifahrer Passenger пассажир			Heck / Rear заднее стекло C=CLASSIC/F=FLAT		
			cm	inch	Ad	cm	inch	Ad	cm	inch	Ad
4 Gran Coupe	F36	Mai 14 →	60	24	PT	45	18	PT			
5	E60	Jul 03 → Feb 10	60	24	PT	58	23	PT			
	G30	Feb 17 →	65	26	TL	48	19	TL			
5 Touring	E61	Jun 04 → Aug 10	60	24	PT	58	23	PT			
	G31	Jun 17 →	65	26	TL	48	19	TL	F35	F14	R0
6	E63	Jan 04 → Jul 10	60	24	PT	58	23	PT			
6 Cabriolet	E64	Apr 04 → Jul 10	60	24	PT	58	23	PT			
	F12	Mrz 11 → Jun 18	65	26	SL	43	17	SL			
6 Coupe	F13	Okt 11 →	65	26	SL	43	17	SL			
6 Gran Coupe	F06	Mai 12 →	65	26	SL	43	17	SL			
6 Gran Turismo	G32	Okt 17 →	65	26	TL	45	18	TL			
7	F01, F02, F03, F04	Nov 08 → Dez 15	65	26	STSL	45	18	STSL			
	G11, G12	Jul 15 →	65	26	TL	48	19	TL			
8 Cabriolet	G14, F91	Nov 18 →	65	26	TL	40	16	TL			
8 Coupe	G15, F92	Jul 18 →	65	26	TL	40	16	TL			
8 Grand Coupe	G16, F93	Jul 19 →	65	26	TL	40	16	TL			
i3		Aug 13 →	76	30	SL	53	21	SL	C30	C12	RD
i8	I12	Mrz 18 → Jun 20	76	30	SL	60	24	SL			
X1	E84	Nov 09 → Jun 15	60	24	PT	48	19	PT	F30	F12	R1
	F48	Okt 15 →	65	26	ST	40	16	ST	C30	C12	RB
X2	F39	Mrz 18 →	60	24	TLB	50	20	TLB	F35	F14	R0
X3	E83	Mrz 04 → Aug 10	56	22	B1	50	20	B1	C35	C14	RE
	F25	Okt 10 → Aug 17	65	26	SL	50	20	SL	F35	F14	R3
	G01	Nov 17 →	65	26	TLC	50	20	TLC	F30	F12	R0
X4	F26	Jun 14 → Mrz 18	65	26	SL	50	20	SL	C30	C12	RB
	G02, F98	Jul 14 →	65	26	TLC	50	20	TLC			
X5	E53	Mai 00 → Okt 06	60	24	B1	53	21	B1	43	17	B1
	E70	Feb 07 → Mrz 12	60	24	SL	50	20	SL	F38	F15	R0
		Apr 12 → Jun 13	60	24	TL	50	20	TL	F38	F15	R0
	F15	Nov 13 → Jul 18	60	24	B1	50	20	B1	C30	C12	RB
G05, F95	Aug 18 →	65	26	TLA	50	20	TLA	F35	F14	R0	
X6	E71, E72	Mai 08 → Mrz 12	60	24	SL	50	20	SL			
		Apr 12 → Jul 19	60	24	TL	50	20	TL			
	F16	Aug 14 → Jul 19	60	24	B1	50	20	B1			
G06, F96	Aug 19 →	65	26	TL	50	20	TL				
X7	G07	Mrz 19 →	65	26	TL	50	20	TL	F40	F16	R0

A
B
C
D
E
F
G
H
I
J
K
L
M
N
O
P
Q
R
S
T
U
V
W
X
Y
Z

Automarke / car-type марка автомобиля		Baujahr year of manufacture год выпуска	Fahrer / Driver водитель			Beifahrer Passenger пассажир			Heck / Rear заднее стекло C=CLASSIC / F=FLAT		
			cm	inch	Ad	cm	inch	Ad	cm	inch	Ad
... BMW											
Z3	E36	Okt 95 → Sep 02	50	20	B1	50	20	B1			
Z3 Coupe	E36	Sep 97 → Jun 02	50	20	B1	50	20	B1			
Z4 Cabriolet	E85	Feb 03 → Aug 08	53	21	B1	50	20	B1			
	E89	Mai 09 →	53	21	B1	53	21	B1			
Z4 Coupe	E86	Mrz 06 → Jul 07	53	21	B1	50	20	B1			
Z4 Roadster	G29	Nov 18 →	56	22	TL	53	21	TL			
Z8	E52	Jun 00 → Jun 03	53	21	B1	53	21	B1			
BRILLIANCE											
BC3 Coupe		2009 →	50	20	B1	50	20	B1			
BS2 Hatchback		2008 →	53	21	B1	45	18	B1			
BS4 Saloon Station Wagon		2008 →	50	20	B1	50	20	B1			
CADILLAC											
BLS		Feb 08 →	60	24	PT	58	23	PT			
BLS Wagon		Feb 08 →	60	24	PT	58	23	PT	C30	C12	RE
CADILLAC_STS		Mai 05 →	56	22	PT	53	21	PT			
CTS		Sep 02 → Sep 07	56	22	B1	53	21	B1			
		Jan 08 →	56	22	B1	48	19	B1			
CTS Coupe		Jan 08 →	56	22	B1	48	19	B1			
CTS Sport Wagon		Jan 08 →	56	22	B1	48	19	B1			
DEVILLE		Okt 93 → Sep 04	56	22	B1	56	22	B1			
ELDORADO Coupe		Okt 90 → Sep 02	56	22	B1	56	22	B1			
ESCALADE		Okt 98 → Okt 06	56	22	B1	56	22	B1			
		Okt 06 →	56	22	B1	56	22	B1			
ESCALADE - 6.0 HYBRID AWD		Nov 10 → Dez 13	56	22	B1	53	21	B1			
ESCALADE Pick-up		Jan 10 →	56	22	B1	56	22	B1			
SEVILLE		Sep 97 → Sep 04	56	22	B1	56	22	B1			
SRX		Jan 04 → Dez 08	56	22	B1	53	21	B1			
XLR		Mrz 04 → Sep 09	50	20	B1	50	20	B1			
CHEVROLET											
ALERO		Mrz 99 → Sep 04	56	22	B1	43	17	B1			
AVALANCHE		Jan 07 →	56	22	B1	56	22	B1			
AVEO	T250, T255	Apr 08 → Dez 11	56	22	B1	40	16	B1	C35	C14	RD+
	T300	Jun 11 →	65	26	PT	38	15	PT	C25	C10	RA

Spezifikation für Fahrzeuge / Specification for cars • Спецификация автомобилей

Autemarke / car-type марка автомобиля		Baujahr year of manufacture год выпуска	Fahrer / Driver водитель			Beifahrer Passenger пассажир			Heck / Rear заднее стекло C=CLASSIC / F=FLAT		
			cm	inch	Ad	cm	inch	Ad	cm	inch	Ad
BLAZER S10		Jan 94 → Sep 05	53	21	B1	50	20	B1			
C1500 Pick-up		Okt 91 → Sep 96	45	18	B1	45	18	B1			
C2500 Pick-up		Okt 96 →	45	18	B1	45	18	B1			
CAPTIVA	C100, C140	Okt 06 →	60	24	B1	40	16	B1	C30	C12	RD+
CORVETTE	C6	Mrz 06 →	53	21	B1	53	21	B1			
CORVETTE Convertible		Sep 97 → Sep 04	56	22	B1	56	22	B1			
CRUZE	J300	Mai 09 → Dez 10	60	24	B1	45	18	B1	C35	C14	RA
	J305	Jul 11 →	60	24	B1	45	18	B1	C35	C14	RA
CRUZE Station Wagon	J308	Aug 12 →	60	24	B1	45	18	B1	C25	C10	RA
EPICA	KL1	Apr 05 → Dez 11	53	21	B1	50	20	B1			
EVANDA		Mrz 05 → Sep 06	53	21	B1	50	20	B1			
IMPALA		Sep 99 → Aug 05	58	23	B1	58	23	B1			
KALOS		Mrz 05 → Aug 06	56	22	B1	40	16	B1			
KALOS Hatchback		Mrz 05 → Apr 08	56	22	B1	40	16	B1	C35	C14	RD+
LACETTI	J200	Mrz 05 → Apr 13	53	21	B1	48	19	B1	C40	C16	RD+
MALIBU	V300	Jun 12 →	60	24	B1	48	19	B1			
MATIZ	M200, M250	Mrz 05 → Dez 10	56	22	B1	35	14	B1			
NUBIRA		Mrz 05 → Apr 13	56	22	B1	48	19	B1			
NUBIRA Wagon		Mrz 05 → Apr 13	56	22	B1	48	19	B1			
ORLANDO	J309	Jun 11 →	60	24	B1	48	19	B1			
REZZO		Mrz 05 → Mai 09	60	24	B1	48	19	B1	C35	C14	RD+
SILVERADO 1500		Jan 07 →	56	22	B1	56	22	B1			
SPARK		Mai 05 → Dez 10	56	22	B1	35	14	B1			
	M300	Mrz 10 →	56	22	B1	35	14	B1	C30	C12	RA
TACUMA		2000 → 2008	60	24	B1	48	19	B1	C35	C14	RD+
TAHOE		1995 → 1999	45	18	B1	45	18	B1			
	B2W	Dez 99 → Dez 06	58	23	B1	58	23	B1			
TRACKER		1998 → 2004	43	17	B1	43	17	B1	C35	C14	RD+
TRAILBLAZER	KC	Sep 01 → Sep 08	56	22	B1	56	22	B1			
TRANS SPORT		Okt 00 → Sep 05	60	24	B1	60	24	B1			
TRAX		Dez 12 →	65	26	TL	35	14	TL			
VOLT - EV 150		Nov 11 →	65	26	TL	65	26	TL			
ZAFIRA	F75	Apr 01 →	60	24	B1	60	24	B1			

A
B
C
D
E
F
G
H
I
J
K
L
M
N
O
P
Q
R
S
T
U
V
W
X
Y
Z

Automarke / car-type марка автомобиля		Baujahr year of manufacture год выпуска	Fahrer / Driver водитель			Beifahrer Passenger пассажир			Heck / Rear заднее стекло C=CLASSIC / F=FLAT		
			cm	inch	Ad	cm	inch	Ad	cm	inch	Ad
CHRYSLER											
300 C	LX	Sep 04 → Aug 10	56	22	B1	56	22	B1			
		Jul 11 →	56	22	B1	56	22	B1			
300 C Touring	LX	Okt 04 → Aug 10	56	22	B1	56	22	B1	C25	C10	RD+
300 M	LR	Sep 98 → Sep 04	60	24	B1	48	19	B1			
CONCORDE		Okt 92 → Sep 03	60	24	B1	56	22	B1			
CROSSFIRE		Jul 03 → Dez 07	56	22	B1	56	22	B1			
CROSSFIRE Roadster		Sep 04 → Dez 07	56	22	B1	50	20	B1			
GRAND VOYAGER V	RT	Okt 07 →	65	26	B1	50	20	B1			
NEON	PL	Jun 94 → Dez 05	53	21	B1	45	18	B1			
PT CRUISER	PT	Jun 00 → Dez 10	53	21	B1	53	21	B1	C40	C16	RD+
PT CRUISER Cabriolet		Mrz 04 → Mrz 08	53	21	B1	53	21	B1			
SEBRING	JR	Apr 01 → Aug 06	56	22	B1	56	22	B1			
		Sep 06 → Jun 07	60	24	B1	53	21	B1			
	JS	Jul 07 → Dez 10	60	24	B1	53	21	B1			
SEBRING Cabriolet	JR	Apr 01 → Aug 06	56	22	B1	56	22	B1			
	JS	Jul 07 → Dez 10	60	24	B1	53	21	B1			
SEBRING Coupe	FJ	Sep 95 → Aug 00	56	22	B1	56	22	B1			
STRATUS	JA	Dez 95 → Apr 01	56	22	B1	56	22	B1			
STRATUS Cabriolet	JX	Apr 96 → Apr 01	56	22	B1	56	22	B1			
VIPER		Aug 92 → Dez 98	45	18	B1	45	18	B1			
VIPER Convertible		Aug 92 → Dez 98	45	18	B1	45	18	B1			
VOYAGER II	ES	Sep 90 → Sep 95	45	18	B1	45	18	B1			
VOYAGER III	GS	Jan 95 → Dez 00	65	26	B1	65	26	B1			
VOYAGER IV	RG, RS	Feb 00 → Aug 08	65	26	B1	65	26	B1			
VOYAGER V	RT	Jan 08 →	65	26	B1	50	20	B1			
CITROËN											
BERLINGO	MF	Jul 96 → Mrz 10	56	22	B1	53	21	B1	C40	C16	RD+
	B9	Mai 08 →	65	26	TL	40	16	TL	C35	C14	RD
	ER, EC	Jun 18 →	60	24	TL	43	17	TL	C35	C14	RD
BERLINGO BOX	MF	Jul 96 → Mrz 10	56	22	B1	53	21	B1	C35	C14	RD+
C1	PM, PN	Jun 05 → Sep 14	65	26	B1				C30	C12	RD
C1 II	PA, PS	Feb 14 →	65	26	PT				C30	C12	RA
C2	A6	Sep 03 → Dez 09	60	24	B1	45	18	B1	C25	C10	RD
C3 I	FC, FN,	Jan 02 → Sep 09	60	24	B1	45	18	B1	C35	C14	RD

Autemarke / car-type марка автомобиля		Baujahr year of manufacture год выпуска	Fahrer / Driver водитель			Beifahrer Passenger пассажир			Heck / Rear заднее стекло C=CLASSIC/F=FLAT		
			cm	inch	Ad	cm	inch	Ad	cm	inch	Ad
C3 II	SC	Sep 09 →	65	26	BL	40	16	BL	C30	C12	RD
C3 III	SX	Jul 16 →	65	26	TL	40	16	TL			
C3 AIRCROSS	2R, 2C	Jun 17 →	65	26	ST	40	16	ST	C25	C10	RE
C3 Picasso	A58	Feb 09 → Mrz 10	60	24	TL	40	16	TL	C30	C12	RD
		Apr 10 →	60	24	BL	40	16	BL	C30	C12	RE
C3 Pluriel	HB	Mai 03 → Okt 12	53	21	B1	45	18	B1			
C4	B5	Nov 04 → Sep 10	70	28	PT	60	24	PT	C30	C12	RD
	B71	Sep 10 →	76	30	TL	60	24	TL			
C4 AIRCROSS		Apr 12 →	60	24	B1	53	21	B1	C25	C10	RB
C4 Cactus		Sep 18 →	60	24	BL	43	17	BL	C25	C10	RD
C4 Coupe	B5	Nov 04 → Jul 10	70	28	PT	60	24	PT			
C4 Grand Picasso I	B58	Jun 06 → Mrz 08	81	32	SL	76	30	SL	C35	C14	RD
		Apr 08 → Dez 13	81	32	BL	76	30	BL	C35	C14	RD
C4 Grand Picasso II	B78	Sep 13 →	81	32	TL ^{BF}	76	30	TL ^{BF}			
C4 Picasso I	LC	Feb 07 → Mrz 08	81	32	SL	76	30	SL	C35	C14	RD
		Apr 08 → Jan 13	81	32	BL	76	30	BL	C35	C14	RD
C4 Picasso II	B78	Feb 13 →	81	32	TL ^{BF}	76	30	TL ^{BF}			
C4 Sedan	B5	Jul 06 → Dez 10	70	28	PT	60	24	PT			
C4 SPACETOURER	3D	Apr 18 →	81	32	TL ^{BF}	76	30	TL ^{BF}	C25	C10	RD
C5 I	DC	Mrz 01 → Nov 03	65	26	B1	45	18	B1			
		Dez 03 → Sep 04	65	26	SL	45	18	SL			
C5 I Break	DE	Jun 01 → Nov 03	65	26	B1	45	18	B1			
		Dez 03 → Aug 04	65	26	SL	45	18	SL			
C5 II	RC	Okt 04 → Mrz 08	65	26	SL	45	18	SL	F40	F16	R0
C5 II Break	RE	Okt 04 → Mrz 08	65	26	SL	45	18	SL	C30	C12	RD
C5 III	RD	Apr 08 →	70	28	PT	56	22	PT			
C5 III Break	RW	Feb 08 →	70	28	PT	56	22	PT	F25	F10	R4
C5 AIRCROSS		Nov 18 →	65	26	ST	40	16	ST	C25	C10	RE
C6	X6	Nov 05 → Feb 09	70	28	SL	70	28	SL			
C8	EA, EB	Jul 02 →	65	26	B1	65	26	B1	C35	C14	RD
C-CROSSER	EP	Sep 07 → Jan 13	60	24	B1	53	21	B1	C30	C12	RB
C-CROSSER ENTERPRISE		Jan 09 → Jan 13	60	24	B1	53	21	B1	C30	C12	RB
C-ELYSEE		Nov 12 →	60	24	BL	40	16	BL			
C-ZERO		Okt 10 →	70	28	B1						
DS3		Jan 10 →	60	24	BL	40	16	BL	C30	C12	RD
DS3 Cabriolet		Jan 13 →	60	24	BL	40	16	BL			

A
B
C
D
E
F
G
H
I
J
K
L
M
N
O
P
Q
R
S
T
U
V
W
X
Y
Z

Autemarke / car-type марка автомобиля	Baujahr year of manufacture год выпуска	Fahrer / Driver водитель			Beifahrer Passenger пассажир			Heck / Rear заднее стекло C=CLASSIC / F=FLAT			
		cm	inch	Ad	cm	inch	Ad	cm	inch	Ad	
... CITROËN											
DS4		Apr 11 →	76	30	TL ^{BF}	65	26	TL ^{BF}			
DS5		Nov 11 →	70	28	TL	60	24	TL			
EVASION	22, U6	Jun 94 → Jul 02	65	26	B1	50	20	B1	C40	C16	RD
GRAND C4 SPACETOURER	3A, 3E	Apr 18 →	81	32	TL ^{BF}	76	30	TL ^{BF}			
JUMPER Bus	230P	Feb 94 → Feb 02	56	22	B1	53	21	B1			
	244, Z	Apr 02 → Mai 06	56	22	B1	53	21	B1			
		Jun 06 →	65	26	TL	53	21	TL			
JUMPER Kasten	230L	März 94 → Feb 02	56	22	B1	53	21	B1			
	244	Apr 02 → Mai 06	56	22	B1	53	21	B1			
		Jun 06 →	65	26	TL	53	21	TL			
JUMPY	U6U	Okt 95 → Jan 07	65	26	B1	50	20	B1	C40	C16	RD+
	VF7	Feb 07 →	65	26	B1	50	20	B1	C40	C16	RD
	V	Apr 16 →	65	26	BL	48	19	BL	C35	C14	RD
JUMPY Kasten	BS, BT, BY, BZ	Okt 95 → Jan 07	65	26	B1	50	20	B1	C40	C16	RD
NEMO Kasten	AA	Feb 08 →	65	26	BL	48	19	BL			
NEMO Kombi		Apr 09 →	65	26	BL	48	19	BL			
SAXO	S0, S1	Mai 96 → Sep 99	50	20	B1	45	18	B1	C40	C16	RD+
		Okt 99 → Jun 03	50	20	B1	45	18	B1	C35	C14	RD
SPACETOURER	V	Apr 16 →	65	26	BL	50	20	BL	C35	C14	RD
XANTIA	X1	März 93 → Jan 98	60	24	B1	50	20	B1	45	18	B1
	X2	Jan 98 → Apr 03	60	24	B1	50	20	B1	45	18	B1
XANTIA Break	X1	Sep 95 → Jan 98	60	24	B1	50	20	B1	45	18	B1
	X2	Jan 98 → Apr 03	60	24	B1	50	20	B1	C35	C14	RD+
XM	Y4	Mai 94 → Okt 00	56	22	B1	56	22	B1	45	18	B1
XM Break	Y4	Mai 94 → Okt 00	56	22	B1	56	22	B1	C40	C16	RD+
XSARA	N1	Apr 97 → Mrz 05	56	22	B1	56	22	B1	45	18	B1
XSARA Break	N2	Okt 97 → Aug 05	56	22	B1	56	22	B1	C40	C16	RD+
XSARA Coupe	N0	Feb 98 → Mrz 05	56	22	B1	56	22	B1	45	18	B1
XSARA PICASSO	N68	Jan 00 → Sep 05	65	26	B1	65	26	B1	C40	C16	RD+
		Apr 05 → Apr 10	65	26	SL	65	26	SL	C40	C16	RD
ZX	N2	März 91 → Okt 97	56	22	B1				C40	C16	RD+
ZX Break	N2	Okt 93 → Okt 97	56	22	B1				C40	C16	RD+
DACIA											
DOKKER		Nov 12 →	56	22	B1	40	16	B1	C25	C10	RD

Autemarke / car-type марка автомобиля		Baujahr year of manufacture год выпуска	Fahrer / Driver водитель			Beifahrer Passenger пассажир			Heck / Rear заднее стекло C=CLASSIC/F=FLAT		
			cm	inch	Ad	cm	inch	Ad	cm	inch	Ad
DOKKER	FE/KE	Mai 15 →	56	22	TLB	40	16	TLB			
DOKKER Express		Dez 12 →	56	22	B1	40	16	B1	C25	C10	RD
DUSTER	HS	Jun 10 → Mai 18	50	20	B1	50	20	B1	C35	C14	RD
	HM	Jan 18 →	60	24	TLB	45	18	TLB	C35	C14	RD
LODGY	JS	Mrz 12 →	56	22	B1	40	16	B1	C30	C12	RD
		Dez 15 →	56	22	TLB	40	16	TLB			
LOGAN	LS	Sep 04 →	50	20	B1	50	20	B1			
LOGAN II		Okt 12 → Feb 15	56	22	B1	50	20	B1			
	KS	Mrz 15 →	56	22	BL	48	19	BL			
LOGAN EXPRESS	FS	Mrz 09 →	50	20	B1	50	20	B1	C35	C14	RD
LOGAN MCV		Feb 07 →	50	20	B1	50	20	B1	C35	C14	RD
LOGAN MCV II	K8	Mrz 13 → Feb 15	56	22	B1	50	20	B1	C30	C12	RD
		Mrz 15 →	56	22	BL	48	19	BL	C30	C12	RD
LOGAN Pick-up	US	Nov 10 →	50	20	B1	50	20	B1			
NOVA		Jan 96 → Dez 00	48	19	B1	48	19	B1			
SANDERO		Jun 08 →	50	20	B1	50	20	B1	C40	C16	RD
SANDERO II	B8	Okt 12 → Feb 15	56	22	B1	50	20	B1	C30	C12	RE
		Mrz 15 →	56	22	BL	48	19	BL	C30	C12	RE
SOLENZA		Feb 03 → Apr 05	48	19	B1	48	19	B1			
SUPERNOVA		Jan 95 → Dez 97	48	19	B1	48	19	B1			
DAEWOO											
ARANOS		Feb 00 → Jan 04	45	18	B1	45	18	B1			
ESPERO	KLEJ	Okt 91 → Jun 99	48	19	B1	48	19	B1			
EVANDA	KLAL	Aug 02 →	56	22	B1	50	20	B1			
KALOS	KLAS	Apr 03 → Jan 05	56	22	B1	40	16	B1	C35	C14	RD+
KALOS Stufenheck	KLAS	Nov 02 → Dez 04	56	22	B1	40	16	B1	C35	C14	RD+
KORANDO	KJ	Jan 99 → Dez 00	45	18	B1	40	16	B1			
KORANDO Cabrio	KJ	Feb 99 → Dez 00	45	18	B1	40	16	B1			
LACETTI	J200	Mrz 05 →	53	21	B1	48	19	B1	45	18	B1
LANOS	KLAT	Mai 97 →	48	19	B1	48	19	B1	48	19	B1
LANOS Stufenheck	KLAT	Mai 97 →	48	19	B1	48	19	B1			
LEGANZA		Jun 97 → Dez 02	56	22	B1	48	19	B1			
LUBLIN II		Jan 97 →	53	21	B1	53	21	B1			
MATIZ	KLYA	Sep 98 →	53	21	B1	40	16	B1			
MUSSO	FJ	Jan 99 → Dez 00	50	20	B1	45	18	B1	C35	C14	RD
NEXIA	KLETN	Feb 95 → Aug 97	45	18	B1	45	18	B1	45	18	B1
NEXIA Stufenheck	KLETN	Feb 95 → Aug 97	45	18	B1	45	18	B1			

A
B
C
D
E
F
G
H
I
J
K
L
M
N
O
P
Q
R
S
T
U
V
W
X
Y
Z

Automarke / car-type марка автомобиля	Baujahr year of manufacture год выпуска	Fahrer / Driver водитель			Beifahrer Passenger пассажир			Heck / Rear заднее стекло C=CLASSIC / F=FLAT			
		cm	inch	Ad	cm	inch	Ad	cm	inch	Ad	
... DAEWOO											
NUBIRA	KLAJ	Sep 97 → Sep 99	50	20	B1	50	20	B1			
NUBIRA Stufenheck	KLAJ	Sep 97 → Sep 99	50	20	B1	50	20	B1			
		Okt 99 → Jun 03	56	22	B1	48	19	B1			
	KLAN	Jul 03 → Jan 05	56	22	B1	48	19	B1			
NUBIRA Wagon	KLAJ	Sep 97 → Sep 99	50	20	B1	50	20	B1	38	15	B1
		Okt 99 → Jun 03	56	22	B1	48	19	B1	38	15	B1
REZZO	KLAU	Sep 00 →	60	24	B1	48	19	B1	38	15	B1
TACUMA	KLAU	Jan 00 →	60	24	B1	48	19	B1			
TICO	KLY3	Feb 95 → Dez 00	45	18	B1	40	16	B1	C35	C14	RD+
DAIHATSU											
APPLAUSE II	A101	Jul 97 → Mai 00	45	18	B1	45	18	B1			
BOON		Apr 04 → Feb 10	50	20	B1	40	16	B1	C35	C14	RD+
CHARADE	L2	Mrz 03 →	53	21	B1	28	11	B1	C30	C12	RD
		Mai 11 →	60	24	B1	35	14	B1	C30	C12	RE
CHARADE IV	G200, G202	Jan 93 → Sep 00	48	19	B1	45	18	B1			
COPEN		Sep 03 →	45	18	B1	40	16	B1			
CUORE III	L201	Okt 90 → Feb 93	45	18	B1	45	18	B1			
CUORE IV	L501	Jan 95 → Nov 96	45	18	B1	40	16	B1			
CUORE V	L5	Nov 96 → Okt 98	45	18	B1	40	16	B1			
CUORE VI	L7	Okt 98 → Mai 03	45	18	B1	40	16	B1			
CUORE VII	L251	Mai 03 → Dez 07	53	21	B1	28	11	B1	C30	C12	RD
CUORE VIII		Apr 07 → Dez 07	53	21	B1	28	11	B1	C30	C12	RD
DOMINO		1992 → 1994	45	18	B1	40	16	B1			
EXTOL Bus	S22, S23	Jul 00 →	48	19	B1	40	16	B1			
GRAN MOVE	G3	Okt 96 → Jul 02	50	20	B1	45	18	B1	38	15	B1
HUJET	S85	Dez 92 →	40	16	B1	38	15	B1	33	13	B1
MATERIA	M4	Okt 06 →	50	20	B1	48	19	B1	C30	C12	RA
MOVE	L6, L9	Jan 97 → Sep 02	48	19	B1	43	17	B1	C35	C14	RD+
SIRION	M1	Apr 98 → Jul 04	48	19	B1	45	18	B1			
	M3	Jan 05 →	50	20	B1	40	16	B1	C35	C14	RD+
SPORTRAK	F300	Jun 06 →	40	16	B1	40	16	B1			
TERIOS	J1	Okt 00 → Okt 05	50	20	B1	35	14	B1	C25	C10	RD+
	J2	Jan 06 →	53	21	B1	45	18	B1	C30	C12	RD
TREVIS		Aug 06 →	50	20	B1	40	16	B1			
YRV	M2	Feb 01 → Jul 05	53	21	B1	35	14	B1	C30	C12	RD+

SPZIFIKATION FÜR FAHRZEUGE / Specification for cars • Спецификация автомобилей

Autemarke / car-type марка автомобиля	Baujahr year of manufacture год выпуска	Fahrer / Driver водитель			Beifahrer Passenger пассажир			Heck / Rear заднее стекло C=CLASSIC/F=FLAT			
		cm	inch	Ad	cm	inch	Ad	cm	inch	Ad	
DODGE											
AVENGER		Jun 07 →	60	24	B1	53	21	B1			
CALIBER		Jun 06 →	60	24	B1	43	17	B1	C25	C10	RD+
CARAVAN	NS	Jan 95 → Mrz 01	65	26	B1	65	26	B1	45	18	B1
	RS	Sep 00 → Aug 07	65	26	B1	65	26	B1	C40	C16	RD+
		Jan 08 → Aug 10	65	26	B1	50	20	B1	C40	C16	RD+
CHALLENGER Coupe		Sep 08 →	56	22	B1	56	22	B1			
CHARGER		Sep 11 →	60	24	B1	53	21	B1			
DART		Apr 12 →	65	26	B1	45	18	B1			
DURANGO		Jan 11 →	56	22	B1	50	20	B1			
JOURNEY		Jun 08 →	60	24	B1	43	17	B1	C30	C12	RD+
NEON		Jun 94 → Aug 99	53	21	B1	45	18	B1			
NEON II		Aug 99 →	53	21	B1	48	19	B1			
NITRO		Sep 06 → Aug 11	48	19	B1	48	19	B1			
RAM 1500 Pick-up	D1, DC, DH, DM, DR	Jun 01 → Sep 08	56	22	B1	56	22	B1			
Ram 2500 Pick-up	D1, DC, DH, DM, DR	Jun 01 → Dez 09	60	24	B1	60	24	B1			
		Jan 02 → Dez 09	56	22	B1	56	22	B1			
STRATUS		Dez 95 → Apr 01	56	22	B1	56	22	B1			
VIPER Cabriolet SRT-10		Sep 02 →	40	16	B1	40	16	B1			
VIPER Coupe SRT-10		Jan 03 →	40	16	B1	40	16	B1			
FERRARI											
348 tb/GTB		Feb 90 → Apr 94	50	20	B1	50	20	B1			
360 - 3.6 Challenge / Stradale	F131	Mai 01 → Mrz 05	60	24	B1	53	21	B1			
360 Spider - 3.6	F131	Feb 00 → Mrz 05	60	24	B1	53	21	B1			
458 - 4.5		Sep 13 →	70	28	B1	50	20	B1			
458 Spider - 4.5		Sep 11 →	70	28	B1	50	20	B1			
599 GTB/GTO - 6.0 GTB		Jun 06 →	65	26	B1	45	18	B1			
612 SCAGLIETTI - 5.7		Apr 04 → Jun 11	70	28	B1	50	20	B1			
CALIFORNIA		Jul 08 →	70	28	B1	50	20	B1			



Autemarke / car-type марка автомобиля		Baujahr year of manufacture год выпуска	Fahrer / Driver водитель			Beifahrer Passenger пассажир			Heck / Rear заднее стекло C=CLASSIC / F=FLAT		
			cm	inch	Ad	cm	inch	Ad	cm	inch	Ad
... FERRARI											
F12 BERLINETTA - 6.3		Okt 12 →	70	28	B1	50	20	B1			
F355 GTS - 3.5 Spider		Jul 94 → Dez 00	53	21	B1	50	20	B1			
FF - 6.3		Jun 11 →	70	28	B1	43	17	B1			
MARANELLO		Sep 96 →	45	18	B1	45	18	B1			
FIAT											
124 Spider	348	Mrz 16 →	45	18	B1	48	19	B1			
500		Okt 07 →	60	24	TL	35	14	TL	C30	C12	RD
500 C		Sep 09 →	60	24	TL	35	14	TL			
500 L		Sep 12 →	65	26	TL	38	15	TL	C30	C12	RD
500 X		Nov 14 →	65	26	TL	35	14	TL	C30	C12	RD
BARCETTA	183	Apr 95 → Feb 05	48	19	B1	48	19	B1			
BRAVA	182	Okt 95 → Sep 01	58	23	B1	48	19	B1			
BRAVO I	182	Okt 95 → Sep 01	58	23	B1	48	19	B1			
BRAVO II	198	Okt 07 →	60	24	TL	45	18	TL	28	11	B1
CINQUECENTO	170	Jul 91 → Jul 99	48	19	B1	48	19	B1			
COUPE	FA/175	Feb 94 → Aug 00	53	21	B1	48	19	B1	50	20	B1
CROMA	194	Jun 05 → Dez 10	60	24	SL	43	17	SL			
DOBLO	119	Okt 01 → Dez 10	56	22	B1	45	18	B1			
		Feb 10 →	60	24	TL	40	16	TL	F38	F15	R1
DOBLO Cargo	223	Mrz 01 → Dez 10	56	22	B1	45	18	B1			
DUCATO	230	Mrz 94 → Apr 02	56	22	B1	53	21	B1			
	244	Apr 02 → Aug 06	56	22	B1	53	21	B1			
	250	Jul 06 →	65	26	TL	53	21	TL			
FIORINO	225	Dez 07 →	65	26	BL	48	19	BL			
FREMONT	JC	Aug 11 → Dez 15	60	24	B1	48	19	B1	C30	C12	RA
FULLBACK Pick-up	502, 503	Jan 16 →	56	22	B1	45	18	B1			
GRANDE PUNTO	199	Sep 10 → Dez 11	65	26	PT	38	15	PT	C30	C12	RD+
IDEA		Jan 04 → Dez 05	58	23	B1	40	16	B1			
		Apr 08 → Dez 12	58	23	TL	38	15	TL			
LINEA	323	Jun 07 →	65	26	PT	38	15	PT			
MAREA	185	Okt 96 → Mai 02	58	23	B1	48	19	B1			
MAREA Weekend	185	Okt 96 → Mai 02	58	23	B1	48	19	B1			
Marengo		1997 →	58	23	B1	48	19	B1			
MULTIPLA	186	Apr 99 → Dez 05	60	24	B1	56	22	B1			

Spezifikation für Fahrzeuge / Specification for cars • Спецификация автомобилей

Automarke / car-type марка автомобиля		Baujahr year of manufacture год выпуска	Fahrer / Driver водитель			Beifahrer Passenger пассажир			Heck / Rear заднее стекло C=CLASSIC / F=FLAT		
			cm	inch	Ad	cm	inch	Ad	cm	inch	Ad
MULTIPLA	186	Jan 06 →	60	24	PT	56	22	PT			
PALIO	178BX	Jan 01 → Aug 02	58	23	B1	45	18	B1			
PALIO Weekend	178DX	Sep 97 → Mrz 04	58	23	B1	45	18	B1			
PANDA	169	Okt 03 → Dez 12	58	23	B1	40	16	B1			
	312, 319	Feb 12 →	60	24	TL	38	15	TL	C30	C12	RD
PANDA Van	169	Sep 04 → Dez 12	58	23	B1	40	16	B1			
PUNTO	176	Sep 93 → Aug 99	58	23	B1	40	16	B1			
	188	Sep 99 → Dez 10	53	21	B1	45	18	B1			
	199	Mrz 12 →	65	26	PT	38	15	PT	C30	C12	RD+
PUNTO Cabriolet	176C	Apr 94 → Aug 99	58	23	B1	40	16	B1			
PUNTO EVO	199	Okt 09 → Dez 11	65	26	PT	38	15	PT	C30	C12	RD+
PUNTO Van	176L	Apr 96 → Aug 99	58	23	B1	40	16	B1			
	188AX	Feb 00 → Okt 09	53	21	B1	45	18	B1			
QUBO		Feb 08 →	65	26	BL	48	19	BL	C35	C14	RA
SCUDO	220L	Feb 96 → Dez 06	65	26	B1	50	20	B1			
	270	Jan 07 →	70	28	B1	50	20	B1			
SCUDO Combinato	220P	Feb 96 → Dez 06	65	26	B1	50	20	B1			
SEDICI		Jun 06 →	65	26	B1	35	14	B1	C25	C10	RB
SEICENTO	187	Jan 98 → Jan 10	48	19	B1	48	19	B1			
SIENA		1996 →	58	23	B1	45	18	B1			
STILO	192	Okt 01 → Jun 05	53	21	B1	48	19	B1			
		Jul 05 → Nov 06	56	22	PT	48	19	PT			
STILO Multi Wagon	192	Jan 03 → Jun 05	53	21	B1	48	19	B1			
		Jul 05 → Dez 07	56	22	PT	48	19	PT			
STRADA Pick-up	178E	Jun 99 → Jun 05	58	23	B1	45	18	B1			
TEMPRA	159	Mrz 92 → Aug 96	50	20	B1	50	20	B1			
TEMPRA S.W.	159	Jan 91 → Aug 96	50	20	B1	50	20	B1			
TIPO	356	Nov 15 →	65	26	TL	40	16	TL			
TIPO Hatchback	356	Mai 16 →	65	26	TL	40	16	TL			
ULYSSE	220	Sep 94 → Sep 02	65	26	B1	50	20	B1			
FORD											
B-MAX		Okt 12 →	70	28	PT	65	26	PT	C30	C12	RD
C-MAX	DM2	Mrz 07 → Jul 10	65	26	SL	48	19	SL	C30	C12	RD+
C-MAX II	DXA	Apr 15 →	70	28	PT	65	26	PT	C30	C12	RD
COUGAR	EC	Aug 98 → Dez 00	56	22	B1	50	20	B1	56	22	B1
COURIER Kasten	F3L, F5L	Sep 91 → Feb 96	48	19	B1	48	19	B1			
	J5, J3	Feb 96 → Dez 02	48	19	B1	48	19	B1			

A
B
C
D
E
F
G
H
I
J
K
L
M
N
O
P
Q
R
S
T
U
V
W
X
Y
Z

Automarke / car-type марка автомобиля		Baujahr year of manufacture год выпуска	Fahrer / Driver водитель			Beifahrer Passenger пассажир			Heck / Rear заднее стекло C=CLASSIC / F=FLAT		
			cm	inch	Ad	cm	inch	Ad	cm	inch	Ad
... FORD											
ECOSPORT		Okt 13 → Okt 17	53	21	B1	40	16	B1	C25	C10	RD+
		Okt 13 → Sep 16	53	21	TLC	40	16	TLC	C25	C10	RD+
		Okt 16 → Okt 17	53	21	ST	40	16	ST	C25	C10	RD+
		Jan 18 →	56	22	TL	40	16	TL	F25	F10	R0
EDGE Vignale		Jan 15 →	70	28	PT	70	28	PT	F38	F15	R0
ESCORT '91 Express	AVL	Aug 90 → Dez 94	50	20	B1	50	20	B1			
ESCORT '95 Express	AVL	Jan 95 → Sep 01	50	20	B1	50	20	B1			
ESCORT CLASSIC	ÄAL, ABL	Okt 98 → Jul 00	50	20	B1	50	20	B1			
ESCORT CLASSIC Turnier	ANL	Feb 99 → Jul 00	50	20	B1	50	20	B1			
ESCORT V	GAL	Aug 90 → Dez 94	50	20	B1	50	20	B1			
ESCORT VI	GAL	Jan 95 → Feb 99	50	20	B1	50	20	B1			
FIESTA Van		Okt 03 → Sep 08	56	22	B1	40	16	B1	C25	C10	RD+
		Jan 09 → Nov 12	65	26	TL	38	15	TL			
FIESTA IV	JA	Okt 95 → Jan 02	48	19	B1	48	19	B1			
FIESTA V	JH	Nov 01 → Jun 08	56	22	B1	40	16	B1	C25	C10	RD+
FIESTA VI		Jul 08 →	65	26	TL	38	15	TL	C30	C12	RE
FIESTA VII		Mai 17 →	70	28	TL	35	14	TL	F25	F10	R0
FOCUS	DAW, DBW	Okt 98 → Nov 04	56	22	B1	48	19	B1	C35	C14	RD+
FOCUS C-MAX		Okt 03 → Mrz 07	65	26	SL	48	19	SL	C25	C10	RD+
FOCUS II	DA	Nov 04 → Dez 11	65	26	SL	40	16	SL	C25	C10	RD+
FOCUS II Cabriolet		Okt 06 → Jul 10	65	26	SL	40	16	SL			
FOCUS II Kombi	DA	Nov 04 → Dez 11	65	26	SL	40	16	SL	C25	C10	RD+
FOCUS II Stufenheck	DA	Apr 05 → Dez 11	65	26	SL	40	16	SL			
FOCUS III		Apr 11 →	70	28	TL ^{BF}	70	28	TL ^{BF}	C30	C12	RE
FOCUS III Stufenheck		Apr 11 →	70	28	TL ^{BF}	70	28	TL ^{BF}			
FOCUS III Turnier		Mai 11 →	70	28	TL ^{BF}	70	28	TL ^{BF}	C30	C12	RE
FOCUS IV	HN	Jan 18 →	65	26	TL	50	20	TL	F25	F10	R0
FOCUS IV Stufenheck	HM	Nov 18 →	65	26	TL	50	20	TL			
FOCUS IV Turnier	HP	Sep 18 →	65	26	TL	50	20	TL	F25	F10	R0

SPZIFIKATION FÜR FAHRZEUGE / Specification for cars • Спецификация автомобилей

Autemarke / car-type марка автомобиля		Baujahr year of manufacture год выпуска	Fahrer / Driver водитель			Beifahrer Passenger пассажир			Heck / Rear заднее стекло C=CLASSIC/F=FLAT		
			cm	inch	Ad	cm	inch	Ad	cm	inch	Ad
FOCUS Kombi	DNW	Feb 99 → Nov 04	56	22	B1	48	19	B1	C35	C14	RD+
FOCUS Stufenheck	DFW	Feb 99 → Nov 04	56	22	B1	48	19	B1			
FUSION	JU	Okt 02 → Jun 12	56	22	B1	40	16	B1	C25	C10	RD+
GALAXY	WGR	Mrz 95 → Apr 01	70	28	TR	65	26	TR	C40	C16	RD+
		Apr 01 → Mai 06	70	28	SL	70	28	SL	C40	C16	RD+
	WA6	Mai 06 →	76	30	TL ^{BF}	65	26	TL ^{BF}			
	CK	Jan 15 →	76	30	PT	76	30	PT	F35	F14	R0
KA	RB	Sep 96 → Nov 08	48	19	B1	43	17	B1	C40	C16	RD+
	RU8	Okt 08 → Okt 10	60	24	B1	35	14	B1	C30	C12	RD
		Nov 10 →	60	24	TL	35	14	TL	C30	C12	RD
KA +		Jul 16 →	56	22	TL	40	16	TL	F25	F10	R0
KUGA I		Mrz 08 → Nov 12	60	24	TL	43	17	TL	C25	C10	RD+
KUGA II		Mrz 13 →	70	28	PT	70	28	PT	F25	F10	R0
MAVERICK	UDS, UNS	Feb 93 → Apr 98	53	21	B1	50	20	B1	33	13	B1
		Feb 01 → Jan 07	48	19	B1	48	19	B1			
MONDEO I	GBP	Feb 93 → Jul 96	53	21	B1	50	20	B1	33	13	B1
MONDEO I Kombi	BNP	Apr 93 → Jul 96	53	21	B1	50	20	B1	C30	C12	RD+
MONDEO I Stufenheck	GBP	Feb 93 → Jul 96	53	21	B1	50	20	B1			
MONDEO II	BAP	Sep 96 → Sep 00	53	21	B1	50	20	B1			
MONDEO II Kombi	BNP	Sep 96 → Sep 00	53	21	B1	50	20	B1	48	19	B1
MONDEO II Stufenheck	BFP	Sep 96 → Sep 00	53	21	B1	50	20	B1			
MONDEO III	B5Y	Nov 00 → Mrz 07	56	22	B1	48	19	B1	48	19	B1
MONDEO III Kombi	BWY	Nov 00 → Mrz 07	56	22	B1	48	19	B1	C30	C12	RD+
MONDEO III Stufenheck	B4Y	Nov 00 → Mrz 07	56	22	B1	48	19	B1			
MONDEO IV	BA7	Mrz 07 → Dez 14	65	26	TL	48	19	TL			
MONDEO IV Stufenheck	BA7	Mrz 07 → Dez 14	65	26	TL	48	19	TL			
MONDEO IV Turnier	BA7	Mrz 07 → Dez 14	65	26	TL	48	19	TL	C30	C12	RE
MONDEO V Schrägheck		Sep 14 →	70	28	PT	70	28	PT			
MONDEO V Stufenheck		Sep 14 →	70	28	PT	70	28	PT			

A
B
C
D
E
F
G
H
I
J
K
L
M
N
O
P
Q
R
S
T
U
V
W
X
Y
Z

Automarke / car-type марка автомобиля		Baujahr year of manufacture год выпуска	Fahrer / Driver водитель			Beifahrer Passenger пассажир			Heck / Rear заднее стекло C=CLASSIC / F=FLAT		
			cm	inch	Ad	cm	inch	Ad	cm	inch	Ad
... FORD											
MONDEO V Turnier		Sep 14 →	70	28	PT	70	28	PT	F30	F12	R4
ORION III	GAL	Jul 90 → Dez 93	50	20	B1	50	20	B1			
PROBE II	ECP	Okt 93 → Aug 97	50	20	B1	50	20	B1	50	20	B1
PUMA	EC	Jan 98 → Dez 01	48	19	B1	48	19	B1			
		Sep 19 →	70	28	TL	35	14	TL	F30	F12	R0
RANGER Pick-up	ER, EQ	Okt 99 → Jun 06	45	18	B1	45	18	B1			
	ES, ET	Mai 06 → Dez 11	45	18	B1	45	18	B1			
	TKE	Sep 11 → Aug 15	60	24	B1	40	16	B1			
		Sep 15 →	60	24	TL	40	16	TL			
SCORPIO I Kombi	GGE	Feb 92 → Sep 94	50	20	B1	50	20	B1			
SCORPIO II	GFR, GGR	Jan 95 → Aug 98	50	20	B1	50	20	B1			
SCORPIO II Kombi	GNR, GGR	Jan 95 → Aug 98	50	20	B1	50	20	B1			
S-MAX	WA6	Mai 06 → Jan 09	76	30	TL ^{BF}	65	26	TL ^{BF}			
		Feb 09 → Dez 14	76	30	TL ^{BF}	65	26	TL ^{BF}	C35	C14	RA
		Mai 15 →	76	30	PT	76	30	PT	F30	F12	R0
STREET KA Cabriolet	RL2	Mai 03 → Jul 05	48	19	B1	48	19	B1			
TOURNEO CONNECT		Jun 02 →	56	22	B1	48	19	B1			
TOURNEO CONNECT Kombi		Sep 13 →	76	30	PT	70	28	PT			
TOURNEO CONNECT Heckklappe		Sep 13 →	76	30	PT	70	28	PT	C35	C14	RD
TOURNEO COURIER	B460	Feb 14 →	70	28	PT	38	15	PT			
TOURNEO CUSTOM Bus		Dez 12 →	76	30	TL ^{BF}	70	28	TL ^{BF}			
		Dez 15 →	76	30	PT	70	28	PT			
TRANSIT	E	Aug 91 → Jun 00	56	22	B1	56	22	B1			
	F	Aug 00 → Mai 06	65	26	B1	56	22	B1			
		Apr 06 → Dez 13	65	26	B1	56	22	B1			
		Mai 14 →	76	30	TL	65	26	TL			

Spezifikation für Fahrzeuge / Specification for cars • Спецификация автомобилей

Autemarke / car-type марка автомобиля		Baujahr year of manufacture год выпуска	Fahrer / Driver водитель			Beifahrer Passenger пассажир			Heck / Rear заднее стекло C=CLASSIC / F=FLAT		
			cm	inch	Ad	cm	inch	Ad	cm	inch	Ad
TRANSIT Bus / Kasten / Pritsche	V363	Mai 13 →	76	30	TL ^{BF}	70	28	TL ^{BF}			
TRANSIT CONNECT	P65, P70, P80	Jun 02 →	56	22	B1	48	19	B1			
TRANSIT CONNECT Kasten		Nov 13 →	76	30	PT	70	28	PT			
TRANSIT CONNECT Kombi		Sep 13 →	76	30	PT	70	28	PT			
		Sep 13 →	76	30	TL ^{BF}	70	28	TL ^{BF}			
TRANSIT CUSTOM BUS	V362	Dez 12 →	76	30	TL ^{BF}	70	28	TL ^{BF}			
TRANSIT CUSTOM Kasten		Dez 12 →	76	30	PT	70	28	PT			
TRANSIT TOURNEO		Nov 94 → Dez 00	56	22	B1	56	22	B1			
		Jul 06 → Sep 11	65	26	B1	56	22	B1			
FORD (USA)											
EXPEDITION		Aug 96 → Sep 02	53	21	B1	53	21	B1			
EXPLORER	U2	Mrz 95 → Aug 01	45	18	B1	45	18	B1			
		Jan 01 →	56	22	B1	53	21	B1			
F 150		1997 →	50	20	B1	50	20	B1			
MUSTANG		Dez 04 →	56	22	B1	50	20	B1			
MUSTANG Convertible	C	Sep 93 →	50	20	B1	50	20	B1			
		Sep 05 →	56	22	B1	50	20	B1			
MUSTANG Coupe	C	Jan 94 →	50	20	B1	50	20	B1			
PROBE II	ECP	Okt 93 → Aug 97	50	20	B1	50	20	B1	50	20	B1
TAURUS	P5	Sep 95 →	60	24	B1	50	20	B1			
TAURUS Wagon	P5	Sep 96 → Dez 99	60	24	B1	50	20	B1			
WINDSTAR	A3	Jan 95 →	60	24	B1	50	20	B1			
FSO											
POLONEZ III		1992 → 1993	40	16	B1	40	16	B1			
		1993 →	50	20	B1	50	20	B1			
POLONEZ III Saloon		1992 → 1993	40	16	B1	40	16	B1			
		1993 →	50	20	B1	50	20	B1			
GAZ											
VOLGA 3105		1994 → 1997	50	20	B1	50	20	B1			
VOLGA 3110		1997 → 2004	40	16	B1	40	16	B1			
VOLGA 3111		1998 → 2003	50	20	B1	50	20	B1			
VOLGA 31105		2004 → 2010	50	20	B1	50	20	B1			

A
B
C
D
E
F
G
H
I
J
K
L
M
N
O
P
Q
R
S
T
U
V
W
X
Y
Z

Automarke / car-type марка автомобиля	Baujahr year of manufacture год выпуска	Fahrer / Driver водитель			Beifahrer Passenger пассажир			Heck / Rear заднее стекло C=CLASSIC / F=FLAT		
		cm	inch	Ad	cm	inch	Ad	cm	inch	Ad
GAZ										
VOLGA 310221 Universal Estate	1997 →	40	16	B1	40	16	B1			
GAZELLE 3302	1992 →	50	20	B1	50	20	B1			
HONDA										
ACCORD IV	Jan 90 → Mrz 93	56	22	B1	50	20	B1			
ACCORD V	Mrz 93 → Feb 98	56	22	B1	50	20	B1			
ACCORD VI	Okt 98 → Dez 02	56	22	B1	48	19	B1			
ACCORD VII	CL Feb 03 → Jun 08	65	26	B1	40	16	B1			
ACCORD VII Coupe	CG 1998 → 2003	60	24	B1	48	19	B1			
ACCORD VII Tourer	CM Apr 03 → Aug 08	65	26	B1	40	16	B1	C30	C12	RB
ACCORD VIII	CU Jul 08 →	65	26	B1	53	21	B1			
ACCORD VIII TOURER	Jul 08 →	65	26	B1	53	21	B1	C30	C12	RB
CIVIC V Coupe	EJ Okt 91 → Mrz 96	50	20	B1	45	18	B1			
CIVIC V Hatchback	EG Okt 91 → Nov 95	50	20	B1	45	18	B1			
CIVIC V Stufenheck	EG, EH Okt 91 → Nov 95	50	20	B1	45	18	B1			
CIVIC VI Aerodeck	MB, MC Apr 98 → Feb 01	50	20	B1	45	18	B1			
CIVIC VI Coupe	EJ, EM1 Mrz 96 → Mrz 00	50	20	B1	45	18	B1			
CIVIC VI Fastback	MA, MB Sep 94 → Feb 01	50	20	B1	45	18	B1			
CIVIC VI Hatchback	EJ, EK Nov 91 → Feb 01	50	20	B1	45	18	B1			
CIVIC VI Stufenheck	EJ, EK Nov 95 → Feb 01	50	20	B1	45	18	B1			
CIVIC VII Coupe	EM2 Mai 01 → Dez 04	53	21	B1	48	19	B1	C30	C12	RD
CIVIC VII Hatchback	EU, EP, EV Feb 01 → Sep 05	60	24	B1	33	13	B1			
CIVIC VII Stufenheck	ES Feb 01 → Dez 02	53	21	B1	45	18	B1			
CIVIC VIII Hatchback	FN, FK Jan 06 → Dez 11	70	28	B1	58	23	B1			
CIVIC VIII Stufenheck	FD, FA Sep 05 → Feb 12	70	28	B1	58	23	B1			
CIVIC IX	FK Feb 12 →	65	26	B1	45	18	B1	48	19	B1
CIVIC IX Tourer	FK Jan 14 →	65	26	B1	45	18	B1	C30	C12	RB
CIVIC X Schrägheck	FC, FK Sep 16 →	65	26	B1	45	18	B1	C35	C14	RD+
CIVIC X Stufenheck	FC Sep 15 →	65	26	B1	45	18	B1			
CR-V I	RD Sep 96 → Jan 99	50	20	B1	45	18	B1	C25	C10	RD+
CR-V II	RD Feb 05 → Sep 06	53	21	B1	50	20	B1	C25	C10	RD+
CR-V III	RE Jan 07 → Dez 12	65	26	B1	40	16	B1	C35	C14	RB
CR-V IV	RM Okt 12 →	65	26	B1	40	16	B1	C30	C12	RB

SPZIFIKATION FÜR FAHRZEUGE / Specification for cars • Спецификация автомобилей

Autemarke / car-type марка автомобиля		Baujahr year of manufacture год выпуска	Fahrer / Driver водитель			Beifahrer Passenger пассажир			Heck / Rear заднее стекло C=CLASSIC/F=FLAT		
			cm	inch	Ad	cm	inch	Ad	cm	inch	Ad
CR-V V	RW, RT	Dez 16 →	65	26	B1	40	16	B1	C30	C12	RA
CRX III	EH, EG	Mrz 92 → Dez 98	50	20	B1	45	18	B1			
CR-Z	ZF1	Jun 10 →	65	26	B1	50	20	B1			
e	ZC7	Sep 19 →	53	21	B1	45	18	B1			
FCX	BE	Jan 03 →	60	24	B1	53	21	B1			
FR-V		Feb 05 → Jun 09	65	26	B1	45	18	B1			
HR-V	GH	Mrz 99 → Dez 05	50	20	B1	45	18	B1			
INSIGHT		Apr 00 → Dez 06	50	20	B1	45	18	B1			
		Apr 09 → Feb 14	65	26	B1	40	16	B1	C40	C16	RB
INTEGRA Coupe	DC2, DC4	Jan 98 → Okt 01	50	20	B1	45	18	B1			
JAZZ II	GD	Mrz 02 → Jul 08	50	20	B1	38	15	B1	C35	C14	RB
JAZZ III	GE	Okt 08 →	65	26	B1	35	14	B1	C35	C14	RB
JAZZ IV	GK	Apr 11 →	65	26	B1	40	16	B1	C35	C14	RB
LEGEND II	KA7	Jan 91 → Dez 95	53	21	B1	48	19	B1			
LEGEND II Coupe	KA8	Jan 91 → Feb 96	53	21	B1	48	19	B1			
LEGEND III	KA9	Jan 96 → Dez 99	50	20	B1	48	19	B1			
LOGO	GA3	Sep 96 → Jun 01	50	20	B1	45	18	B1			
NSX		Apr 99 →	50	20	B1	50	20	B1			
NSX Cabriolet	NA	Mrz 95 → Sep 05	50	20	B1	50	20	B1			
NSX Coupe	NA	Jun 90 → Sep 05	50	20	B1	50	20	B1			
ODYSSEY		Jan 98 → Okt 03	60	24	B1	53	21	B1			
PRELUDE IV		Feb 92 → Dez 98	53	21	B1	48	19	B1			
PRELUDE V		Jan 99 → Dez 00	53	21	B1	48	19	B1			
S2000	AP	Jun 99 →	50	20	B1	40	16	B1			
SHUTTLE	RA	Jan 98 → Mai 01	56	22	B1	53	21	B1			
STREAM	RN	Mai 01 → Aug 05	60	24	B1	33	13	B1			
HUMMER											
H1		Jan 92 →	43	17	B1	43	17	B1	C30	C12	RD+
H2		Sep 04 →	43	17	B1	43	17	B1	C30	C12	RD+
H3		Apr 05 →	43	17	B1	43	17	B1	C30	C12	RD+
HYUNDAI											
ACCENT I	X-3	Okt 94 → Jul 99	50	20	B1	45	18	B1			
ACCENT II	LC	Jan 00 → Nov 05	50	20	B1	45	18	B1			
ACCENT III	MC	Apr 06 → Nov 10	56	22	B1	40	16	B1			
ATOS	MX	Jul 01 → Mrz 08	50	20	B1	40	16	B1	C35	C14	RD
ATOS PRIME	MX	Sep 99 → Mrz 08	50	20	B1	40	16	B1	C35	C14	RD
CENTENNIAL		1999 → 2003	53	21	B1	53	21	B1			

A
B
C
D
E
F
G
H
I
J
K
L
M
N
O
P
Q
R
S
T
U
V
W
X
Y
Z

Automarke / car-type марка автомобиля		Baujahr year of manufacture год выпуска	Fahrer / Driver водитель			Beifahrer Passenger пассажир			Heck / Rear заднее стекло C=CLASSIC / F=FLAT		
			cm	inch	Ad	cm	inch	Ad	cm	inch	Ad
... HYUNDAI											
COUPE	RD	Dez 96 → Apr 02	53	21	B1	45	18	B1	50	20	B1
	GK	Mrz 02 → Aug 09	53	21	B1	45	18	B1	50	20	B1
CRETA		Jan 16 →	65	26	B1	40	16	B1			
ELANTRA	XD	Jun 00 → Jul 06	50	20	B1	45	18	B1			
	MD, UD	Jun 11 →	65	26	B1	35	14	B1			
EQUUS / CENTENNIAL		Okt 09 →	60	24	PT	48	19	PT			
GALLOPER I		Aug 91 → Aug 98	43	17	B1	43	17	B1			
GALLOPER II		Aug 98 → Dez 99	43	17	B1	43	17	B1	C35	C14	RD+
	JK-01	Jan 00 → Dez 03	45	18	B1	45	18	B1			
GENESIS	BH	Feb 11 →	60	24	PT	48	19	PT			
GENESIS Coupe		Jan 08 →	60	24	PT	48	19	PT			
GETZ	TB	Sep 02 → Jun 09	53	21	B1	35	14	B1	C35	C14	RD+
GRANDEUR	TG	Jul 05 →	60	24	B1	50	20	B1			
H-1 / STAREX		Okt 99 → Dez 07	65	26	B1	50	20	B1	C40	C16	RD+
H-1 Cargo	TO	Mrz 08 →	60	24	B1	50	20	B1			
H-1 Kasten		Mrz 00 → Apr 04	65	26	B1	50	20	B1	C40	C16	RD+
H100 Bus	P	Jul 93 → Mrz 00	50	20	B1	45	18	B1			
H100 Kasten		Jul 93 → Mrz 00	50	20	B1	45	18	B1			
H150 Box / Bus		1993 →	45	18	B1	45	18	B1			
H200 Bus	KMF	1997 →	65	26	B1	50	20	B1			
H200 Highway Box		2000 →	65	26	B1	50	20	B1			
H350		1994 →	45	18	B1	45	18	B1			
H600		1994 →	45	18	B1	45	18	B1			
HIGHWAY Van		2000 →	65	26	B1	50	20	B1			
i10	PA	Mrz 08 → Sep 13	56	22	B1	40	16	B1	C30	C12	RA
	IA	Dez 13 →	56	22	B1	40	16	B1	C25	C10	RG
	AC3, AI3	Sep 19 →	60	24	B1	40	16	B1	C25	C10	RA
i20	PB, PBT	Jan 09 →	60	24	B1	40	16	B1	C30	C12	RA
i20 ACTIVE	IB, GB	Sep 15 →	60	24	B1	40	16	B1	C30	C12	RA
i20 COUPE	GB	Mai 15 →	60	24	B1	40	16	B1	C30	C12	RA
i30	FD	Okt 07 → Mrz 10	60	24	TL	45	18	TL	C30	C12	RB
		Apr 10 → Nov 11	60	24	B1	45	18	B1	C30	C12	RB
	GD	Dez 11 →	65	26	B1	35	14	B1			
i30 Coupe		Mai 13 →	65	26	B1	35	14	B1			
i30 CW	FD	Feb 08 → Mrz 10	60	24	TL	45	18	TL	C30	C12	RG

Autemarke / car-type марка автомобиля		Baujahr year of manufacture год выпуска	Fahrer / Driver водитель			Beifahrer Passenger пассажир			Heck / Rear заднее стекло C=CLASSIC/F=FLAT		
			cm	inch	Ad	cm	inch	Ad	cm	inch	Ad
i30 CW	FD	Apr 10 → Jun 12	60	24	B1	45	18	B1	C30	C12	RG
	GD	Jun 12 →	65	26	B1	35	14	B1			
i30 FASTBACK	PDE, PDEN	Jun 17 →	65	26	B1	40	16	B1	C30	C12	RG
i40	VF	Mrz 12 →	65	26	B1	40	16	B1	C35	C14	RG
i40 CW	VF	Jul 11 →	65	26	B1	40	16	B1	C35	C14	RG
ix20	JC	Nov 10 →	65	26	TL	35	14	TL	C30	C12	RD
ix35	LM, EL, ELH	Jan 10 →	60	24	B1	40	16	B1	C30	C12	RB
ix55		Jan 11 →	60	24	TL	50	20	TL	C25	C10	RA
IONIQ / IONIO Electric	AE	Mrz 16 →	65	26	B1	45	18	B1			
KONA / KONA EV	OS	Jun 17 →	65	26	B1	40	16	B1	C28	C11	RA
LANTRA II	J-2	Nov 95 → Sep 00	50	20	B1	45	18	B1			
LANTRA II Wagon	J-2	Feb 96 → Sep 00	50	20	B1	45	18	B1			
MATRIX	FC	Aug 01 → Apr 10	56	22	B1	40	16	B1	C35	C14	RD+
PONY / EXCEL Stufenheck		Jan 90 → Jul 94	45	18	B1	45	18	B1			
PORTER Kasten		Jul 94 → Apr 04	45	18	B1	45	18	B1			
PORTER Pick-up		Jul 94 → Apr 04	45	18	B1	45	18	B1			
S COUPE	SLC	Feb 90 → Apr 95	48	19	B1	43	17	B1			
SANTA FÉ I	SM	Feb 01 → Dez 05	56	22	B1	50	20	B1	C30	C12	RD+
SANTA FÉ II	CM	Mrz 06 → Dez 12	60	24	B1	45	18	B1	C30	C12	RB
SANTA FÉ III	DM	Sep 12 →	65	26	B1	35	14	B1	C35	C14	RD+
SANTA FÉ IV	TM, TMA	Feb 18 →	65	26	B1	40	16	B1	C30	C12	RG
SANTAMO		Mai 99 →	56	22	B1	45	18	B1	C40	C16	RD+
SATELLITE Bus		1994 → 1997	45	18	B1	45	18	B1			
		1997 →	65	26	B1	50	20	B1			
SONATA II	Y-2	Jan 91 → Jun 93	50	20	B1	45	18	B1			
SONATA III	Y3	Jul 93 → Jun 98	50	20	B1	50	20	B1			
SONATA IV	EF	Okt 01 → Nov 04	56	22	B1	50	20	B1			
SONATA V	NF	Jan 05 → Dez 10	60	24	B1	50	20	B1			
TERRACAN	HP	Dez 01 → Okt 06	56	22	B1	50	20	B1	C40	C16	RD+
TRAJET	FO	Mrz 00 → Jul 08	65	26	B1	56	22	B1	C40	C16	RD+
TUCSON	JM	Aug 04 → Mrz 10	60	24	B1	40	16	B1	C25	C10	RD+
	TL	Jun 15 →	65	26	B1	40	16	B1	C35	C14	RA
VELOSTER	FS	Mrz 11 →	65	26	B1	45	18	B1			

A
B
C
D
E
F
G
H
I
J
K
L
M
N
O
P
Q
R
S
T
U
V
W
X
Y
Z

Autemarke / car-type марка автомобиля		Baujahr year of manufacture год выпуска	Fahrer / Driver водитель			Beifahrer Passenger пассажир			Heck / Rear заднее стекло C=CLASSIC / F=FLAT		
			cm	inch	Ad	cm	inch	Ad	cm	inch	Ad
... HYUNDAI											
XG	XG	Dez 98 → Dez 05	56	22	B1	50	20	B1			
INFINITI											
EX		Okt 08 →	60	24	B1	45	18	B1	C35	C14	RD+
EX - 25		Apr 10 →	60	24	B1	40	16	B1	C35	C14	RD+
FX		Jan 03 → Aug 08	56	22	B1	50	20	B1			
		Okt 08 →	60	24	B1	48	19	B1	C35	C14	RB
G Coupe		Okt 07 →	65	26	B1	40	16	B1			
G Stufenheck		Okt 08 →	65	26	B1	40	16	B1			
G Stufenheck 35		Okt 02 →	65	26	B1	43	17	B1			
M	Y51	Mrz 10 →	65	26	B1	48	19	B1			
M30 Convertible		Jan 90 → Dez 93	50	20	B1	50	20	B1			
Q50		Apr 13 →	65	26	B1	40	16	B1			
Q60 Cabriolet		Okt 13 →	65	26	B1	40	16	B1			
Q60 Coupe		Okt 13 →	65	26	B1	40	16	B1			
QX30		Apr 16 →	60	24	PT	48	19	PT	F30	F12	R1
QX50		Aug 13 →	65	26	B1	40	16	B1			
QX70		Aug 13 →	60	24	B1	48	19	B1			
ISUZU											
ASCENDER		Mrz 03 →	53	21	B1	53	21	B1			
D-MAX	8DH	Mai 02 →	53	21	B1	48	19	B1			
		Jun 12 →	53	21	B1	48	19	B1			
EGR Truck		2006 →	53	21	B1	53	21	B1			
GEMINI		Jan 90 → Dez 93	40	16	B1	40	16	B1			
IMPULSE Coupe		Jan 90 → Dez 93	56	22	B1	53	21	B1	50	20	B1
NPR		1998 →	50	20	B1	50	20	B1			
NQR Truck		1998 →	50	20	B1	50	20	B1			
RODEO		1991 →	45	18	B1	45	18	B1			
TROOPER	UB	Aug 91 → Jul 98	50	20	B1	50	20	B1			
		1991 → 2002	50	20	B1	50	20	B1			
		Apr 00 →	50	20	B1	50	20	B1			
TROOPER Open Off-Road Vehicle	UB	1991 → 2002	50	20	B1	50	20	B1			
TROOPER Soft Top	UB	Aug 91 → Apr 92	50	20	B1	50	20	B1			
		Apr 00 →	50	20	B1	50	20	B1			
JAGUAR											
E-PACE	X540	Sep 17 →	65	26	TLC	50	20	TLC			

SPZIFIKATION FÜR FAHRZEUGE / Specification for cars • Спецификация автомобилей

Autamarke / car-type марка автомобиля		Baujahr year of manufacture год выпуска	Fahrer / Driver водитель			Beifahrer Passenger пассажир			Heck / Rear заднее стекло C=CLASSIC/F=FLAT		
			cm	inch	Ad	cm	inch	Ad	cm	inch	Ad
F-PACE		Apr 16 →	65	26	TL	48	19	TL			
F-TYPE Cabriolet		Okt 12 →	53	21	B1	53	21	B1			
F-TYPE Coupe		Okt 13 →	53	21	B1	53	21	B1			
I-PACE	X590	Feb 18 →	65	26	ST	50	20	ST			
S-TYPE	CCX	Jan 99 → Apr 02	56	22	B1	56	22	B1			
		Okt 01 → Okt 07	60	24	B1	48	19	B1			
XE		Jun 15 →	70	28	TL	43	17	TL			
XF	J05, CC9	Mrz 08 → Apr 15	58	23	PT	48	19	PT			
	X260	Mai 15 →	70	28	TL	43	17	TL			
XF SPORTBRAKE	CC9	Sep 12 → Dez 15	58	23	PT	48	19	PT			
	X260	Jul 17 →	70	28	TL	43	17	TL	C30	C12	RA
XJ	X300	1994 → 1997	53	21	B1						
	X308	Sep 97 → Aug 02	53	21	B1						
	X350, X358	Mai 03 → Mrz 09	60	24	B1	48	19	B1			
	X35, J12, J24	Aug 10 →	60	24	PT	48	19	PT			
XK Cabriolet	J43	Mrz 06 →	53	21	B1	53	21	B1			
XK Coupe	J43	Mrz 06 →	53	21	B1	53	21	B1			
XK 8 Convertible	QDV	Mrz 96 → Dez 06	53	21	B1	53	21	B1			
XK 8 Coupe	QEV	Mrz 96 → Dez 06	53	21	B1	53	21	B1			
X-TYPE	CF1	Jun 01 → Nov 09	56	22	B1	48	19	B1			
X-TYPE Estate		Nov 03 → Dez 09	56	22	B1	48	19	B1	C35	C14	RE
JEEP											
CHEROKEE	KJ	Sep 01 → Dez 07	48	19	B1	48	19	B1	C25	C10	RD+
	KK	Mai 08 →	48	19	B1	48	19	B1	C25	C10	RD+
	KL	Nov 13 →	56	22	B1	53	21	B1			
COMMANDER	XK	Sep 05 → Dez 10	45	18	B1	45	18	B1	C35	C14	RD+
COMPASS	MK49	Okt 06 →	56	22	B1	50	20	B1			
GRAND CHEROKEE I	ZJ	Sep 92 → Apr 99	50	20	B1	50	20	B1			
GRAND CHEROKEE II	WJ, WG	Sep 00 → Dez 04	53	21	B1	53	21	B1	C25	C10	RD+
GRAND CHEROKEE III	WH, WK	Jun 05 → Sep 10	53	21	B1	53	21	B1	C40	C16	RD+
GRAND CHEROKEE IV	WK, WK2	Nov 10 →	56	22	B1	53	21	B1			

A
B
C
D
E
F
G
H
I
J
K
L
M
N
O
P
Q
R
S
T
U
V
W
X
Y
Z

Automarke / car-type марка автомобиля	Baujahr year of manufacture год выпуска	Fahrer / Driver водитель			Beifahrer Passenger пассажир			Heck / Rear заднее стекло C=CLASSIC / F=FLAT			
		cm	inch	Ad	cm	inch	Ad	cm	inch	Ad	
... JEEP											
PATRIOT	MK74	Jan 08 →	53	21	B1	53	21	B1			
RENEGADE		Jul 14 →	56	22	TL	56	22	TL			
WRANGLER II	TJ	Aug 96 → Apr 07	33	13	B1	33	13	B1			
KIA											
CARENS I	FC	Nov 00 → Jul 02	60	24	B1	48	19	B1	C35	C14	RD+
CARENS II	FJ	Sep 02 → Aug 06	60	24	B1	48	19	B1	C25	C10	RD+
CARENS III	UN	Sep 06 →	65	26	B1	40	16	B1			
CARENS IV		Mrz 13 →	70	28	B1	65	26	B1	C25	C10	RA
CARNIVAL II	GQ	Okt 01 → Jun 06	60	24	B1	60	24	B1			
CARNIVAL III	VQ	Jun 06 →	65	26	B1	45	18	B1			
CEE'D	JD	Mai 12 →	65	26	B1	35	14	B1			
	CD	Jul 18 →	65	26	B1	40	16	B1			
CEE'D Schrägheck	ED	Dez 06 → Jun 09	60	24	TL	45	18	TL	C25	C10	RD+
		Jul 09 → Dez 12	60	24	B1	45	18	B1			
CEE'D SW	ED	Sep 07 → Jun 09	60	24	TL	45	18	TL	C25	C10	RD+
		Jul 09 → Dez 12	60	24	B1	45	18	B1			
	JD	Sep 12 →	65	26	B1	35	14	B1			
	CD	Jul 18 →	65	26	B1	40	16	B1			
CERATO	LD	Apr 04 → Nov 09	60	24	B1	40	16	B1			
CERATO Stufenheck	LD	Apr 04 → Nov 09	60	24	B1	40	16	B1			
CERATO II Stufenheck	TD	Aug 10 →	60	24	B1	50	20	B1			
CLARUS	K9A	Jul 96 → Nov 01	53	21	B1	48	19	B1			
CLARUS Kombi	GC	Jun 98 → Nov 01	53	21	B1	48	19	B1			
GRAND CARNIVAL III	VQ	Jun 06 →	65	26	B1	45	18	B1			
JOICE		Jan 00 → Mrz 03	53	21	B1	45	18	B1	C40	C16	RD+
K2500	SD	Jan 03 → Dez 06	53	21	B1	48	19	B1			
K2700	SD	Okt 99 → Aug 04	53	21	B1	45	18	B1			
K2900		Jan 08 →	53	21	B1	48	19	B1			
MAGENTIS	GD	Mai 01 → Dez 05	56	22	B1	50	20	B1			
	MG	Aug 06 → Apr 10	60	24	B1	45	18	B1			
MENTOR	FA	1993 → 1997	53	21	B1	48	19	B1			
NIRO	DE	Okt 16 →	65	26	B1	40	16	B1			
OPIRUS	GH	Sep 03 →	60	24	B1	45	18	B1			

SPZIFIKATION FÜR FAHRZEUGE / Specification for cars • Спецификация автомобилей

Autemarke / car-type марка автомобиля		Baujahr year of manufacture год выпуска	Fahrer / Driver водитель			Beifahrer Passenger пассажир			Heck / Rear заднее стекло C=CLASSIC/F=FLAT		
			cm	inch	Ad	cm	inch	Ad	cm	inch	Ad
OPTIMA	TF	Mrz 12 →	60	24	B1	45	18	B1			
	JF	Jul 17 →	65	26	B1	40	16	B1			
OPTIMA SPORTS WAGON	JF	Jul 17 →	65	26	B1	40	16	B1			
PICANTO	BA	Mai 04 → Jan 11	56	22	B1	40	16	B1	C30	C12	RG
	TA	Mai 11 →	56	22	B1	40	16	B1	C30	C12	RG
	JA	Mai 17 →	60	24	B1	35	14	B1	C25	C10	RB
PREGIO Bus		Aug 01 → Apr 04	53	21	B1	45	18	B1			
		Mai 04 → Sep 04	53	21	B1	48	19	B1			
PREGIO Kasten	TB	Okt 97 → Apr 04	53	21	B1	45	18	B1			
		Mai 04 → Dez 06	53	21	B1	48	19	B1			
PRIDE	DA	Dez 95 → Feb 00	45	18	B1	45	18	B1			
PRIDE Kombi		Aug 99 → Jan 00	45	18	B1	45	18	B1			
PRO CEE'D	ED	Feb 08 → Jun 09	60	24	TL	45	18	TL	C25	C10	RD+
		Jul 09 → Dez 12	60	24	B1	45	18	B1			
	JD	Mrz 13 →	65	26	B1	35	14	B1			
	CD	Jul 18 →	65	26	B1	40	16	B1			
RETONA	CE	Jun 99 →	35	14	B1	35	14	B1			
RIO I Kombi	DC	Sep 02 → Feb 05	53	21	B1	45	18	B1	C30	C12	RD+
RIO I Stufenheck	DC	Sep 00 → Feb 05	53	21	B1	45	18	B1			
RIO II	JB	Mrz 05 → Sep 11	56	22	B1	40	16	B1			
RIO II Stufenheck	JB	Mrz 05 → Sep 11	56	22	B1	40	16	B1			
RIO III	UB	Sep 11 →	65	26	B1	40	16	B1	C25	C10	RA
RIO III Stufenheck	UB	Okt 11 →	65	26	B1	40	16	B1			
RIO IV	YB	Feb 17 →	65	26	B1	40	16	B1	C25	C10	RA
ROADSTER - 1.8		Aug 99 →	53	21	B1	53	21	B1			
SEDONA	UP	1998 → 2001	60	24	B1	60	24	B1			
SEDONA II	GQ	2001 → 2005	60	24	B1	60	24	B1			
SEPHIA	FA	Jul 95 → Okt 97	53	21	B1	48	19	B1			
SEPHIA Stufenheck	FA	Sep 93 → Okt 97	53	21	B1	48	19	B1			
SHUMA	FB	Jan 98 → Dez 00	53	21	B1	48	19	B1			
SHUMA Stufenheck	FB	Jan 98 → Dez 00	53	21	B1	48	19	B1			
SHUMA II	FB	Mai 01 → Aug 04	53	21	B1	48	19	B1			
SHUMA II Stufenheck	FB	Mai 01 → Aug 04	53	21	B1	48	19	B1			
SORENTO I	JC	Mrz 03 → Aug 09	60	24	B1	45	18	B1	C35	C14	RD+

A
B
C
D
E
F
G
H
I
J
K
L
M
N
O
P
Q
R
S
T
U
V
W
X
Y
Z

Automarke / car-type марка автомобиля		Baujahr year of manufacture год выпуска	Fahrer / Driver водитель			Beifahrer Passenger пассажир			Heck / Rear заднее стекло C=CLASSIC / F=FLAT		
			cm	inch	Ad	cm	inch	Ad	cm	inch	Ad
... KIA											
SORENTO II	XM	Nov 09 →	60	24	B1	45	18	B1	C25	C10	RA
SORENTO III	UM	Feb 15 →	65	26	B1	40	16	B1	C30	C12	RB
SOUL	AM	Feb 09 →	60	24	B1	45	18	B1	C25	C10	RD+
SOUL II	PS	Feb 14 →	60	24	B1	50	20	B1			
SOUL III E-SOUL	SK3	Jan 19 →	60	24	B1	50	20	B1			
SPORTAGE	K00	Apr 94 → Aug 03	50	20	B1	50	20	B1			
	JE	Sep 04 → Apr 07	60	24	B1	40	16	B1			
	SL	Jul 10 →	60	24	B1	45	18	B1	C30	C12	RG
	OL, QLE	Sep 15 →	65	26	B1	40	16	B1	C25	C10	RA
STINGER	CK	Mai 17 →	65	26	B1	45	18	B1			
STONIC	YB	Okt 17 →	65	26	B1	40	16	B1	C30	C12	RA
VENGA	YN	Feb 10 →	65	26	TL	35	14	TL	C30	C12	RD
XCEED	CD	Jun 19 →	65	26	B1	40	16	B1			
LADA											
110		Jan 96 → Dez 10	50	20	B1	50	20	B1			
111		Jan 96 → Dez 09	50	20	B1	50	20	B1			
112		Jan 96 → Dez 08	50	20	B1	50	20	B1			
1106		1997 →	50	20	B1	50	20	B1			
GRANTA		Jan 12 →	60	24	B1	40	16	B1			
KALINA Kombi	1117	Jul 07 → Dez 12	60	24	B1	40	16	B1	33	13	B1
	2194	Nov 13 →	60	24	B1	40	16	B1	33	13	B1
KALINA Schrägheck	1119	Nov 04 →	60	24	B1	40	16	B1			
LAGUS		2012 →	50	20	B1	50	20	B1			
NADESCHDA Combi / Estate	2120	Dez 97 →	50	20	B1	50	20	B1			
NIVA BRONTO	2131	Mai 04 →	40	16	B1	40	16	B1			
NIVA II	2123	Sep 02 →	50	20	B1	50	20	B1			
NOVA / KALINKA	2105, 2108, 2109	1998 →	35	14	B1	35	14	B1			
	2104	1998 →	35	14	B1	35	14	B1			
PREMIER	21108	2000 →	50	20	B1	50	20	B1			
PRIORA Kombi	2171	Okt 09 →	50	20	B1	50	20	B1			
PRIORA Stufenheck	2170	Dez 08 →	50	20	B1	50	20	B1			
SAMARA FORMA	21099	Sep 91 → Dez 00	50	20	B1	50	20	B1			

Spezifikation für Fahrzeuge / Specification for cars • Спецификация автомобилей

Autemarke / car-type марка автомобиля		Baujahr year of manufacture год выпуска	Fahrer / Driver водитель			Beifahrer Passenger пассажир			Heck / Rear заднее стекло C=CLASSIC/F=FLAT		
			cm	inch	Ad	cm	inch	Ad	cm	inch	Ad
TAIGA II		2002 →	50	20	B1	50	20	B1	33	13	B1
LAMBORGHINI											
Gallardo		2005 →	70	28	B1	70	28	B1			
LANCIA											
DELTA II	836	Jun 93 → Aug 99	53	21	B1	48	19	B1			
DELTA III	844	Sep 08 → Aug 14	60	24	TL	45	18	TL	C30	C12	RD
KAPPA	838A	Nov 94 → Dez 00	60	24	B1	50	20	B1			
KAPPA Coupe	838	Jul 96 → Jun 00	60	24	B1	50	20	B1			
KAPPA SW	838B	Jul 96 → Dez 00	60	24	B1	50	20	B1			
LARGUS		Apr 12 →	50	20	B1	50	20	B1			
LYBRA	839AX	Okt 99 → Sep 05	56	22	B1	50	20	B1			
LYBRA SW	839BX	Okt 99 → Sep 05	56	22	B1	50	20	B1			
MUSA	350	Jan 06 → Sep 07	58	23	B1	38	15	B1			
		Okt 07 →	58	23	TL	38	15	TL			
PHEDRA	179	Okt 05 → Nov 10	65	26	B1	65	26	B1	C35	C14	RD+
THEMA	LX	Sep 11 →	60	24	B1	53	21	B1			
THESIS	841AX	Jul 02 → Jul 09	65	26	B1	50	20	B1			
VOYAGER	RT	Sep 11 →	65	26	B1	50	20	B1			
Y	840A	Mrz 96 → Jun 03	58	23	B1	40	16	B1			
YPSILON	843	Okt 03 → Nov 11	60	24	B1	40	16	B1			
	312, 846	Mai 11 →	60	24	TL	38	15	TL			
ZETA	220	Mai 99 → Jun 02	65	26	B1	50	20	B1			
LAND ROVER											
DEFENDER Cabrio	LD	Sep 90 →	33	13	B1	33	13	B1	33	13	B1
DEFENDER Station Wagon	LD	Sep 90 →	33	13	B1	33	13	B1	33	13	B1
DEFENDER Pick-up	LD	Jun 98 →	33	13	B1	33	13	B1	33	13	B1
DEFENDER Pritsche/Fahrgestell	LD	Sep 11 →	33	13	B1	33	13	B1	C30	C12	RD+
DISCOVERY SPORT	B5	Sep 14 →	65	26	B1	50	20	B1			
DISCOVERY III	TAA	Sep 04 → Aug 09	56	22	B1	56	22	B1	C40	C16	RD
DISCOVERY IV	LA	Sep 09 →	56	22	B1	56	22	B1	C40	C16	RD
DISCOVERY V		Apr 17 →	60	24	TLC	50	20	TLC			
FREELANDER	LN	Feb 98 → Okt 06	56	22	B1	53	21	B1			
FREELANDER Soft Top		Feb 98 → Okt 06	56	22	B1	50	20	B1			
FREELANDER 2	FA	Okt 06 → Nov 14	60	24	PT	48	19	PT	C30	C12	RD

A
B
C
D
E
F
G
H
I
J
K
L
M
N
O
P
Q
R
S
T
U
V
W
X
Y
Z

Automarke / car-type марка автомобиля		Baujahr year of manufacture год выпуска	Fahrer / Driver водитель			Beifahrer Passenger пассажир			Heck / Rear заднее стекло C=CLASSIC / F=FLAT		
			cm	inch	Ad	cm	inch	Ad	cm	inch	Ad
... LAND ROVER											
RANGE ROVER EVOQUE	LV	Sep 11 →	60	24	TL	53	21	TL			
	L551	Dez 18 →	65	26	TL	53	21	TL			
RANGE ROVER SPORT	LS	Mrz 05 → Aug 13	56	22	B1	56	22	B1			
	LW	Sep 13 → Aug 16	60	24	B1	50	20	B1			
		Sep 16 →	60	24	TLC	50	20	TLC			
RANGE ROVER VELAR		Aug 17 →	65	26	TL	48	19	TL			
RANGE ROVER II	LP	Jul 94 → Mrz 02	56	22	B1	56	22	B1			
RANGE ROVER IV	LG	Feb 13 → Dez 16	60	24	B1	50	20	B1			
		Sep 16 →	60	24	TLC	50	20	TLC			
LDV											
400		Nov 95 → Okt 96	50	20	B1	50	20	B1			
CONVOY		Okt 98 → Apr 09	50	20	B1	50	20	B1			
CUB		Aug 98 → Sep 01	60	24	B1	60	24	B1			
MAXUS		Feb 04 → Dez 09	56	22	B1	53	21	B1			
PILOT		1996 →	38	15	B1	38	15	B1			
LEXUS											
CT	ZWA1	Dez 10 →	65	26	B1	45	18	B1			
ES	F1, F2	Sep 91 → Dez 97	53	21	B1	53	21	B1			
	V6	Jun 12 → Jun 18	65	26	B1	45	18	B1			
	Z10, A10, H10	Jul 18 →	65	26	B1	45	18	B1			
GS	JZS147	Mrz 93 → Aug 97	53	21	B1	48	19	B1			
	JZS160, UZS161	Aug 97 → Jan 05	60	24	B1	50	20	B1			
	GRS19, GWS19, UZS19	Apr 05 → Nov 11	60	24	B1	50	20	B1			
	GRL1, GWL1	Mrz 12 →	65	26	B1	45	18	B1			
GX	460, 470	2009 →	65	26	B1	50	20	B1			
IS I	GXE1, JCE1	Apr 99 → Jul 05	56	22	B1	48	19	B1			
IS II	ALE2, GSE2, USE2	Okt 05 →	56	22	B1	50	20	B1			

SPZIFIKATION FÜR FAHRZEUGE / Specification for cars • Спецификация автомобилей

Automarke / car-type марка автомобиля		Baujahr year of manufacture год выпуска	Fahrer / Driver водитель			Beifahrer Passenger пассажир			Heck / Rear заднее стекло C=CLASSIC/F=FLAT		
			cm	inch	Ad	cm	inch	Ad	cm	inch	Ad
IS III	AVE3, GSE3	Apr 13 →	60	24	B1	45	18	B1			
IS C Cabriolet	GSE2	Apr 09 →	56	22	B1	50	20	B1			
IS SportCross		Okt 01 → Jul 05	56	22	B1	48	19	B1			
LFA	LFA10	Dez 10 →	60	24	B1						
LS	UCF20	Dez 94 → Okt 00	56	22	B1	40	16	B1			
	UCF30	Okt 00 → Aug 06	60	24	B1	40	16	B1			
	USF4, UVF4	Aug 07 →	60	24	B1	43	17	B1			
		Dez 08 →	60	24	B1	48	19	B1			
LX	UZJ100	Sep 01 → Mrz 08	60	24	B1	53	21	B1	C40	C16	RD+
RX	MCU15	Okt 00 → Mai 03	60	24	B1	53	21	B1			
	GSU3, MCU3, MHU3	Sep 05 → Aug 08	65	26	B1	56	22	B1			
	AGL10, GGL15, GYL1	Dez 08 → Dez 15	65	26	B1	56	22	B1			
	L2	Sep 15 → Feb 18	65	26	TL	50	20	TL			
		Mrz 18 →	65	26	TLC	50	20	TLC			
UX		Okt 18 →	65	26	B1	40	16	B1	C30	C12	RA
LIGIER											
162		1996 →	60	24	B1						
AMBRA		Dez 96 → Dez 06	60	24	B1						
BE UP		Aug 02 → Dez 06	60	24	B1						
NOVA		Aug 02 →	60	24	B1						
LOTUS											
EVORA		Mai 09 →	65	26	SL	65	26	SL			
MASERATI											
3200 GT, Spy		1998 →	56	22	B1	56	22	B1			
MAYBACH											
MAYBACH		Sep 05 → Dez 12	65	26	STSL	65	26	STSL			
MAZDA											
2	DY	Feb 03 → Jun 06	58	23	B1	40	16	B1	C35	C14	RB
	DE	Jun 07 → Jun 15	60	24	B1	35	14	B1	C35	C14	RB
	DL, DJ	Aug 14 →	56	22	B1	40	16	B1	C35	C14	RB
3	BK	Okt 03 → Dez 08	53	21	SL	48	19	SL	C35	C14	RE
	BL	Jun 09 → Dez 14	60	24	B1	48	19	B1	C35	C14	RA

A
B
C
D
E
F
G
H
I
J
K
L
M
N
O
P
Q
R
S
T
U
V
W
X
Y
Z

Automarke / car-type марка автомобиля		Baujahr year of manufacture год выпуска	Fahrer / Driver водитель			Beifahrer Passenger пассажир			Heck / Rear заднее стекло C=CLASSIC / F=FLAT		
			cm	inch	Ad	cm	inch	Ad	cm	inch	Ad
... MAZDA											
3	BM	Sep 13 →	60	24	B1	45	18	B1	C30	C12	RA
	BP	Nov 18 →	65	26	B1	40	16	B1	C35	C14	RB
3 Stufenheck	BK	Feb 04 → Dez 08	53	21	SL	48	19	SL			
	BL	Jun 09 → Dez 14	60	24	B1	48	19	B1			
	BM	Sep 13 →	60	24	B1	45	18	B1			
	BP	Nov 18 →	65	26	B1	40	16	B1			
5	CR19	Mrz 05 → Dez 10	65	26	B1	40	16	B1	C30	C12	RA
	CW	Sep 10 →	65	26	B1	40	16	B1	C30	C12	RA
6		Aug 02 → Aug 07	56	22	B1	48	19	B1			
	GG	Jun 05 → Aug 07	53	21	B1	45	18	B1			
	GH	Aug 07 → Dez 12	60	24	B1	40	16	B1			
6 Hatchback	GG	Aug 02 → Aug 07	56	22	B1	48	19	B1	50	20	B1
6 Kombi	GH, GJ	Dez 12 →	60	24	B1	45	18	B1	C30	C12	RA
6 Sport	GH	Aug 07 → Dez 12	60	24	B1	40	16	B1			
6 Sport Kombi	GH	Feb 08 → Dez 12	60	24	B1	40	16	B1	C30	C12	RA
6 Station Wagon	GY	Aug 02 → Aug 07	56	22	B1	48	19	B1	C30	C12	RA
6 Stufenheck	GH, GJ	Dez 12 →	60	24	B1	45	18	B1			
121 II	DB	Nov 90 → Mrz 96	50	20	B1	40	16	B1			
121 III	JASM, JBSM	Mrz 96 → Okt 99	48	19	B1	48	19	B1			
323	BA, BG, BJ	Mrz 91 → Sep 03	53	21	B1	45	18	B1			
626 III Station Wagon	GV	Mrz 92 → Nov 96	48	19	B1	48	19	B1			
626 IV	GE	Jan 92 → Mrz 97	53	21	B1	50	20	B1			
626 IV Hatchback	GE	Sep 91 → Mrz 97	53	21	B1	50	20	B1			
626 V	GF	Mai 97 → Apr 02	53	21	B1	48	19	B1			
626 V Hatchback	GF	Mai 97 → Apr 02	53	21	B1	48	19	B1			
626 V Station Wagon	GW	Feb 98 → Apr 02	53	21	B1	48	19	B1			
B-SERIE	UN	Jun 99 → Mrz 06	45	18	B1	45	18	B1			
BT-50	CD, UN	Dez 06 → Dez 15	45	18	B1	45	18	B1			
CX-3	DK	Feb 15 →	56	22	B1	45	18	B1	C25	C10	RB
CX-5	GH, KE	Nov 11 → Feb 17	60	24	B1	45	18	B1	C35	C14	RA
	KF	Feb 17 →	60	24	TLC	45	18	TLC	C35	C14	RA
CX-7	ER	Apr 07 → Dez 14	65	26	B1	40	16	B1	C35	C14	RA

Autemarke / car-type марка автомобиля		Baujahr year of manufacture год выпуска	Fahrer / Driver водитель			Beifahrer Passenger пассажир			Heck / Rear заднее стекло C=CLASSIC/F=FLAT		
			cm	inch	Ad	cm	inch	Ad	cm	inch	Ad
CX-9	TB	Sep 07 →	65	26	B1	40	16	B1	C35	C14	RA
CX-30	DM	Apr 19 →	65	26	B1	40	16	B1	C35	C14	RB
DEMIO	DW	Sep 98 → Feb 03	50	20	B1	40	16	B1			
MPV I	LV	Mrz 93 → Mai 99	53	21	B1	50	20	B1	43	17	B1
MPV II	LW	Aug 00 → Jun 04	60	24	B1	60	24	B1	C40	C16	RD+
MV-X		1998 →	53	21	B1	50	20	B1			
MX-3	EC	Jul 91 → Feb 98	53	21	B1	45	18	B1			
MX-5	NA	Mai 90 → Nov 97	45	18	B1	45	18	B1			
MX-5 II	NB	Mai 98 → Jul 05	45	18	B1	45	18	B1			
MX-5 III	NC	Jul 05 → Mrz 15	45	18	B1	45	18	B1			
MX-5 IV	ND	Jul 15 →	45	18	B1	48	19	B1			
MX-6	GE6	Feb 92 → Feb 97	50	20	B1	50	20	B1			
PREMACY	CP	Jul 99 → Mrz 05	60	24	B1	40	16	B1	C35	C14	RD+
RX 7 III	FD	Jul 92 → Aug 02	50	20	B1	50	20	B1	56	22	B1
RX 8	SE17	Okt 03 → Apr 12	50	20	B1	45	18	B1			
TRIBUTE	EP	Feb 01 → Mai 08	48	19	B1	48	19	B1			
XEDOS 6	CA	Jan 92 → Feb 99	53	21	B1	50	20	B1			
XEDOS 9	TA	Sep 93 → Sep 02	53	21	B1	50	20	B1			
MERCEDES-BENZ											
A-KLASSE	W168	Okt 97 → Aug 04	65	26	B1	60	24	B1	C30	C12	RD+
	W169	Sep 04 → Jun 12	65	26	PT	56	22	PT	C30	C12	RD
	W176	Jun 12 → Jun 15	60	24	PT	48	19	PT	F25	F10	R1
		Jul 15 → Mai 18	60	24	TLM	48	19	TLM	F25	F10	R1
W177	Mrz 18 →	60	24	TLM	48	19	TLM	F30	F12	R0	
B-KLASSE	W245	Apr 05 → Apr 11	65	26	PT	56	22	PT	C25	C10	RD
	W246	Nov 11 → Jun 15	65	26	PT	48	19	PT	C25	C10	RD
		Jul 15 → Dez 18	65	26	TLM	48	19	TLM	C25	C10	RD
W247	Dez 18 →	65	26	TLM	48	19	TLM	F30	F12	R0	
CABRIOLET	A124	Apr 92 → Jun 93	60	24	B1						
CITAN Kasten	415	Nov 12 →	56	22	B1	53	21	B1	C35	C14	RD+
		Nov 12 →	60	24	BL	56	22	BL	C35	C14	RD+
CITAN Kombi	415	Nov 12 →	56	22	B1	53	21	B1	C35	C14	RD+
CITAN Kombi	415	Nov 12 →	60	24	BL	56	22	BL	C35	C14	RD+
CITAN Mixto	415	Nov 12 →	56	22	B1	53	21	B1	C35	C14	RD+
		Nov 12 →	60	24	BL	56	22	BL	C35	C14	RD+
C-KLASSE	W202	Mrz 93 → Apr 00	60	24	B1						
	W203	Mai 00 → Jun 03	60	24	B1	50	20	B1			

A
B
C
D
E
F
G
H
I
J
K
L
M
N
O
P
Q
R
S
T
U
V
W
X
Y
Z

Automarke / car-type марка автомобиля	Baujahr year of manufacture год выпуска	Fahrer / Driver водитель			Beifahrer Passenger пассажир			Heck / Rear заднее стекло C=CLASSIC / F=FLAT			
		cm	inch	Ad	cm	inch	Ad	cm	inch	Ad	
... MERCEDES-BENZ											
C-KLASSE	W203	Jul 03 → Feb 07	56	22	CL	53	21	CL			
	W204	Jan 07 → Nov 08	60	24	SL	60	24	SL			
		Dez 08 → Apr 13	60	24	STSL	60	24	STSL			
	W205	Feb 14 → Okt 14	56	22	PT	53	21	PT			
Aug 14 →		56	22	TLM	53	21	TLM				
C-KLASSE Cabrio	A205	Sep 16 →	56	22	TLM	53	21	TLM			
C-KLASSE Coupe	CL203	Sep 02 → Jun 03	60	24	B1	50	20	B1			
		Jul 03 → Feb 08	56	22	CL	53	21	CL			
	C204	Jun 11 → Apr 13	60	24	STSL	60	24	STSL			
	C205	Okt 15 →	56	22	TLM	53	21	TLM			
C-KLASSE T-Modell	S202	Jun 96 → Feb 01	60	24	B1				C40	C16	RD+
		Mrz 01 → Jun 03	60	24	B1	50	20	B1	C40	C16	RD+
	S204	Jul 03 → Aug 07	56	22	CL	53	21	CL	C40	C16	RD+
		Sep 07 → Nov 08	60	24	SL	60	24	SL	C30	C12	RD
	S205	Dez 08 → Apr 13	60	24	STSL	60	24	STSL	C30	C12	RD
		Mai 14 → Okt 14	56	22	PT	53	21	PT	F25	F10	R1
		Aug 14 →	56	22	TLM	53	21	TLM	F25	F10	R1
CLA	C118	Mrz 19 →	60	24	TLM	48	19	TLM	F35	F14	R0
CLA Coupe	C117	Jan 13 → Jun 15	60	24	PT	48	19	PT			
		Jul 15 →	60	24	TLM	48	19	TLM			
CLK	C208	Jun 97 → Apr 02	60	24	B1						
	C209	Jun 02 → Sep 06	56	22	CL	53	21	CL			
CLK Cabriolet	A208	Mrz 98 → Mai 02	60	24	B1						
	A209	Feb 03 → Dez 09	56	22	CL	53	21	CL			
CLS	C218	Jan 11 → Feb 14	60	24	STSL	60	24	STSL			
		Mrz 14 → Dez 17	60	24	TL	60	24	TL			
	C257	Dez 17 →	60	24	TLM	55	22	TLM			
CLS Shooting Brake	X218	Okt 12 → Feb 14	60	24	STSL	60	24	STSL	F35	F14	R1
		Mrz 14 →	60	24	TL	60	24	TL	F35	F14	R1
E-KLASSE	W124	Jun 93 → Jun 95	60	24	B1						
	W210	Jun 95 → Mrz 02	65	26	B1						
	W211	Mrz 02 → Dez 08	65	26	STSL	65	26	STSL			
	W212	Aug 09 → Feb 14	60	24	STSL	60	24	STSL			
		Mrz 14 → Sep 16	60	24	TL	60	24	TL			
W213	Jan 16 →	60	24	TLM	53	21	TLM				
E-KLASSE Cabrio	A124	Jul 93 → Mrz 98	60	24	B1						

SPEZIFIKATION FÜR FAHRZEUGE / Specification for cars • Спецификация автомобилей

Autemarke / car-type марка автомобиля		Baujahr year of manufacture год выпуска	Fahrer / Driver водитель			Beifahrer Passenger пассажир			Heck / Rear заднее стекло C=CLASSIC/F=FLAT		
			cm	inch	Ad	cm	inch	Ad	cm	inch	Ad
E-KLASSE Cabrio	A207	Jan 10 → Apr 13	60	24	STSL	60	24	STSL			
	A238	Jun 17 →	60	24	TLM	53	21	TLM			
E-KLASSE Coupe	C124	Jul 93 → Jun 97	60	24	B1						
	C238	Dez 16 →	60	24	TLM	53	21	TLM			
E-KLASSE T-Modell	S124	Jul 93 → Mai 96	60	24	B1				45	18	B1
	S210	Jun 96 → Jan 03	65	26	B1				C40	C16	RD+
	S211	Mrz 03 → Jul 09	65	26	SL	65	26	SL	43	17	B1
	S212	Aug 09 → Feb 14	60	24	STSL	60	24	STSL	C30	C12	RD
		Mrz 14 → Aug 16	60	24	TL	60	24	TL	C30	C12	RD
E-KLASSE T-Modell / All-Terrain	S213	Jun 16 →	60	24	TLM	60	24	TLM	F30	F12	R1
EOC	N293	Mai 19 →	56	22	TLM	56	22	TLM	F25	F10	R0
GLA	X156	Dez 13 → Jun 15	60	24	PT	48	19	PT	F30	F12	R1
		Jun 15 →	60	24	TLM	48	19	TLM	F30	F12	R1
	H247	Feb 20 →	65	26	TLM	50	20	TLM	F35	F14	R1
GLC	X253	Jul 15 →	56	22	TLM	56	22	TLM			
GLC Coupe	C253	Jul 15 →	56	22	TLM	56	22	TLM			
GLE	X166	Apr 15 → Okt 18	65	26	TL	58	23	TL	C30	C12	RD
	V167	Okt 18 →	65	26	TLM	56	22	TLM	C30	C12	RD
GLE Coupe	C292	Jul 15 → Okt 19	65	26	TL	58	23	TL			
GLS	X166	Sep 15 → Apr 19	65	26	TL	58	23	TL	C30	C12	RD
G-KLASSE	W461	Feb 90 → Okt 01	40	16	B1	40	16	B1	C40	C16	RD+
	W463	Jun 90 →	40	16	B1	40	16	B1	C40	C16	RD+
G-KLASSE Geländewagen offen	W463	Jun 90 →	40	16	B1	40	16	B1			
GL-KLASSE	X164	Sep 06 → Dez 12	70	28	PT	53	21	PT	C30	C12	RD
	X166	Aug 12 → Dez 14	65	26	TL	58	23	TL	C30	C12	RD
GLK-KLASSE	X204	Apr 09 → Jan 14	56	22	SL	45	18	SL	C30	C12	RD
		Feb 14 → Aug 16	56	22	TL	45	18	TL	C30	C12	RD
M-KLASSE	W163	Mrz 98 → Jun 05	56	22	B1	53	21	B1			
	W164	Jul 05 → Jul 11	70	28	PT	53	21	PT	C30	C12	RD
	W166	Jun 11 → Aug 11	70	28	PT	53	21	PT	C30	C12	RD
		Sep 11 → Aug 15	65	26	TL	58	23	TL	C30	C12	RD
R-KLASSE	V251, W251	Mai 07 → Okt 12	70	28	PT	53	21	PT			
S-KLASSE	W220	Okt 98 → Feb 00	65	26	TR	65	26	TR			
		Mrz 00 → Aug 05	65	26	SL	65	26	SL			

A
B
C
D
E
F
G
H
I
J
K
L
M
N
O
P
Q
R
S
T
U
V
W
X
Y
Z

Automarke / car-type марка автомобиля	Baujahr year of manufacture год выпуска	Fahrer / Driver водитель			Beifahrer Passenger пассажир			Heck / Rear заднее стекло C=CLASSIC / F=FLAT			
		cm	inch	Ad	cm	inch	Ad	cm	inch	Ad	
... MERCEDES-BENZ											
S-KLASSE	W221	Okt 05 → Dez 13	65	26	SL	65	26	SL			
	W222	Mai 13 →	65	26	TL	56	22	TL			
S-KLASSE Cabrio	C217	Dez 15 →	60	24	TL	56	22	TL			
S-KLASSE Coupe	C215	Mrz 00 → Jul 10	65	26	SL	65	26	SL			
	C216	Sep 06 →	65	26	SL	65	26	SL			
	C217	Feb 14 →	60	24	TL	56	22	TL			
SL	R129	Mrz 93 → Aug 01	60	24	B1						
	R231	Jan 12 →	65	26	SL	53	21	SL			
SL Cabrio	R230	Okt 01 → Dez 11	65	26	SL	65	26	SL			
SLC	R172	Jun 16 →	56	22	PT	56	22	PT			
SLK	R170	Sep 96 → Mrz 04	56	22	B1	53	21	B1			
	R171	Jun 04 → Aug 16	56	22	PT	56	22	PT			
	R172	Feb 11 →	56	22	PT	56	22	PT			
SLR	R199	Apr 04 → Dez 09	65	26	SL	65	26	SL			
SLR ROADSTER	R199	Okt 06 → Dez 09	65	26	SL	65	26	SL			
SPRINTER		Feb 95 → Mai 06	60	24	B1	53	21	B1			
		Jun 06 →	65	26	PT	60	24	PT			
Vaneo	414	Feb 02 → Jan 04	65	26	B1	60	24	B1	38	15	B1
		Feb 04 → Jul 05	65	26	PT	56	22	PT	38	15	B1
VIANO	W639	Sep 05 → Dez 14	70	28	PT	65	26	PT	F35	F14	R1
VITO	W639	Sep 05 → Jun 10	70	28	PT	65	26	PT			
		Jul 10 →	70	28	PT	65	26	PT	F38	F15	R1
VITO / Tourer / Kasten / eVITO	W447	Sep 14 →	70	28	TLM	45	18	TLM	F40	F16	R0
V-KLASSE	W447	Apr 14 →	70	28	TLM	45	18	TLM	F40	F16	R0
MG											
MG TF		Mrz 02 → Mai 05	50	20	B1	50	20	B1			
MG X-POWER		Jan 03 → Apr 08	56	22	B1	53	21	B1			
ZR		Okt 01 → Apr 05	45	18	B1	45	18	B1	45	18	B1
ZS		Okt 01 → Apr 05	50	20	B1	45	18	B1			
ZS Hatchback		Okt 01 → Mai 05	50	20	B1	45	18	B1	45	18	B1
ZT		Jun 01 → Jul 05	56	22	B1	53	21	B1	C35	C14	RE
ZT- T		Okt 01 → Jul 05	56	22	B1	53	21	B1			
MGF Cabriolet	RD	Okt 95 → Mrz 02	50	20	B1	50	20	B1			
MINI											
MINI	R50, R53	Jun 01 → Sep 06	48	19	B1	48	19	B1	C30	C12	RD

Spezifikation für Fahrzeuge / Specification for cars • Спецификация автомобилей

Autemarke / car-type марка автомобиля		Baujahr year of manufacture год выпуска	Fahrer / Driver водитель			Beifahrer Passenger пассажир			Heck / Rear заднее стекло C=CLASSIC / F=FLAT		
			cm	inch	Ad	cm	inch	Ad	cm	inch	Ad
MINI	R56	Nov 06 → Mrz 12	48	19	B1	48	19	B1	C25	C10	RA
		Apr 12 → Nov 13	45	18	BL	48	19	BL			
	F55	Mrz 14 →	45	18	B1	48	19	B1	C25	C10	RD
MINI Cabriolet	R52	Jul 04 → Nov 07	48	19	B1	48	19	B1			
	R57	Mrz 09 → Mrz 12	48	19	B1	48	19	B1			
		Apr 12 →	45	18	BL	48	19	BL			
MINI CLUBMAN	R55	Nov 07 → Mrz 12	48	19	B1	48	19	B1	F25	F10	R1
		Apr 12 →	45	18	BL	48	19	BL	F30	F12	R1
	F54	Nov 14 →	56	22	ST	50	20	ST			
MINI COUNTRYMAN	R60	Sep 10 → Okt 16	48	19	PT	50	20	PT	C25	C10	RD
		Okt 16 →	58	23	TLB	53	21	TLB			
MINI Coupe	R58	Sep 11 → Mrz 15	50	20	PT	50	20	PT			
MINI PACEMAN	R61	Mrz 13 → Okt 16	48	19	PT	50	20	PT			
MINI Roadster	R59	Feb 12 → Apr 15	50	20	PT	50	20	PT			
mitsubishi											
3000 GT	Z16A	Jun 92 → Aug 99	53	21	B1	50	20	B1			
ASX	GA	Mai 10 →	60	24	B1	53	21	B1	C25	C10	RB
CANTER 35, 55, 60, 75	FB4, FE4	Sep 92 → Sep 96	45	18	B1	45	18	B1			
	FB6, FE5, FE6	1996 → 2001	50	20	B1	50	20	B1			
CANTER Pritsche/Fahrgestell	FB, FE, FG	Aug 05 → Nov 10	50	20	B1	50	20	B1			
CARISMA	DA	Mai 97 → Dez 03	53	21	B1	50	20	B1	50	20	B1
CARISMA Stufenheck	DA	Mai 97 → Dez 03	53	21	B1	50	20	B1			
COLT CZC Cabriolet	RG	Mai 06 → Jul 08	65	26	B1	28	11	B1			
COLT IV	CA	Dez 91 → Nov 95	50	20	B1	45	18	B1	38	15	B1
COLT V	CJ, CP	Nov 95 → Jun 03	53	21	B1	48	19	B1	C35	C14	RD+
COLT VI	Z2, Z3	Apr 04 → Sep 08	65	26	B1	28	11	B1	C35	C14	RE
		Okt 08 → Apr 13	65	26	B1	28	11	B1	C30	C12	RE
ECLIPSE	D2	Apr 91 → Nov 95	50	20	B1	50	20	B1			
ECLIPSE CROSS	GK	Okt 17 →	60	24	B1	50	20	B1	C25	C10	RD
ECLIPSE II	D3	Dez 95 → Apr 99	60	24	B1	53	21	B1			
GALANT Stufenheck	DJ, ED, EF	Okt 03 →	65	26	B1	45	18	B1			
GALANT V	E5, E7, E8	Nov 92 → Mai 96	53	21	B1	48	19	B1	C40	C16	RD+
GALANT VI	EA	Okt 96 → Mai 03	53	21	B1	45	18	B1			

A
B
C
D
E
F
G
H
I
J
K
L
M
N
O
P
Q
R
S
T
U
V
W
X
Y
Z

Autemarke / car-type марка автомобиля		Baujahr year of manufacture год выпуска	Fahrer / Driver водитель			Beifahrer Passenger пассажир			Heck / Rear заднее стекло C=CLASSIC / F=FLAT		
			cm	inch	Ad	cm	inch	Ad	cm	inch	Ad
... MITSUBISHI											
GALANT VI Station Wagon	EA	Okt 96 → Sep 02	53	21	B1	45	18	B1	C40	C16	RD+
GALLOPER	JK-01	Sep 98 → Dez 03	43	17	B1	43	17	B1			
GRANDIS	NA	Apr 04 → Jan 08	70	28	TR	56	22	B1	C30	C12	RB
		Feb 08 → Nov 10	70	28	B1	56	22	B1	C30	C12	RB
i	HA	Jul 09 →	70	28	TR				C30	C12	RB
L 200	K6, K7	Jun 96 → Dez 07	40	16	B1	40	16	B1			
	KA, KB	Dez 05 →	53	21	B1	48	19	B1			
L 300	P1_T	Jul 94 → Apr 00	45	18	B1	45	18	B1			
L 400		Sep 96 → Jun 05	65	26	B1	65	26	B1			
LANCER Stufenheck		Sep 03 → Apr 10	60	24	B1	45	18	B1			
	CY/Z	Feb 08 →	60	24	B1	40	16	B1			
LANCER V	CB/D-A	Jun 92 → Dez 93	50	20	B1	43	17	B1			
LANCER V Station Wagon	CB, CD	Dez 92 → Sep 00	50	20	B1	43	17	B1			
LANCER VI	CJ-CP	Dez 95 → Aug 03	53	21	B1	48	19	B1			
LANCER VII Kombi	CS	Sep 03 → Jun 08	60	24	B1	45	18	B1			
LANCER VIII SPORTBACK	CX	Aug 08 →	60	24	B1	40	16	B1	C35	C14	RB
MIRAGE		1991 → 1995	50	20	B1	43	17	B1			
		1995 → 2003	53	21	B1	48	19	B1			
MONTERO	V2, V4	1990 → 2000	48	19	B1	48	19	B1			
MONTERO Classic	V2	2002 →	50	20	B1	50	20	B1			
OUTLANDER I	CU	Mai 03 → Okt 06	56	22	B1	45	18	B1	C30	C12	RD+
OUTLANDER II	CW	Nov 06 → Nov 12	60	24	B1	53	21	B1	C30	C12	RD+
OUTLANDER III	GF, GG	Apr 12 →	65	26	B1	45	18	B1	C30	C12	RB
PAJERO PININ		Okt 99 → Jun 07	48	19	B1	48	19	B1	C40	C16	RD+
PAJERO SPORT		Nov 98 → Feb 09	50	20	B1	50	20	B1			
PAJERO II		Dez 90 → Apr 00	48	19	B1	48	19	B1			
PAJERO III		Apr 00 → Aug 06	50	20	B1	50	20	B1	C40	C16	RD+
PAJERO IV		Feb 07 →	56	22	B1	50	20	B1	C35	C14	RD
SANTAMO		Mai 99 → Dez 04	56	22	B1	45	18	B1			
SIGMA	F16A	Dez 90 → Jul 96	50	20	B1	48	19	B1			
SIGMA Station Wagon		Jan 93 → Okt 96	50	20	B1	48	19	B1			
SPACE GEAR		1995 → 2000	65	26	B1	65	26	B1			

Autemarke / car-type марка автомобиля		Baujahr year of manufacture год выпуска	Fahrer / Driver водитель			Beifahrer Passenger пассажир			Heck / Rear заднее стекло C=CLASSIC/F=FLAT		
			cm	inch	Ad	cm	inch	Ad	cm	inch	Ad
SPACE RUNNER	N1	Okt 91 → Mai 99	56	22	B1	45	18	B1			
	N6	Aug 99 → Aug 02	56	22	B1	45	18	B1			
SPACE STAR	DG	Jun 98 → Dez 04	53	21	B1	45	18	B1	C30	C12	RA
SPACE WAGON	N3	Okt 91 → Okt 98	56	22	B1	45	18	B1			
	N9	Okt 98 → Jan 04	65	26	B1	40	16	B1	C35	C14	RD+
MOSKVICHS											
Pick-Up		1991 →	45	18	B1	45	18	B1			
NISSAN											
100 NX	B13	Mrz 90 → Okt 94	53	21	B1	48	19	B1			
200 SX	S14	Okt 93 → Dez 99	53	21	B1	50	20	B1			
300 ZX	Z32	Mai 90 → Sep 95	53	21	B1	53	21	B1			
350 Z	Z33	Sep 02 → Apr 09	50	20	B1	45	18	B1	45	18	B1
350 Z Roadster	Z33	Mrz 05 → Apr 09	50	20	B1	45	18	B1			
370 Z	Z34	Jun 09 →	60	24	B1	48	19	B1			
370 Z Roadster	Z34	Jan 10 →	60	24	B1	48	19	B1			
ALMERA I	N15	Sep 95 → Apr 00	53	21	B1	48	19	B1			
ALMERA I Hatchback	N15	Sep 95 → Mrz 00	53	21	B1	48	19	B1	C35	C14	RD
ALMERA II	N16	Jul 00 → Nov 06	56	22	B1	40	16	B1	C35	C14	RD
ALMERA II Hatchback	N16	Mrz 00 → Nov 06	56	22	B1	40	16	B1	C35	C14	RD
ALMERA TINO	V10	Aug 00 → Dez 05	65	26	B1	45	18	B1	50	20	B1
CUBE	Z12	Mrz 11 →	50	20	B1	50	20	B1			
GT-R	R35	Feb 11 →	56	22	B1	48	19	B1			
JUKE	F15	Jul 10 →	56	22	B1	35	14	B1	C30	C12	RD
	F16	Aug 19 →	58	23	TL	38	15	TL	C30	C12	RD
KUBISTAR	X76	Aug 03 → Mrz 09	50	20	B1	50	20	B1	C35	C14	RD+
KUBISTAR Kasten	X80	Aug 03 → Mrz 09	50	20	B1	50	20	B1	C35	C14	RD+
LEAF		Nov 10 →	65	26	B1	40	16	B1			
	ZE 1E	Jan 18 →	65	26	B1	40	16	B1	C35	C14	RB
MAXIMA QX	A32	Jan 95 → Jan 00	53	21	B1	53	21	B1			
	A33	Mrz 00 → Nov 03	65	26	B1	45	18	B1			
MICRA II	K11	Aug 92 → Okt 02	50	20	B1	45	18	B1	C40	C16	RD+
MICRA III	K12	Jan 03 → Jun 10	53	21	B1	45	18	B1	C40	C16	RD
MICRA IV	K13	Nov 10 → Okt 15	53	21	B1	35	14	B1	C30	C12	RB
MICRA V	K14	Jan 17 →	65	26	B1	35	14	B1	C25	C10	RA
MICRA C+C	K12	Sep 05 → Okt 10	53	21	B1	45	18	B1			

A
B
C
D
E
F
G
H
I
J
K
L
M
N
O
P
Q
R
S
T
U
V
W
X
Y
Z

Automarke / car-type марка автомобиля	Baujahr year of manufacture год выпуска	Fahrer / Driver водитель			Beifahrer Passenger пассажир			Heck / Rear заднее стекло C=CLASSIC / F=FLAT			
		cm	inch	Ad	cm	inch	Ad	cm	inch	Ad	
		... NISSAN									
MURANO	Z50	Sep 04 → Dez 08	65	26	B1	45	18	B1	C30	C12	RB
	Z51	Dez 08 →	65	26	B1	40	16	B1	C30	C12	RD+
NAVARA	D22	Jul 05 →	60	24	B1	48	19	B1			
NOTE	E11	Mrz 06 →	60	24	B1	35	14	B1	C30	C12	RB
	E12	Jun 13 →	60	24	B1	35	14	B1	C30	C12	RB
NP300 NAVARA	D40	Jul 05 →	60	24	B1	45	19	B1			
NT400 CABSTAR	F24M	Aug 09	50	20	B1	50	20	B1			
NV200 EVALIA		Jul 10 →	56	22	B1	40	16	B1			
NV200 Kasten		Feb 10 →	56	22	B1	40	16	B1			
NV200 Kasten/Kombi e-NV	ME0	Mai 14 →	56	22	B1	40	16	B1	C35	C14	RB
NV250 Kasten	X61	Jun 19 →	60	24	BL	53	21	BL	C35	C14	RD
NV300 Kasten	X82	Sep 16 →	65	26	TL	48	19	TL			
NV300 Heckklappe	X82	Sep 16 →	65	26	TL	48	19	TL	F40	F16	R1
NV300 Hecktüren	X82	Sep 16 →	65	26	TL	48	19	TL	C40	C16	RD
NV400 Bus		Nov 11 →	65	26	B1	65	26	B1			
NV400 Kasten		Nov 11 →	65	26	B1	65	26	B1			
NV400 Pritsche/Fahrgestell		Nov 11 →	65	26	B1	65	26	B1			
PATHFINDER	R50	Sep 97 → Dez 04	56	22	B1	50	20	B1	C25	C10	RD+
	R51	Sep 05 →	60	24	B1	48	19	B1	C30	C12	RB
PATROL GR II Wagon	Y61	Okt 97 → Mrz 10	50	20	B1	50	20	B1			
PIXO	UA0	Jun 09 →	56	22	B1	35	14	B1			
PRIMASTAR Bus	X83	Jul 02 →	60	24	B1	53	21	B1	C35	C14	RD+
PRIMASTAR Kasten	X83	Sep 02 →	60	24	B1	53	21	B1	C35	C14	RD+
PRIMERA	P10	Jun 90 → Jul 94	53	21	B1	48	19	B1			
	P11	Sep 96 → Dez 01	53	21	B1	50	20	B1			
	P12	Jan 02 → Sep 10	65	26	B1	45	18	B1			
PRIMERA Hatchback	P11	Sep 96 → Dez 01	53	21	B1	50	20	B1	53	21	B1
	P12	Jul 02 → Jul 10	65	26	B1	45	18	B1			
PRIMERA Traveller	WP11	Apr 98 → Dez 01	53	21	B1	50	20	B1			
	WP12	Jan 02 → Jun 10	65	26	B1	45	18	B1			
PULSAR		Jul 14 →	65	26	TL	35	14	TL			
QASHQAI	J10, JJ10	Feb 07 → Dez 13	60	24	PT	38	15	PT	C30	C12	RD

Autemarke / car-type марка автомобиля		Baujahr year of manufacture год выпуска	Fahrer / Driver водитель			Beifahrer Passenger пассажир			Heck / Rear заднее стекло C=CLASSIC/F=FLAT		
			cm	inch	Ad	cm	inch	Ad	cm	inch	Ad
QASHQAI		Feb 14 →	65	26	B1	40	16	B1	C30	C12	RD
SERENA	C23M	Nov 92 → Sep 01	60	24	B1	60	24	B1	C40	C16	RD+
SUNNY	N14, Y10	Okt 90 → Mrz 00	53	21	B1	48	19	B1	C30	C12	RD+
TERRANO II	R20	Apr 97 → Dez 06	53	21	B1	50	20	B1			
TIIDA Schrägheck	C11X	Sep 07 →	60	24	B1	35	14	B1			
TRADE Kasten/Kombi		Jun 96 → Dez 00	50	20	B1	50	20	B1			
TRADE Pritsche/Fahrgestell		Jan 94 → Dez 98	50	20	B1	50	20	B1			
VANETTE CARGO Bus	HC 23	Jan 96 → Okt 01	60	24	B1	60	24	B1			
VANETTE CARGO Kasten	HC 23	Jan 95 → Nov 01	60	24	B1	60	24	B1			
X-TRAIL	T30	Jul 01 → Mrz 07	60	24	B1	40	16	B1	C40	C16	RD+
	T31	Apr 07 →	60	24	B1	40	16	B1	C35	C14	RB
	T32	Apr 14 →	65	26	B1	40	16	B1	C30	C12	RB
OPEL											
ADAM	M13	Okt 12 → Feb 19	65	26	TL	40	16	TL	C35	C14	RE
AGILA (A)	H00	Aug 03 → Dez 07	50	20	B1	45	18	B1	C30	C12	RD+
AGILA (B)	H08	Apr 08 → Okt 14	56	22	B1	40	16	B1	C25	C10	RD+
AMPERA EV - 150		Nov 11 → Mrz 15	65	26	TL	65	26	TL			
ANTARA		Sep 08 →	60	24	B1	40	16	B1			
ARENA Combi / Bus / Kasten	TB, TF, THB	Jan 97 → Dez 01	50	20	B1	50	20	B1			
ASTRA F		Sep 91 → Feb 98	45	18	B1	45	18	B1	45	18	B1
ASTRA F Cabriolet	53	Mrz 93 → Feb 98	45	18	B1	45	18	B1			
ASTRA F Caravan		Sep 91 → Jan 98	45	18	B1	45	18	B1	33	13	B1
ASTRA G	F70	Jan 99 → Aug 05	50	20	B1	48	19	B1			
ASTRA G Caravan	F35	Feb 98 → Sep 09	50	20	B1	48	19	B1	C30	C12	RD
ASTRA G CC	F48, F08	Feb 98 → Jan 05	50	20	B1	48	19	B1	C40	C16	RD
ASTRA G Coupe	F07	Mrz 00 → Feb 05	50	20	B1	48	19	B1	C40	C16	RD
ASTRA G Stufenheck	F69	Sep 98 → Jul 09	50	20	B1	48	19	B1			
ASTRA H	L48	Mrz 04 → Mrz 10	56	22	SL	45	18	SL	C30	C12	RD
ASTRA H Caravan	L35	Aug 04 → Mrz 10	56	22	SL	45	18	SL	C30	C12	RD
ASTRA H GTC	L08	Mrz 05 → Jul 10	56	22	SL	45	18	SL			
ASTRA H Stufenheck	L69	Feb 07 → Mrz 10	56	22	SL	45	18	SL			

A
B
C
D
E
F
G
H
I
J
K
L
M
N
O
P
Q
R
S
T
U
V
W
X
Y
Z

Automarke / car-type марка автомобиля		Baujahr year of manufacture год выпуска	Fahrer / Driver водитель			Beifahrer Passenger пассажир			Heck / Rear заднее стекло C=CLASSIC / F=FLAT		
			cm	inch	Ad	cm	inch	Ad	cm	inch	Ad
... OPEL											
ASTRA H TwinTop	L67	Sep 05 → Okt 10	56	22	SL	45	18	SL			
ASTRA J		Dez 09 →	65	26	TL ^{BF}	60	24	TL ^{BF}	C30	C12	RA
ASTRA J GTC		Okt 11 →	70	28	TL ^{BF}	65	26	TL ^{BF}	C30	C12	RA
ASTRA J Sports Tourer		Okt 10 →	65	26	TL ^{BF}	60	24	TL ^{BF}	C30	C12	RA
ASTRA J Stufenheck		Sep 12 →	65	26	TL ^{BF}	60	24	TL ^{BF}			
ASTRA K		Sep 15 →	70	28	TL ^{BF}	65	24	TL ^{BF}	C25	C10	RA
ASTRA K Sports Tourer		Apr 16 →	70	28	TL ^{BF}	65	24	TL ^{BF}	C25	C10	RA
CALIBRA A	85	Jun 90 → Mrz 97	48	19	B1	48	19	B1			
CAMPO	TF	Sep 91 → Aug 97	45	18	B1	45	18	B1			
CASCADA	W13	Mrz 13 →	65	26	TL	60	24	TL			
COMBO C		Okt 01 → Jan 11	50	20	B1	43	17	B1			
COMBO D	X12	Feb 12 →	60	24	TL	40	16	TL	F38	F15	R1
COMBO E		Feb 18 →	65	26	TL	43	17	TL			
CORSA B		Mrz 93 → Sep 00	45	18	B1	45	18	B1	C30	C12	RD+
CORSA C		Sep 00 → Sep 06	50	20	B1	45	18	B1	C40	C16	RD
CORSA D		Jul 06 → Okt 14	65	26	PT	40	16	PT	C30	C12	RD
CORSA E		Okt 14 →	65	26	PT	40	16	PT	C30	C12	RD
CORSA F		Sep 19 →	60	24	TL	40	16	TL	C30	C12	RD
Crossland X		Jan 17 →	65	26	ST	40	16	ST	C25	C10	RD
FRONTERA A		Mrz 92 → Aug 98	48	19	B1	48	19	B1			
FRONTERA B		Okt 98 → Sep 04	48	19	B1	48	19	B1			
GRANDLAND X		Okt 17 →	65	26	TL	43	17	TL	C25	C10	RD
GT		Jun 07 → Dez 09	56	22	B1	40	16	B1			
INSIGNIA A		Sep 08 →	60	24	B1	45	18	B1	50	20	PT
INSIGNIA A Sports Tourer		Feb 09 →	60	24	B1	45	18	B1	C30	C12	RD
INSIGNIA B Grand Sport		Mrz 17 →	60	24	B1	50	20	B1	50	20	TL
INSIGNIA B Sports Tourer		Mrz 17 →	60	24	B1	50	20	B1	C25	C10	RA
KARL		Mai 15 →	60	24	B1	35	14	B1	C25	C10	RA
MERIVA		Mai 03 → Mai 10	60	24	B1	60	24	B1	C40	C16	RD
MERIVA B		Jun 10 →	70	28	TL ^{BF}	58	23	TL ^{BF}	C40	C16	RD

SPZIFIKATION FÜR FAHRZEUGE / Specification for cars • Спецификация автомобилей

Autemarke / car-type марка автомобиля		Baujahr year of manufacture год выпуска	Fahrer / Driver водитель			Beifahrer Passenger пассажир			Heck / Rear заднее стекло C=CLASSIC/F=FLAT		
			cm	inch	Ad	cm	inch	Ad	cm	inch	Ad
MOKKA		Sep 12 →	65	26	TL	35	14	TL	C25	C10	RD
MOKKA X		Mai 17 →	65	26	TL	35	14	TL			
MONTEREY A	UBS	Sep 91 → Dez 97	50	20	B1	50	20	B1	38	15	B1
MONTEREY B		Jul 98 → Aug 99	50	20	B1	50	20	B1			
MOVANO B		Mai 10 →	65	26	B1	65	26	B1			
OMEGA B		Mrz 94 → Jul 03	60	24	B1	48	19	B1			
OMEGA B Caravan		Mrz 94 → Jul 03	60	24	B1	48	19	B1	C30	C12	RD+
SIGNUM		Mai 03 → Sep 08	60	24	B1	48	19	B1			
SPEEDSTER Cabrio		Sep 00 → Sep 06	60	24	B1						
SINTRA		Nov 96 → Apr 99	60	24	B1	60	24	B1			
TIGRA		Sep 94 → Aug 99	45	18	B1	45	18	B1			
TIGRA TwinTop		Jun 04 → Dez 09	50	20	B1	45	18	B1			
VECTRA B		Okt 95 → Jul 03	48	19	B1	48	19	B1			
VECTRA B Caravan		Nov 96 → Jul 02	48	19	B1	48	19	B1			
VECTRA C		Jun 04 → Okt 08	60	24	B1	48	19	B1			
VECTRA C Caravan		Okt 03 → Okt 08	60	24	B1	48	19	B1			
VECTRA C GTS		Aug 02 → Okt 08	60	24	B1	48	19	B1			
VIVARO Combi	J7	Aug 01 →	60	24	B1	53	21	B1	C40	C16	RA
		Jun 14 →	65	26	B1	48	19	B1	40	16	PT
VIVARO Kasten	F7	Aug 01 →	60	24	B1	53	21	B1	C40	C16	RA
		Jun 14 →	65	26	TL	48	19	TL	40	16	PT
VIVARO Pritsche/Fahrgestell	E7	Jan 06 →	60	24	B1	53	21	B1			
ZAFIRA A	F75	Apr 99 → Jun 05	60	24	B1	60	24	B1	C40	C16	RD+
ZAFIRA B	A05	Jul 05 →	70	28	PT	56	22	PT	C35	C14	RD
ZAFIRA LIFE		Mrz 19 →	65	26	BL	50	20	BL	C30	C12	RD
		Mrz 19 →	65	26	BL	50	20	BL	C35	C14	RD
ZAFIRA TOURER C	P12	Jan 12 →	81	32	TL ^{BF}	70	28	TL ^{BF}	C35	C14	RA
PERODUA											
NIPPA / Kancil		2000 →	45	18	B1	40	16	B1			
KENARI		2000 →	48	19	B1	43	17	B1			
PEUGEOT											
106	1A, 1C	Sep 91 → Apr 96	50	20	B1	45	18	B1	C40	C16	RD+
106 II		Mai 96 → Sep 99	50	20	B1	45	18	B1	C40	C16	RD+
		Okt 99 → Mai 05	50	20	B1	45	18	B1	C35	C14	RD
107	PM, PN	Jun 05 → Mai 14	65	26	B1				C30	C12	RD
206 CC	2D	Sep 00 → Mrz 07	65	26	B1	40	16	B1			

A
B
C
D
E
F
G
H
I
J
K
L
M
N
O
P
Q
R
S
T
U
V
W
X
Y
Z

Automarke / car-type марка автомобиля	Baujahr year of manufacture год выпуска	Fahrer / Driver водитель			Beifahrer Passenger пассажир			Heck / Rear заднее стекло C=CLASSIC / F=FLAT			
		cm	inch	Ad	cm	inch	Ad	cm	inch	Ad	
... PEUGEOT											
206 Schrägheck	2A/C	Sep 98 → Feb 09	65	26	B1	40	16	B1	C35	C14	RD
206 Stufenheck		Mrz 07 → Dez 10	65	26	B1	40	16	B1			
206 SW	2E/K	Jul 02 → Dez 06	65	26	B1	40	16	B1	C35	C14	RD
206+	T3E	Mrz 09 →	65	26	B1	40	16	B1	C35	C14	RD
207	WA, WC	Mai 06 → Apr 12	65	26	SL	43	17	SL	C40	C16	RD
207 CC	WD	Mrz 07 →	65	26	SL	43	17	SL			
207 SW	WK	Jun 07 →	65	26	SL	43	17	SL	C30	C12	RD
208		Mrz 12 →	65	26	TL	40	16	TL	C35	C14	RD
208 II / e-208	UB, UP, UW, UJ	Jun 19 →	60	24	TL	40	16	TL	C30	C12	RD
306	7B, N3, N5	Jun 94 → Mai 01	56	22	B1	50	20	B1			
306 Break	7E, N3, N5	Mai 97 → Mrz 02	56	22	B1	50	20	B1			
306 Cabriolet	7D, N3, N5	Apr 96 → Apr 02	56	22	B1	50	20	B1			
306 Schrägheck	7A, 7C, N3, N5	Mai 93 → Mai 01	56	22	B1	50	20	B1	C40	C16	RD
307	3A/C	Aug 00 → Apr 06	70	28	B1	65	26	B1	C35	C14	RD
		Okt 04 → Aug 07	70	28	PT	65	26	PT	C35	C14	RD
307 Break	3E	Mrz 02 → Mai 05	70	28	B1	65	26	B1	C35	C14	RD
		Okt 04 → Mai 08	70	28	PT	65	26	PT	C35	C14	RD
307 CC	3B	Okt 04 → Mrz 09	70	28	PT	65	26	PT			
307 SW	3H	Mrz 02 → Mai 05	70	28	B1	65	26	B1	C35	C14	RD
		Okt 04 → Mai 08	70	28	PT	65	26	PT	C35	C14	RD
308	4A, 4C	Jul 08 → Jun 13	76	30	TL	65	26	TL	C30	C12	RD
	T9	Jul 13 →	60	24	TL	45	18	TL	C25	C10	RD
308 CC		Jun 09 →	70	28	TL	65	26	TL			
308 SW		Mai 08 → Jan 14	76	30	TL	65	26	TL	C30	C12	RD
	T9	Jan 14 →	60	24	TL	45	18	TL	C25	C10	RD
406	8B	Nov 95 → Jun 04	60	24	B1	56	22	B1			
406 Break	8E/F	Okt 96 → Jun 04	60	24	B1	56	22	B1	45	18	B1
406 Coupe	8C	Mrz 97 → Dez 04	65	26	B1	50	20	B1			
407	6D	Mai 04 → Feb 11	70	28	SL	70	28	SL			
407 Coupe	6C	Okt 05 → Dez 11	70	28	SL	70	28	SL			
407 SW	6E	Mai 04 → Feb 11	70	28	SL	70	28	SL	C30	C12	RD

Spezifikation für Fahrzeuge / Specification for cars • Спецификация автомобилей

Automarke / car-type марка автомобиля		Baujahr year of manufacture год выпуска	Fahrer / Driver водитель			Beifahrer Passenger пассажир			Heck / Rear заднее стекло C=CLASSIC/F=FLAT		
			cm	inch	Ad	cm	inch	Ad	cm	inch	Ad
508		Nov 10 →	65	26	TL	65	26	TL			
508 SW		Nov 10 →	65	26	TL	65	26	TL	C30	C12	RD
806	221	Jun 94 → Aug 02	65	26	B1	50	20	B1			
	E	Aug 05 → Mai 10	65	26	B1	65	26	B1			
1007	KM	Apr 05 → Feb 11	60	24	B1	45	18	B1	C30	C12	RD
2008		Mrz 13 →	65	26	TL	40	16	TL	C30	C12	RD
2008 / e-2008	U	Aug 19 →	60	24	TL	40	16	TL	C30	C12	RD
3008	T8	Jun 09 → Dez 16	81	32	TL ^{BF}	65	26	TL ^{BF}	C30	C12	RD
	P84	Jul 16 →	65	26	ST	43	17	ST			
4007	GP	Sep 07 →	60	24	B1	53	21	B1	C25	C10	RD+
4008		Mai 12 →	60	24	B1	53	21	B1	C25	C10	RD+
5008	T8	Sep 09 →	81	32	TL ^{BF}	65	26	TL ^{BF}	C30	C12	RD
5008 II	P87	Jan 17 →	65	26	ST	43	17	ST			
BIPPER	AA	Feb 08 →	65	26	BL	48	19	BL			
BIPPER Tepee		Apr 08 →	65	26	BL	48	19	BL			
BOXER		Mrz 94 → Feb 02	56	22	B1	53	21	B1			
		Apr 02 → Mai 06	56	22	B1	53	21	B1			
		Jun 06 →	65	26	TL	53	21	TL			
EXPERT		Feb 96 → Jan 07	65	26	B1	50	20	B1			
		Feb 07 →	65	26	B1	50	20	B1	C40	C16	RD+
	V	Apr 16 →	65	26	BL	48	19	BL			
ION		2010 →	70	28	B1						
J5		Okt 90 → Feb 94	50	20	B1	50	20	B1			
PARTNER		Jul 96 → Aug 02	56	22	B1	53	21	B1			
		Mai 08 →	65	26	TL	40	16	TL	C35	C14	RD
RIFTER		Sep 18 →	60	24	TL	43	17	TL	C35	C14	RD
TRAVELLER Heckklappe		Apr 16 →	65	26	BL	48	19	BL	C35	C14	RD
TRAVELLER Hecktüren		Apr 16 →	65	26	BL	48	19	BL	C25	C10	RD
RCZ		Mrz 10 →	65	26	TL ^{BF}	65	26	TL ^{BF}			
PORSCHE											
911	993	Okt 93 → Sep 97	38	15	B1	38	15	B1	C35	C14	RD+
	996	Sep 98 → Aug 05	56	22	B1	50	20	B1			
	997	Aug 04 → Dez 12	56	22	B1	50	20	B1	56	22	B1
	991	Dez 11 →	53	21	ST	56	22	ST			
911 Cabriolet	996	Feb 98 → Aug 05	56	22	B1	50	20	B1			

A
B
C
D
E
F
G
H
I
J
K
L
M
N
O
P
Q
R
S
T
U
V
W
X
Y
Z

Automarke / car-type марка автомобиля	Baujahr year of manufacture год выпуска	Fahrer / Driver водитель			Beifahrer Passenger пассажир			Heck / Rear заднее стекло C=CLASSIC / F=FLAT			
		cm	inch	Ad	cm	inch	Ad	cm	inch	Ad	
... PORSCHE											
911 Cabriolet	997	Apr 05 → Dez 12	56	22	B1	50	20	B1			
	991	Mrz 12 →	53	21	ST	56	22	ST			
911 Targa	996	Dez 01 → Jul 04	56	22	B1	50	20	B1	56	22	B1
	997	Aug 06 → Sep 12	56	22	B1	50	20	B1	56	22	B1
	991	Mai 14 →	53	21	ST	56	22	ST			
968		Jun 91 → Nov 95	45	18	B1	45	18	B1			
968 Cabrio		Jun 91 → Nov 95	45	18	B1	45	18	B1			
BOXSTER	986	Okt 96 → Aug 04	56	22	B1	50	20	B1			
	987	Nov 04 → Dez 11	56	22	B1	50	20	B1			
	981	Apr 12 →	53	21	ST	56	22	ST			
CARRERA GT		Jul 03 → Dez 06	56	22	B1	56	22	B1			
CAYENNE	955	Feb 07 → Aug 10	65	26	SL	65	26	SL			
		Sep 10 → Aug 14	65	26	SL	65	26	SL			
CAYMAN	987	Nov 05 → Dez 12	56	22	B1	50	20	B1			
	981	Mrz 13 →	53	21	ST	56	22	ST			
MACAN		Mrz 14 →	60	24	ST	50	20	ST			
PANAMERA		Sep 09 → Aug 13	60	24	B1	53	21	B1			
		Okt 13 →	60	24	ST	53	21	ST			
PROTON											
GEN-2		Jun 04 →	56	22	B1	45	18	B1			
IMPIAN		Sep 01 →	50	20	B1	43	17	B1			
JUMPBUCK Pickup		Mai 02 →	50	20	B1	43	17	B1			
PERSONA 300		Mrz 96 →	50	20	B1	43	17	B1			
PERSONA 400 Hatchback		Jan 94 →	50	20	B1	43	17	B1			
PERSONA 400 Saloon		Jan 94 →	50	20	B1	43	17	B1			
SAGA Hatchback		Aug 92 →	40	16	B1	40	16	B1			
SAGA Saloon		Aug 92 →	40	16	B1	40	16	B1			
SATRIA	C9_M	Apr 96 →	50	20	B1	43	17	B1			
SATRIA Neo		Feb 07 →	53	21	B1	45	18	B1			
SAVVY		Okt 05 →	53	21	B1	43	17	B1			
WIRA Hatchback		Jan 00 →	50	20	B1	43	17	B1			
WIRA Saloon		Jan 00 →	50	20	B1	43	17	B1			
RENAULT											
19 I Cabrio	D53	Jul 91 → Apr 92	50	20	B1	50	20	B1			

Spezifikation für Fahrzeuge / Specification for cars • Спецификация автомобилей

Autemarke / car-type марка автомобиля		Baujahr year of manufacture год выпуска	Fahrer / Driver водитель			Beifahrer Passenger пассажир			Heck / Rear заднее стекло C=CLASSIC/F=FLAT		
			cm	inch	Ad	cm	inch	Ad	cm	inch	Ad
19 II Cabrio	D53, 853	Apr 92 → Jun 96	50	20	B1	50	20	B1			
19 II Chamade	L53	Apr 92 → Dez 95	50	20	B1	50	20	B1			
19 II Hatchback	B/C53	Apr 92 → Dez 95	50	20	B1	50	20	B1			
CAPTUR	J5	Jun 13 → Feb 16	65	26	BL	35	14	BL	C30	C12	RD
		Mrz 16 →	65	26	TLB	35	14	TLB	C30	C12	RD
CLIO I		Mrz 94 → Sep 98	50	20	B1	50	20	B1			
CLIO II	BB0/1/2, CB0/1/2	Sep 98 → Jun 09	53	21	B1	45	18	B1	C30	C12	RD
CLIO II Kasten	SB0/1/2	Jun 01 → Okt 07	53	21	B1	45	18	B1	C30	C12	RD
CLIO III	BR0/1, CR0/1	Jun 05 →	60	24	BL	40	16	BL	C30	C12	RD
CLIO III Grandtour	KR0/1	Feb 08 →	60	24	BL	40	16	BL	F25	F10	R4
CLIO IV		Nov 12 →	65	26	BL	35	14	BL	F25	F10	R4
CLIO IV Grandtour		Jan 13 →	65	26	BL	35	14	BL	F25	F10	R4
ESPACE IV	JK0/1	Nov 02 →	76	30	SL	70	28	SL	C35	C14	RD
FLUENCE	L30	Feb 10 →	60	24	BL	40	16	BL			
GRAND KANGOO	KW0	Feb 08 →	56	22	B1	53	21	B1			
		Feb 08 →	60	24	BL	56	22	BL			
GRAND MODUS	F/JP	Dez 04 →	70	28	SL	60	24	SL	C25	C10	RD+
GRAND SCÉNIC II	JM	Mai 03 → Nov 04	65	26	CL	56	22	CL			
		Dez 04 → Apr 09	65	26	BL	56	22	BL			
GRAND SCÉNIC III	JZ	Mai 09 →	70	28	BL	65	26	BL			
KADJAR	HL	Jun 15 →	65	26	B1	43	17	B1			
KANGOO	KC	Okt 97 → Dez 07	50	20	B1	50	20	B1	C35	C14	RD+
		Feb 08 →	56	22	B1	53	21	B1			
	KW0	Feb 08 →	60	24	BL	56	22	BL			
KANGOO BE BOP	KW0	Feb 09 →	56	22	B1	53	21	B1			
		Feb 09 →	60	24	BL	56	22	BL			
KANGOO Express	FW0	Feb 08 →	56	22	B1	53	21	B1			
		Feb 08 →	60	24	BL	56	22	BL			
KANGOO Rapid	FC	Okt 97 → Dez 07	50	20	B1	50	20	B1	C35	C14	RD+
KOLEOS	HY	Sep 08 →	60	24	PT	48	19	PT			
LAGUNA	B56	Jan 94 → Feb 01	60	24	B1	48	19	B1			
LAGUNA Coupe	DT0/1	Sep 08 →	65	26	BL	40	16	BL			
LAGUNA II	BG0	Mrz 01 → Sep 07	60	24	B1	50	20	B1			
LAGUNA II Grandtour	KG	Mrz 01 → Sep 07	60	24	B1	50	20	B1	C35	C14	RD+

A
B
C
D
E
F
G
H
I
J
K
L
M
N
O
P
Q
R
S
T
U
V
W
X
Y
Z

Automarke / car-type марка автомобиля	Baujahr year of manufacture год выпуска	Fahrer / Driver водитель			Beifahrer Passenger пассажир			Heck / Rear заднее стекло C=CLASSIC / F=FLAT			
		cm	inch	Ad	cm	inch	Ad	cm	inch	Ad	
... RENAULT											
LAGUNA III	BT0/1	Okt 07 → Dez 15	65	26	BL	40	16	BL			
LAGUNA III Grandtour	KT0/1	Okt 07 → Dez 15	65	26	BL	40	16	BL	C35	C14	RE
LATITUDE	L70	Feb 11 →	60	24	B1	40	16	B1			
MASTER III	FV	Feb 10 →	65	26	B1	65	26	B1			
MEGANE I	BA	Jan 96 → Okt 02	56	22	B1	50	20	B1	50	20	B1
MEGANE I Cabriolet	EA	Mrz 99 → Aug 03	56	22	B1	50	20	B1			
MEGANE I Classic	LA	Sep 96 → Aug 03	56	22	B1	50	20	B1			
MEGANE I Coach	DA	Mrz 99 → Okt 02	56	22	B1	50	20	B1			
MEGANE I Grandtour	KA	Mrz 99 → Aug 03	56	22	B1	50	20	B1	C35	C14	RD+
MEGANE II	BM, CM	Nov 02 → Jan 06	60	24	B1	45	18	B1			
		Feb 06 → Okt 08	60	24	BL	45	18	BL			
MEGANE II Coupé-Cabriolet	EM	Okt 03 → Jan 06	60	24	B1	45	18	B1			
		Feb 06 → Mrz 10	60	24	BL	45	18	BL			
MEGANE II Grandtour	KM	Okt 03 → Jan 06	60	24	B1	45	18	B1	C25	C12	RD+
		Feb 06 → Mai 09	60	24	BL	45	18	BL	C25	C12	RD+
MEGANE II Stufenheck	LM	Okt 03 → Jan 06	60	24	B1	45	18	B1			
		Feb 06 → Okt 09	60	24	BL	45	18	BL			
MEGANE III Coupe	DZ	Jan 09 →	60	24	BL	40	16	BL	C35	C14	RD
MEGANE III Grandtour	KZ	Jun 09 →	60	24	BL	40	16	BL	C35	C14	RE
MEGANE III Schrägheck	BZ	Nov 08 →	60	24	BL	40	16	BL	C35	C14	RE
MEGANE IV Grand Coupe	LV	Feb 17 →	60	24	BL	45	18	BL			
MEGANE IV Grandtour	K9	Apr 16 →	60	24	BL	45	18	BL	C25	C12	RD
MEGANE IV Schrägheck	B9	Dez 15 →	60	24	BL	45	18	BL	C25	C12	RD
MEGANE CC	EZ	Okt 10 →	60	24	BL	40	16	BL			
MEGANE Scenic	JA	Jan 97 → Sep 99	60	24	B1	40	16	B1	C40	C16	RD+
MODUS	F/JJP	Dez 04 →	70	28	SL	60	24	SL	C25	C10	RD+
SCÉNIC I	JA	Sep 99 → Apr 03	60	24	B1	40	16	B1	C40	C16	RD+

Spezifikation für Fahrzeuge / Specification for cars • Спецификация автомобилей

Automarke / car-type марка автомобиля		Baujahr year of manufacture год выпуска	Fahrer / Driver водитель			Beifahrer Passenger пассажир			Heck / Rear заднее стекло C=CLASSIC/F=FLAT		
			cm	inch	Ad	cm	inch	Ad	cm	inch	Ad
SCÉNIC II	JM	Mrz 03 → Nov 04	65	26	CL	56	22	CL			
		Dez 04 → Apr 09	65	26	BL	56	22	BL			
SCÉNIC III	JZ	Mai 09 →	70	28	BL	65	26	BL	C25	C10	RD
SCÉNIC IV	J9	Nov 16 →	81	32	TL ^{BF}	70	28	TL ^{BF}			
TALISMAN	LP	Dez 15 →	60	24	BL	45	18	BL			
TALISMAN Grandtour	KP	Mrz 16 →	60	24	BL	45	18	BL			
THALIA I	LB0/1/2	Aug 00 → Okt 07	53	21	B1	45	18	B1			
THALIA II	LU1/2	Okt 08 →	60	24	BL	40	16	BL			
TRAFIC II Bus	JL	Jun 01 →	60	24	B1	53	21	B1			
TRAFIC II Kasten	FL	Mai 03 →	60	24	B1	53	21	B1			
TRAFIC II Pritsche/Fahrgestell	EL	Jun 02 →	60	24	B1	53	21	B1			
TRAFIC III Bus		Mai 14 →	65	26	B1	48	19	B1			
TRAFIC III Kasten		Mai 14 →	65	26	B1	48	19	B1			
TWINGO I	C06	Mrz 93 → Mai 07	65	26	B1				C30	C12	RD
TWINGO II	CN0	Apr 07 →	60	24	TL	40	16	TL	C30	C12	RD
TWINGO III	BCM	Sep 14 →	50	20	BL	35	14	BL	C30	C12	RD
TWIZY	MAM	Apr 12 →	45	18	B1						
VEL SATIS	BJ0	Jun 02 → Dez 09	70	28	SL	65	26	SL			
WIND	E4M	Jul 10 →	60	24	TL	40	16	TL			
ZOE		Jun 12 →	60	24	TL	35	14	TL			
ROLLS ROYCE											
CORNICHE		2000 →	56	22	B1	56	22	B1			
ROVER											
25	RF	Feb 00 → Mai 05	45	18	B1	45	18	B1	45	18	B1
45	RT	Feb 00 → Mai 05	50	20	B1	45	18	B1	45	18	B1
45 Stufenheck	RT	Feb 00 → Mai 05	50	20	B1	45	18	B1			
75	RJ	Feb 99 → Mai 05	56	22	B1	53	21	B1			
75 Tourer	RJ	Aug 01 → Mai 05	56	22	B1	53	21	B1	C35	C14	RE
100 Cabrio		Apr 94 → Okt 98	40	16	B1	40	16	B1			
100 METRO	XP	Mrz 90 → Dez 98	40	16	B1	40	16	B1			
200 Coupe	XW	Okt 92 → Jun 99	45	18	B1	45	18	B1			
200 Hatchback	RF	Nov 95 → Mrz 00	45	18	B1	45	18	B1			
400	RT	Mai 95 → Mrz 02	50	20	B1	45	18	B1			
	XW	Apr 90 → Apr 95	45	18	B1	45	18	B1			
400 Cabriolet	XW	Apr 90 → Nov 99	45	18	B1	45	18	B1			

A
B
C
D
E
F
G
H
I
J
K
L
M
N
O
P
Q
R
S
T
U
V
W
X
Y
Z

Automarke / car-type марка автомобиля		Baujahr year of manufacture год выпуска	Fahrer / Driver водитель			Beifahrer Passenger пассажир			Heck / Rear заднее стекло C=CLASSIC / F=FLAT		
			cm	inch	Ad	cm	inch	Ad	cm	inch	Ad
... ROVER											
400 Hatchback	RT	Mai 95 → Mrz 02	50	20	B1	45	18	B1			
400 Tourer	XW	Sep 93 → Nov 98	45	18	B1	45	18	B1			
600	RH	Aug 93 → Feb 99	53	21	B1	50	20	B1			
800 Coupe		Aug 92 → Feb 99	50	20	B1	50	20	B1			
CITYROVER		Jan 04 → Jun 05	50	20	B1	50	20	B1			
COUPE		Mrz 96 → Nov 99	45	18	B1	45	18	B1			
MAESTRO		Sep 90 → Jan 95	50	20	B1	50	20	B1			
MINI MK I		Jan 91 → Sep 00	28	11	B1	28	11	B1			
MINI MK I Cabrio		Sep 92 → Sep 00	28	11	B1	28	11	B1			
STREETWISE		Sep 03 → Mai 05	45	18	B1	45	18	B1	C40	C16	RD
SAAB											
9-3	YS3D	Mrz 98 → Sep 02	53	21	B1	53	21	B1			
	YS3F	Sep 02 → Jan 08	56	22	B1	56	22	B1			
		Sep 07 → Jun 12	60	24	PT	58	23	PT			
9-3 Cabriolet	YS3D	Mrz 98 → Aug 03	53	21	B1	53	21	B1			
	YS3F	Aug 03 → Aug 07	56	22	B1	56	22	B1			
		Sep 07 → Jun 12	60	24	PT	58	23	PT			
9-3 Kombi		Mrz 05 → Aug 07	56	22	B1	56	22	B1	C30	C12	RD
		Sep 07 → Jun 12	60	24	PT	58	23	PT	C30	C12	RD
9-3X		Mrz 10 → Jun 12	60	24	PT	58	23	PT			
9-5	YS3E	Sep 97 → Jul 07	56	22	B1	56	22	B1			
		Aug 07 → Feb 10	60	24	BL	58	23	BL			
9-5 Kombi	YS3E	Jun 99 → Jul 07	56	22	B1	56	22	B1			
		Aug 07 → Feb 10	60	24	BL	58	23	BL			
9-7X 4.2		Dez 05 →	60	24	B1	56	22	B1			
9-7X 5.3		Dez 05 →	60	24	B1	56	22	B1			
900 II Cabrio		Dez 93 → Feb 98	53	21	B1	53	21	B1			
900 II Coupe		Dez 93 → Feb 98	53	21	B1	53	21	B1			
900 II Hatchback		Jul 93 → Feb 98	53	21	B1	53	21	B1			
9000 Saloon		Jan 92 → Dez 98	53	21	B1	53	21	B1			
SEAT											
ALHAMBRA	7V8, 7V9	Mai 97 → Jun 01	70	28	TR	65	26	TR	C40	C16	RD+
		Jul 01 → Mrz 10	70	28	SL	70	28	SL	C40	C16	RD+
	710	Mai 10 →	70	28	ST	40	16	ST	F35	F14	R2
	711	Mai 15 →	70	28	ST	40	16	ST	F35	F14	R2
ARONA	KJ7	Jul 17 →	60	24	ST	45	18	ST	F25	F10	R2

Automarke / car-type марка автомобиля		Baujahr year of manufacture год выпуска	Fahrer / Driver водитель			Beifahrer Passenger пассажир			Heck / Rear заднее стекло C=CLASSIC/F=FLAT		
			cm	inch	Ad	cm	inch	Ad	cm	inch	Ad
AROSA	6H	Mrz 99 → Jun 04	53	21	B1	48	19	B1			
ATECA	KH7	Mai 16 →	65	26	ST	45	18	ST	F30	F12	R2
CORDOBA	6K1, 6K2	Sep 93 → Okt 99	53	21	B1	48	19	B1			
	6L2	Sep 02 → Jan 06	53	21	B1	48	19	B1			
		Feb 06 → Nov 09	53	21	TL	48	19	TL			
CORDOBA Vario	6K5	Jun 97 → Jun 99	53	21	B1	48	19	B1			
EXEO	3R2	Dez 08 → Mai 13	56	22	CL	53	21	CL			
EXEO ST	3R5	Jun 09 → Mai 13	56	22	CL	53	21	CL	F30	F12	R3
IBIZA II	6K1	Sep 93 → Aug 99	53	21	B1	48	19	B1			
IBIZA III	6L1	Feb 02 → Sep 05	53	21	B1	48	19	B1	C30	C12	RD+
IBIZA IV	6J5	Mrz 08 → Aug 11	60	24	TL	40	16	TL			
IBIZA IV SPORTCOUPE	6J1	Jul 08 → Aug 11	60	24	TL	40	16	TL			
IBIZA IV ST	6J8	Mrz 10 → Aug 11	60	24	TL	40	16	TL			
IBIZA V	KJ1	Jan 17 →	65	26	ST	43	17	ST	F30	F12	R2
INCA	6K9	Nov 95 → Jun 03	53	21	B1	45	18	B1	45	18	B1
LEON	1M1	Nov 99 → Jun 06	53	21	B1	48	19	B1	C40	C16	RD+
	1P1	Mai 05 → Feb 09	65	26	PT	65	26	PT	C25	C10	RD+
		Mrz 09 → Dez 12	65	26	PT	65	26	PT	F25	F10	R3
	5F1	Sep 12 →	65	26	ST	40	16	ST	F30	F12	R2
LEON SPORTCOUPE	5F5	Jan 13 →	65	26	ST	40	16	ST	F40	F16	R2
LEON ST	5F8	Aug 13 →	65	26	ST	40	16	ST	F30	F12	R2
Mii / Mii Electric	KF1, KE1	Okt 11 →	60	24	ST	40	16	ST	F25	F10	R2
TARRACO	KN2	Sep 18 →	60	24	ST	56	22	ST	F38	F15	R2
TOLEDO I	1L	Mai 91 → Mrz 99	50	20	B1	50	20	B1			
TOLEDO II	1M2	Okt 98 → Jul 04	53	21	B1	48	19	B1			
TOLEDO III	5P2	Sep 04 → Mai 09	65	26	BLFT	65	26	BLFT	C25	C10	RD+
TOLEDO IV	KG3	Jul 12 → Apr 19	60	24	ST	40	16	ST	F40	F16	R2
SKODA											
CITIGO / E-CITIGO	NF1, NE1	Okt 11 →	60	24	ST	40	16	ST	F25	F10	R2
FABIA	6Y2	Aug 99 → Apr 07	53	21	B1	48	19	B1			
	5J2	Dez 06 → Mai 13	53	21	TL	53	21	TL	F30	F12	R3
		Jun 13 → Dez 14	53	21	TL	53	21	TL	F30	F12	R2
	NJ3	Aug 14 →	60	24	ST	40	16	ST	F35	F14	R2
FABIA Combi	6Y5	Dez 99 → Dez 07	53	21	B1	48	19	B1			
	5J5	Dez 06 → Mai 13	53	21	TL	53	21	TL	F40	F16	R3

A
B
C
D
E
F
G
H
I
J
K
L
M
N
O
P
Q
R
S
T
U
V
W
X
Y
Z

Automarke / car-type марка автомобиля	Baujahr year of manufacture год выпуска	Fahrer / Driver водитель			Beifahrer Passenger пассажир			Heck / Rear заднее стекло C=CLASSIC / F=FLAT			
		cm	inch	Ad	cm	inch	Ad	cm	inch	Ad	
... SKODA											
FABIA Combi	5J5	Jun 13 → Dez 14	53	21	TL	53	21	TL	F40	F16	R2
	NJ5	Okt 14 →	60	24	ST	40	16	ST	F35	F14	R2
FABIA Stufenheck	6Y3	Sep 99 → Dez 07	53	21	B1	48	19	B1			
FELICIA	6U1	Okt 94 → Jun 01	50	20	B1	50	20	B1	C40	C16	RD+
FELICIA Combi	6U5	Okt 94 → Jun 01	50	20	B1	50	20	B1	C40	C16	RD+
KAMIQ	NW4	Jul 19 →	65	26	ST	45	18	ST	F30	F12	R2
KAROQ	NU7	Jul 17 →	65	26	ST	45	18	ST	F35	F14	R2
KODIAQ	NS7	Mrz 17 →	60	24	ST	53	21	ST	F30	F12	R2
OCTAVIA I	1U2	Sep 96 → Okt 10	53	21	B1	48	19	B1			
OCTAVIA II	1Z3	Mai 04 → Jun 13	60	24	SL	48	19	SL	F40	F16	R3
OCTAVIA III	5E3	Nov 12 →	60	24	ST	45	18	ST	F40	F16	R2
OCTAVIA Combi I	1U5	Okt 96 → Dez 10	53	21	B1	48	19	B1	C35	C14	RD+
OCTAVIA Combi II	1Z5	Mai 04 → Jun 13	60	24	SL	48	19	SL	F40	F16	R3
OCTAVIA Combi III	5E5	Nov 12 →	60	24	ST	45	18	ST	F35	F14	R2
OCTAVIA IV	NX3	Jan 20 →	65	26	ST	45	19	ST			
OCTAVIA IV Combi	NX5	Nov 19 →	65	26	ST	45	19	ST	F35	F14	R2
Praktik	5J7	Mrz 07 → Mai 13	53	21	TL	53	21	TL	F30	F12	R3
		Jun 13 → Mai 15	53	21	TL	53	21	TL	F30	F12	R2
RAPID	NH3	Jul 12 → Dez 19	60	24	ST	40	16	ST	F40	F16	R2
RAPID Spaceback	NH1	Okt 13 → Dez 19	60	24	ST	40	16	ST	F40	F16	R2
ROOMSTER	5J	Mai 06 → Mai 13	53	21	TL	53	21	TL	F30	F12	R3
		Jun 13 → Mai 15	53	21	TL	53	21	TL	F30	F12	R2
SCALA		Sep 19 →	26	26	ST	45	18	ST	F35	F14	R2
SUPERB	3U4	Dez 01 → Okt 04	53	21	SL	50	20	SL			
		Nov 04 → Mrz 08	53	21	B1	50	20	B1			
		Mrz 08 → Mai 15	60	24	TL	45	18	TL			
	3V3	Mai 15 →	65	26	ST	45	18	ST	F40	F16	R2
SUPERB Kombi	3T5	Mrz 09 → Mai 15	60	24	TL	45	18	TL	F40	F16	R2
	3V5	Mai 15 →	65	26	ST	45	18	ST	F40	F16	R2
YETI	5L	Mai 09 → Dez 17	60	24	TL	48	19	TL	F25	F10	R2
SMART											
CABRIO	450	Jan 01 → Jan 04	53	21	B1	53	21	B1			
CITY-COUBE	450	Jan 01 → Jan 04	53	21	B1	53	21	B1			
FORFOUR	454	Jan 04 → Jun 06	65	26	B1	45	18	B1	C35	C14	RE
	453	Nov 14 →	50	20	BL	35	14	BL			
FORTWO Cabrio	450	Feb 04 → Jan 07	53	21	B1	53	21	B1			

Spezifikation für Fahrzeuge / Specification for cars • Спецификация автомобилей

Autemarke / car-type марка автомобиля		Baujahr year of manufacture год выпуска	Fahrer / Driver водитель			Beifahrer Passenger пассажир			Heck / Rear заднее стекло C=CLASSIC/F=FLAT		
			cm	inch	Ad	cm	inch	Ad	cm	inch	Ad
FORTWO Cabrio	451	Jan 07 →	60	24	PT	56	22	PT			
FORTWO Coupe	451	Jan 07 →	60	24	PT	56	22	PT			
	453	Nov 14 →	50	20	BL	35	14	BL			
FORTWO EQ	453, 491	Mai 17 →	50	20	BL	35	14	BL			
ROADSTER	452	Apr 03 → Nov 05	50	20	B1	45	18	B1			
ROADSTER Coupe	452	Apr 03 → Nov 05	50	20	B1	45	18	B1			
SSANGYONG											
ACTYON I		Sep 06 →	56	22	B1	48	19	B1			
ACTYON SPORTS I	OJ	Apr 07 →	56	22	B1	48	19	B1			
ACTYON SPORTS II		Okt 12 →	56	22	B1	48	19	B1			
KORANDO	KJ	Mai 97 → Dez 05	45	18	B1	45	18	B1			
		Feb 12 →	60	24	B1	40	16	B1	C35	C14	RD+
KORANDO Cabrio	KJ	Nov 97 → Dez 05	45	18	B1	45	18	B1			
KYRON		Mai 05 →	56	22	B1	48	19	B1			
MUSSO	FJ	Okt 95 → Dez 05	50	20	B1	45	18	B1	C30	C12	RD+
MUSSO SPORTS		Aug 04 →	50	20	B1	45	18	B1	C30	C12	RD+
REXTON	GAB	Sep 02 →	50	20	B1	50	20	B1	C30	C12	RD+
REXTON W		Jul 12 →	50	20	B1	50	20	B1			
RODIUS		Mai 05 →	60	24	B1	45	18	B1	C30	C12	RD+
		Jul 13 →	60	24	B1	45	18	B1	C30	C12	RD+
SUBARU											
BRZ 2.0		Jun 12 →	56	22	B1	50	20	B1			
FORESTER	SF	Jun 98 → Mai 02	53	21	B1	48	19	B1	C35	C14	RD+
	SG	Sep 02 → Mai 05	53	21	B1	48	19	B1	C35	C14	RD+
	SH	Sep 05 →	60	24	B1	45	18	B1	C35	C14	RD+
	SJ	Mirz 13 →	65	26	B1	40	16	B1	C35	C14	RD+
IMPREZA Coupe	GFC	Dez 96 → Sep 00	53	21	B1	45	18	B1			
IMPREZA Kombi	GF	Jan 93 → Sep 00	53	21	B1	45	18	B1	C35	C14	RD+
IMPREZA Schrägheck	G3, GH, GR	Jan 08 → Jan 14	60	24	B1	40	16	B1	C40	C16	RD+
	GP	Jun 12 →	65	26	B1	40	16	B1	C35	C14	RB
IMPREZA Schrägheck - 2.5 WRX		Sep 05 → Jun 07	56	22	B1	40	16	B1			

A
B
C
D
E
F
G
H
I
J
K
L
M
N
O
P
Q
R
S
T
U
V
W
X
Y
Z

Automarke / car-type марка автомобиля		Baujahr year of manufacture год выпуска	Fahrer / Driver водитель			Beifahrer Passenger пассажир			Heck / Rear заднее стекло C=CLASSIC / F=FLAT		
			cm	inch	Ad	cm	inch	Ad	cm	inch	Ad
... SUBARU											
IMPREZA Station Wagon	GD, GG	Dez 00 → Jun 07	56	22	B1	40	16	B1	C35	C14	RD+
IMPREZA Stufenheck	GC	Jan 93 → Sep 00	53	21	B1	45	18	B1			
	GD, GG	Dez 00 → Sep 11	56	22	B1	40	16	B1			
IMPREZA Stufenheck - 1.5 AWD	GD, GG	Mrz 08 → Sep 11	60	24	B1	40	16	B1			
JUSTY II	JMA, MS	Nov 95 → Nov 03	53	21	B1	45	18	B1	C35	C14	RD+
JUSTY III	G3X	Sep 03 → Dez 07	48	19	B1	45	18	B1			
JUSTY IV 1.0		Sep 07 → Dez 10	50	20	B1	40	16	B1	C35	C14	RA
LEGACY II	BD, BG	Sep 94 → Mrz 99	53	21	B1	48	19	B1			
LEGACY III	BE, BH	Okt 98 → Jun 03	56	22	B1	50	20	B1			
LEGACY III Station Wagon	BE, BH	Dez 98 → Jun 03	56	22	B1	50	20	B1			
LEGACY IV - 2.5 i	BL, BP	Sep 03 → Mai 09	60	24	B1	45	18	B1			
LEGACY IV Station Wagon	B13, BL, BP	Sep 03 → Mai 09	60	24	B1	45	18	B1	C35	C14	RB
LEGACY V	BM, BR	Sep 09 →	65	26	B1	45	18	B1			
LEGACY V Station Wagon	BM, BR	Sep 09 →	65	26	B1	45	18	B1			
LEGACY OUTBACK	BG	Jan 96 → Dez 99	53	21	B1	48	19	B1			
LIBERO Bus / Minivan	E10, E12	1994 → 2000	40	16	B1	40	16	B1			
OUTBACK	BE, BH	Okt 00 → Jun 03	56	22	B1	50	20	B1			
	BL, BP	Nov 03 → Sep 09	60	24	B1	45	18	B1	C35	C14	RB
	BM, BR	Sep 09 →	65	26	B1	45	18	B1	C35	C14	RB
SUMO Bus / Minivan	E10, E12	1994 → 2000	40	16	B1	40	16	B1			
TREZIA 1.3		Mrz 11 →	70	28	B1				C30	C12	RD+
TREZIA 1.4 D		Mrz 11 →	70	28	B1				C30	C12	RD+
TRIBECA	B9	Jan 05 →	65	26	TR	50	20	B1			
XV		Mrz 12 →	65	26	B1	40	16	B1	C30	C12	RB
SUZUKI											
ALTO III	EF	Okt 94 → Jun 02	48	19	B1	40	16	B1	C35	C14	RD+
ALTO IV	FF	Jun 02 → Dez 08	45	18	B1	40	16	B1	C25	C10	RD+
ALTO V	GF	Jan 09 →	53	21	B1	35	14	B1	C25	C10	RD+

Spezifikation für Fahrzeuge / Specification for cars • Спецификация автомобилей

Autemarke / car-type марка автомобиля		Baujahr year of manufacture год выпуска	Fahrer / Driver водитель			Beifahrer Passenger пассажир			Heck / Rear заднее стекло C=CLASSIC/F=FLAT		
			cm	inch	Ad	cm	inch	Ad	cm	inch	Ad
BALENO Hatchback	EG	Jul 95 → Mai 02	50	20	B1	45	18	B1	C35	C14	RD+
CAPPUCCINO		1992 → 1995	45	18	B1	40	16	B1			
CARRY Kasten	FD	Jun 99 →	40	16	B1	40	16	B1			
GRAND VITARA I	FT, GT	Mrz 98 → Sep 05	48	19	B1	48	19	B1	C35	C14	RD+
GRAND VITARA II	JT	Okt 05 →	48	19	B1	48	19	B1	C35	C14	RD+
IGNIS	FH	Okt 00 → Sep 03	48	19	B1	45	18	B1	C35	C14	RD+
IGNIS II		Okt 03 → Dez 07	48	19	B1	45	18	B1			
IGNIS III	MF	Aug 16 →	53	21	B1	45	18	B1	C30	C12	RB
JIMNY	FJ	Okt 98 → Okt 08	45	18	B1	40	16	B1			
KIZASHI		Okt 10 →	60	24	B1	50	20	B1			
LIANA	ER	Mrz 02 → Dez 07	56	22	B1	45	18	B1	C25	C10	RD+
LIANA Kombi	ER	Apr 02 → Dez 07	56	22	B1	45	18	B1	C25	C10	RD+
SANTANA 350JLX		2005 →	45	18	B1	45	18	B1			
SPLASH		Jan 08 →	56	22	B1	40	16	B1	C25	C10	RB
SWIFT II	EA, MA	Jun 96 → Dez 04	53	21	B1	43	17	B1	C35	C14	RD+
SWIFT III	MZ, EZ	Feb 05 →	53	21	B1	45	18	B1	C25	C10	RD+
SWIFT IV	FZ, NZ	Okt 10 →	53	21	B1	45	18	B1	C25	C10	RD+
SX4	GY	Jun 06 →	65	26	B1	35	14	B1	C25	C10	RD+
SX4 Stufenheck	GY	Dez 07 →	65	26	B1	35	14	B1	C25	C10	RD+
SX4 S-Cross		Okt 13 →	65	26	B1	35	14	B1	C25	C10	RD+
VITARA	ET	Dez 03 → Dez 05	45	18	B1	45	18	B1			
	LY	Feb 15 →	60	24	B1	40	16	B1			
WAGON R		Jun 04 → Aug 05	50	20	B1	45	18	B1			
WAGON R+	EM	Feb 98 → Mai 00	50	20	B1	45	18	B1			
	MM	Mai 00 → Mrz 06	50	20	B1	45	18	B1			
X-90	EL	Sep 95 → Dez 97	43	17	B1	45	18	B1			
TATA (TELCO)											
GURKHA SUV		1995 →	48	19	B1	48	19	B1			
INDICA Hatchback		1998 → 2001	53	21	B1	53	21	B1			
		2002 →	50	20	B1	50	20	B1			
INDIGO Marina Combi / Estate		2003 →	50	20	B1	50	20	B1			
INDIGO Saloon		2003 →	50	20	B1	50	20	B1			
NANO		2009 →	65	26	B1						
NEW INDIA		2008 →	60	24	B1	38	15	B1			
SAFARI SUV		1998 →	60	24	B1	50	20	B1			
SIERRA		1995 →	48	19	B1	48	19	B1			

A
B
C
D
E
F
G
H
I
J
K
L
M
N
O
P
Q
R
S
T
U
V
W
X
Y
Z

Autemarke / car-type марка автомобиля	Baujahr year of manufacture год выпуска	Fahrer / Driver водитель			Beifahrer Passenger пассажир			Heck / Rear заднее стекло C=CLASSIC / F=FLAT			
		cm	inch	Ad	cm	inch	Ad	cm	inch	Ad	
		... TATA (TELCO)									
XENON		2008 →	50	20	B1	50	20	B1			
TELCO LINE TL Pickup		1999 →	50	20	B1	50	20	B1			
LOADBETA Pickup		1994 →	48	19	B1	48	19	B1			
TESLA											
MODEL 3		Mrz 18 →	65	26	ST	48	19	ST			
MODEL S		Aug 11 →	70	28	TL	45	18	TL			
TOYOTA											
4 RUNNER	N130	1992 →	43	17	B1	43	17	B1			
		Nov 95 → Nov 02	43	17	B1	43	17	B1			
AURIS	E15	Okt 06 → Okt 12	65	26	B1	40	16	B1	C30	C12	RA
	E18	Okt 12 →	65	26	B1	35	14	B1	C30	C12	RA
AURIS TOURING SPORTS	E18	Jul 13 →	65	26	B1	35	14	B1	C30	C12	RA
AVENSIS	T22	Okt 97 → Jan 03	53	21	B1	45	18	B1			
	T25	Apr 03 → Nov 08	60	24	B1	40	16	B1	C40	C16	RD+
	T27	Nov 08 →	65	26	TLA	40	16	TLA			
AVENSIS Liftback	T22	Okt 97 → Jan 03	53	21	B1	45	18	B1			
AVENSIS Station Wagon	T22	Okt 97 → Jan 03	53	21	B1	45	18	B1			
	T25	Apr 03 → Nov 08	60	24	B1	40	16	B1	C30	C12	RA
	T27	Nov 08 →	65	26	TLA	40	16	TLA	C30	C12	RA
AVENSIS Stufenheck	T25	Apr 03 → Nov 08	60	24	B1	40	16	B1			
AVENSIS Verso		Aug 01 → Nov 09	65	26	B1	40	16	B1			
AYGO	B4	Mai 14 →	65	26	PT				C30	C12	RA
CAMRY	V1	Jun 91 → Aug 96	53	21	B1	45	18	B1			
	V2	Aug 96 → Nov 01	53	21	B1	48	19	B1			
	V3	Nov 01 → Nov 06	56	22	B1	50	20	B1			
CAMRY Station Wagon	V1	Mrz 92 → Jul 96	53	21	B1	45	18	B1			
CARINA E	T19	Apr 92 → Sep 97	53	21	B1	45	18	B1			
CELICA	AT20, ST20	Dez 93 → Jul 99	53	21	B1	48	19	B1			
	ZZT23	Aug 99 → Sep 05	65	26	B1	40	16	B1			
C-HR		Okt 16 →	65	26	TLC	40	16	TLC	C35	C14	RA

SPEZIFIKATION FÜR FAHRZEUGE / Specification for cars • Спецификация автомобилей

Autemarke / car-type марка автомобиля		Baujahr year of manufacture год выпуска	Fahrer / Driver водитель			Beifahrer Passenger пассажир			Heck / Rear заднее стекло C=CLASSIC/F=FLAT		
			cm	inch	Ad	cm	inch	Ad	cm	inch	Ad
COROLLA	E10	Jul 92 → Apr 94	50	20	B1	45	18	B1			
	E11	Apr 97 → Sep 01	50	20	B1	45	18	B1			
	E12	Jan 02 → Feb 07	56	22	B1	48	19	B1			
Jan 02 → Dez 06		60	24	B1	40	16	B1				
COROLLA Kombi	E12	Aug 02 → Feb 07	56	22	B1	48	19	B1			
COROLLA Kombi / Schrägheck	E21	Feb 19 →	70	28	B1	35	14	B1	C30	C12	RA
COROLLA Stufenheck	E12	Aug 02 → Feb 07	56	22	B1	48	19	B1			
	E18	Jun 13 →	65	26	B1	35	14	B1			
	E21	Jan 19 →	70	26	B1	35	14	B1			
COROLLA Verso	E12	Jan 02 → Jan 04	65	26	B1	40	16	B1	C35	C14	RD+
		Apr 04 → Feb 09	65	26	B1	40	16	B1	C30	C12	RA
DYNA 150 Pritsche/Fahrgestell	LY	Mai 95 → Jul 01	43	17	B1	43	17	B1			
DYNA Bus		Mai 95 → Jul 01	43	17	B1	43	17	B1			
DYNA Pritsche		Sep 06 →	50	20	B1	50	20	B1			
GT 86 Coupe	ZN6	Mrz 12 →	53	21	B1	50	20	B1			
HIACE III		Aug 96 → Apr 98	53	21	B1	53	21	B1			
HIACE IV	LH1	Aug 96 →	53	21	B1	53	21	B1			
HIACE IV Bus	LH1	Aug 95 → Jul 96	50	20	B1	45	18	B1			
HIACE IV Pritsche/Fahrgestell	LXH1	Aug 95 → Aug 01	53	21	B1	53	21	B1			
HIACE V Kasten		Jan 05 →	53	21	B1	53	21	B1			
HILUX III Pick-up		Jun 06 →	53	21	B1	48	19	B1			
IQ		Jan 09 → Mai 14	53	21	B1	45	18	B1	C25	C10	RA
LAND CRUISER	VDJ20, UZJ20	Jan 08 →	60	24	B1	53	21	B1	C35	C14	RD+
LAND CRUISER 80	J8	Jan 90 → Dez 97	45	18	B1	45	18	B1			
LAND CRUISER 90	J9	Apr 96 → Dez 06	48	19	B1	45	18	B1			
LAND CRUISER 100		Jan 98 → Jul 08	60	24	B1	53	21	B1	C35	C14	RD+
LAND CRUISER 150		Jan 10 →	65	26	B1	50	20	B1	C30	C12	RA
LITEACE Box	R2, V	Jan 92 → Jan 95	45	18	B1	38	15	B1			
LITEACE Bus	R2, LG	Jan 92 → Jan 95	45	18	B1	38	15	B1			
MIRAI	JPD1	Okt 14 →	65	26	TLC	50	20	TLC			
MR 2 III	ZZW3	Dez 99 → Mai 06	50	20	B1	48	19	B1			
PASEO	EL54	Aug 95 → Jul 99	50	20	B1	45	18	B1			
PASEO Cabrio	EL54	Okt 96 → Mrz 99	50	20	B1	45	18	B1			

A
B
C
D
E
F
G
H
I
J
K
L
M
N
O
P
Q
R
S
T
U
V
W
X
Y
Z

Autemarke / car-type марка автомобиля		Baujahr year of manufacture год выпуска	Fahrer / Driver водитель			Beifahrer Passenger пассажир			Heck / Rear заднее стекло C=CLASSIC / F=FLAT		
			cm	inch	Ad	cm	inch	Ad	cm	inch	Ad
... TOYOTA											
PICNIC	M10	Sep 97 → Mai 01	60	24	B1	40	16	B1	C40	C16	RD+
PREVIA		Aug 00 → Jan 06	70	28	TR	45	18	B1	C40	C16	RD+
PRIUS	ZVW3	Apr 09 →	65	26	B1	40	16	B1			
PRIUS Liftback	NHW20	Sep 03 → Mrz 09	65	26	B1	40	16	B1	C40	C16	RD+
PRIUS PHV	W52	Jan 16 →	70	28	TLC	40	16	TLC			
PRIUS Stufenheck	NHW11	Sep 00 → Aug 03	60	24	B1	40	16	B1			
PROACE Kasten/Kombi		Jun 13 →	65	26	B1	50	20	B1			
RAV 4	SXA1	Jun 94 → Jun 00	50	20	B1	45	18	B1			
RAV 4 II		Jun 00 → Nov 05	60	24	B1	48	19	B1	C30	C12	RA
RAV 4 III		Mrz 06 → Nov 12	60	24	B1	40	16	B1	C30	C12	RA
RAV 4 IV		Dez 12 →	65	26	B1	40	16	B1			
STARLET	EP91	Apr 96 → Mrz 99	50	20	B1	43	17	B1			
SUPRA	JZA80	Mai 93 → Aug 02	53	21	B1	50	20	B1	45	18	B1
		Mrz 19 →	58	23	TLC	53	21	TLC			
URBAN CRUISER		Apr 09 →	60	24	B1	35	14	B1	C25	C10	RD+
VERSO	R2	Apr 09 →	65	26	B1	40	16	B1	C25	C10	RD+
VERSO S	P12	Nov 10 →	70	28	B1						
YARIS	P1	Apr 01 → Sep 05	53	21	B1	35	14	B1	C30	C12	RA
	P9	Dez 05 → Jul 11	60	24	B1	35	14	B1	C30	C12	RE
	P13	Sep 11 →	70	28	B1				C30	C12	RD+
	P21, PA1, PH1	Feb 20 →	60	24	B1	40	16	B1	C25	C10	RA
YARIS Verso	P2	Mrz 00 → Sep 05	56	22	B1	40	16	B1	C40	C16	RD+
TRABANT											
TRABANT 1.1		Mai 90 → Dez 91	28	11	B1	28	11	B1			
VOLKSWAGEN											
AMAROK	2H, S1B	Dez 10 → Apr 12	60	24	B1	50	20	B1			
		Mai 12 →	60	24	ST	60	24	ST			
ARTEON	3H7, 3H8, 3H9	Mrz 17 →	65	26	ST	48	19	ST			
BEETLE	5C1	Apr 11 →	53	21	ST	53	21	ST			
BEETLE Cabriolet	5C7	Dez 12 →	53	21	ST	53	21	ST			
BORA	1J2	Okt 98 → Mai 02	53	21	B1	48	19	B1			
		Jun 02 → Mai 05	53	21	SL	48	19	SL			
BORA Kombi	1J6	Mai 99 → Mai 02	53	21	B1	48	19	B1	C35	C14	RD+

SPEZIFIKATION FÜR FAHRZEUGE / Specification for cars • Спецификация автомобилей

Autemarke / car-type марка автомобиля		Baujahr year of manufacture год выпуска	Fahrer / Driver водитель			Beifahrer Passenger пассажир			Heck / Rear заднее стекло C=CLASSIC/F=FLAT		
			cm	inch	Ad	cm	inch	Ad	cm	inch	Ad
BORA Kombi	1J6	Jun 02 → Mai 05	53	21	SL	48	19	SL	C35	C14	RD+
CADDY II Kasten	9K9B	Nov 95 → Sep 05	53	21	B1	45	18	B1	45	18	B1
CADDY II Kombi	9K9A	Nov 95 → Okt 05	53	21	B1	45	18	B1	45	18	B1
CADDY II Pickup	9U7	Jun 96 → Dez 00	53	21	B1	45	18	B1			
CADDY III Kasten	2KA	Mrz 04 → Okt 06	60	24	SL	45	18	SL	C40	C16	RD+
		Nov 06 → Aug 10	60	24	TL	45	18	TL	C40	C16	RD+
CADDY III Kombi	2KB	Mrz 04 → Okt 06	60	24	SL	45	18	SL	C40	C16	RD+
		Nov 06 → Aug 10	60	24	TL	45	18	TL	F40	F16	R3
CADDY IV Kasten	2CA	Sep 10 → Mai 15	60	24	TL	45	18	TL	C40	C16	RD+
CADDY IV Kombi	2CB	Sep 10 → Mai 15	60	24	TL	45	18	TL	F40	F16	R3
CADDY V Kasten	SA	Mai 15 → Mai 17	60	24	TL	45	18	TL	C40	C16	RD+
		Jun 17 →	60	24	ST	45	18	ST	C40	C16	RD+
CADDY V Kombi	SA	Mai 15 → Mai 17	60	24	TL	45	18	TL	F40	F16	R3
		Jun 17 →	60	24	ST	45	18	ST	F40	F16	R3
CARAVELLE T4	70, 7D	Sep 90 → Jun 03	53	21	B1	53	21	B1	C40	C16	RD+
CARAVELLE T5	7H	Feb 03 → Nov 09	60	24	B1	53	21	B1	F40	F16	R3
		Feb 03 → Nov 09	60	24	SL	60	24	SL	F40	F16	R3
	7E	Sep 09 → Mai 13	60	24	B1	53	21	B1	F40	F16	R3
		Jun 13 → Aug 15	60	24	ST	60	24	ST	F40	F16	R3
CARAVELLE T6	SG	Apr 15 →	60	24	ST	60	24	ST	F40	F16	R2
CC	358	Nov 11 → Dez 16	60	24	ST	48	19	ST			
CRAFTER		Apr 06 →	65	26	PT	60	24	PT	F40	F16	R1
EOS	1F7, 1F8	Mai 06 →	60	24	TL	48	19	TL			
FOX	5Z1, 5Z3	Apr 05 → Dez 12	53	21	B1	38	15	B1			
GOLF PLUS	5M1	Jan 05 → Jan 09	70	28	SL	70	28	SL	F30	F12	R3
	521	Jan 09 → Feb 14	70	28	SL	70	28	SL	F30	F12	R2
GOLF SPORTSVAN		Feb 14 →	70	28	ST	40	16	ST	F30	F12	R2
GOLF III	1H1	Nov 91 → Aug 97	53	21	B1	48	19	B1	C35	C14	RD+
GOLF III Cabriolet	1E7	Sep 93 → Mrz 98	53	21	B1	48	19	B1			
GOLF III Variant	1H5	Jul 93 → Feb 99	53	21	B1	48	19	B1	C35	C14	RD+
GOLF IV	1J1	Okt 97 → Mai 02	53	21	B1	48	19	B1	C35	C14	RD+
		Jun 02 → Jun 05	53	21	SL	48	19	SL	C35	C14	RD+
GOLF IV Cabriolet	1E7	Jun 98 → Jun 02	53	21	B1	48	19	B1			
GOLF IV Variant	1J5	Mai 99 → Mai 02	53	21	B1	48	19	B1	C35	C14	RD+
		Jun 02 → Jun 06	53	21	SL	48	19	SL	C35	C14	RD+
GOLF V	1K1	Okt 03 → Okt 05	60	24	SL	48	19	SL	F30	F12	R2
		Nov 05 → Nov 08	60	24	TL	48	19	TL	F30	F12	R3

A
B
C
D
E
F
G
H
I
J
K
L
M
N
O
P
Q
R
S
T
U
V
W
X
Y
Z

Automarke / car-type марка автомобиля	Baujahr year of manufacture год выпуска	Fahrer / Driver водитель			Beifahrer Passenger пассажир			Heck / Rear заднее стекло C=CLASSIC / F=FLAT			
		cm	inch	Ad	cm	inch	Ad	cm	inch	Ad	
... VOLKSWAGEN											
GOLF V Variant	1K5	Jun 07 → Jul 09	60	24	TL	48	19	TL	F30	F12	R3
GOLF VI	5K1	Okt 08 → Nov 12	60	24	TL	48	19	TL	F25	F10	R2
GOLF VI Cabriolet	517	Mrz 11 →	60	24	ST	48	19	ST			
GOLF VI Variant	AJ5	Jul 09 → Apr 13	60	24	TL	48	19	TL	F25	F10	R2
GOLF VII	6G1	Nov 12 →	65	26	ST	45	18	ST	F30	F12	R2
GOLF VII Kombi	BA5	Apr 13 →	65	26	ST	45	18	ST	F30	F12	R2
GOLF VIII	CD1	Jul 19 →	65	26	ST	45	18	ST			
GOLF VIII Variant		Aug 20 →	65	26	ST	45	18	ST			
ID.3		Jun 20 →	76	30	ST	76	30	ST			
JETTA III	1K2	Aug 05 → Nov 05	60	24	SL	48	19	SL			
		Dez 05 → Okt 10	60	24	TL	48	19	TL			
JETTA IV	162, 163	Dez 10 →	60	24	ST	48	19	ST			
LUPO	6E1, 6X1	Okt 98 → Mai 03	53	21	B1	48	19	B1	28	11	B1
		Jun 03 → Jul 05	48	19	SL	48	19	SL	28	11	B1
LT II	28-35	Mai 96 → Apr 06	60	24	B1	53	21	B1			
MULTIVAN T4	70, 7D	Jul 90 → Apr 03	53	21	B1	53	21	B1	C40	C16	RD+
MULTIVAN T5	7H	Feb 03 → Nov 09	60	24	B1	53	21	B1	F40	F16	R3
		Feb 03 → Nov 09	60	24	SL	60	24	SL	F40	F16	R3
	7E	Sep 09 → Mai 13	60	24	B1	53	21	B1	F40	F16	R3
		Jun 13 → Aug 15	60	24	ST	60	24	ST	F40	F16	R3
MULTIVAN T6	SG	Apr 15 →	60	24	ST	60	24	ST	F40	F16	R2
NEW BEETLE	9C1, 1C1	Jan 98 → Sep 10	53	21	B1	53	21	B1			
NEW BEETLE Cabriolet	1Y7	Sep 02 → Okt 10	53	21	B1	53	21	B1			
PASSAT	3B2	Jun 97 → Nov 00	53	21	B1	53	21	B1			
		Nov 00 → Mai 02	53	21	B1	53	21	B1			
	3B3	Nov 01 → Mai 05	53	21	SL	50	20	SL			
		3C2	Mrz 05 → Jul 10	60	24	TL	48	19	TL		
	362	Aug 10 → Nov 11	60	24	TL	48	19	TL			
		Jul 11 → Dez 14	60	24	ST	48	19	ST			
3G2	Nov 14 →	65	26	ST	45	18	ST				
PASSAT ALLTRACK	365	Jan 12 → Dez 14	60	24	ST	48	19	ST	F25	F10	R3
PASSAT CC	357	Mai 08 → Nov 11	60	24	TL	48	19	TL			
		Dez 11 → Mai 12	60	24	ST	48	19	ST			
PASSAT Variant	3B5	Jun 97 → Nov 00	53	21	B1	53	21	B1	38	15	B1
	3B6	Nov 00 → Mai 02	53	21	B1	53	21	B1	C35	C14	RD+

SPEZIFIKATION FÜR FAHRZEUGE / Specification for cars • Спецификация автомобилей

Automarke / car-type марка автомобиля		Baujahr year of manufacture год выпуска	Fahrer / Driver водитель			Beifahrer Passenger пассажир			Heck / Rear заднее стекло C=CLASSIC/F=FLAT		
			cm	inch	Ad	cm	inch	Ad	cm	inch	Ad
PASSAT Variant	3B6	Nov 01 → Mai 05	53	21	SL	50	20	SL	C35	C14	RD+
	3C5	Aug 05 → Nov 10	60	24	TL	48	19	TL	F25	F10	R3
	365	Aug 10 → Nov 11	60	24	TL	48	19	TL	F25	F10	R3
		Jul 11 → Dez 14	60	24	ST	48	19	ST	F25	F10	R3
3G5	Nov 14 →	65	26	ST	45	18	ST	F25	F10	R3	
POLO	6N1	Okt 94 → Okt 99	48	19	B1	48	19	B1			
	6N2	Okt 99 → Sep 01	48	19	B1	48	19	B1			
	9N1	Okt 01 → Mai 02	53	21	B1	48	19	B1			
		Jun 02 → Mai 05	53	21	SL	48	19	SL			
	9N3	Mai 05 → Nov 09	53	21	TL	48	19	TL	F30	F12	R3
	6R, 6C	Jun 09 →	60	24	ST	40	16	ST	F25	F10	R2
	AW1	Jun 17 →	60	24	ST	45	18	ST	F30	F12	R2
POLO Stufenheck	9A4	Jun 02 → Mai 07	53	21	SL	48	19	SL			
SCIROCCO	137, 138	Aug 08 →	60	24	TL	48	19	TL	F25	F10	R2
SHARAN	7M8	Sep 95 → Feb 02	70	28	TR	65	26	TR	C40	C16	RD+
	7M9, 7M6	Mai 00 → Mai 01	70	28	TR	65	26	TR	C40	C16	RD+
		Jun 01 → Mrz 10	70	28	SL	70	28	SL	C40	C16	RD+
	7N1	Mai 10 → Nov 15	70	28	ST	40	16	ST	F30	F12	R2
	7N2	Mai 15 →	70	28	ST	40	16	ST	F30	F12	R2
T-CROSS	C11	Dez 18 →	60	24	ST	45	18	ST	F25	F10	R2
TIGUAN	5N1	Nov 07 → Nov 11	60	24	TL	53	21	TL	F35	F14	R3
	5N2	Mai 11 →	60	24	TL	53	21	TL	F35	F14	R3
	AD1	Feb 16 →	65	26	ST	53	21	ST	F35	F14	R2
	BT1	Nov 16 →	60	24	ST	56	22	ST	F38	F15	R2
TOUAREG	7LA, 7L6, 7L7	Dez 06 → Mai 10	65	26	SL	65	26	SL	F30	F12	R3
	7P5, 7P6	Mrz 10 → Dez 18	65	26	SL	65	26	SL	F38	F15	R0
	CR7	Jun 18 →	65	26	ST	53	21	ST	F38	F15	R2
TOURAN	1T1	Feb 03 → Nov 06	60	24	SL	45	18	SL	F40	F16	R3
		Feb 03 → Nov 06	70	28	SL	70	28	SL	F40	F16	R3
	1T2	Nov 06 → Mai 10	60	24	TL	45	18	TL	F40	F16	R3
		Nov 06 → Mai 10	70	28	SL	70	28	SL	F40	F16	R3
	1T3	Mai 10 → Mai 15	60	24	TL	45	18	TL	F30	F12	R2
	5T1	Mai 15 →	70	28	ST	40	16	ST	F30	F12	R2
	TRANSPORTER T4	70, 7D	Sep 90 → Aug 04	53	21	B1	53	21	B1	C40	C16
TRANSPORTER T5	7H	Feb 03 → Nov 09	60	24	B1	53	21	B1	F40	F16	R3
	7H	Feb 03 → Nov 09	60	24	SL	53	21	SL	F40	F16	R3

A
B
C
D
E
F
G
H
I
J
K
L
M
N
O
P
Q
R
S
T
U
V
W
X
Y
Z

Automarke / car-type марка автомобиля		Baujahr year of manufacture год выпуска	Fahrer / Driver водитель			Beifahrer Passenger пассажир			Heck / Rear заднее стекло C=CLASSIC / F=FLAT		
			cm	inch	Ad	cm	inch	Ad	cm	inch	Ad
... VOLKSWAGEN											
TRANSPORTER T5	7J	Jun 03 → Nov 09	60	24	B1	56	22	B1	F40	F16	R3
		Jun 03 → Nov 09	60	24	SL	60	24	SL	F40	F16	R3
	7E	Sep 09 → Mai 13	60	24	B1	53	21	B1	F40	F16	R3
		Jun 13 → Aug 15	60	24	ST	60	24	ST	F40	F16	R3
TRANSPORTER T6	8G	Apr 15 →	60	24	ST	60	24	ST	F40	F16	R2
T-ROC	A11	Jul 17 →	65	26	ST	48	19	ST	F30	F12	R2
UP! / eUP	121, 122, BL1, BL2, BL3, 123	Dez 11 →	60	24	ST	40	16	ST	F25	F10	R2
VENTO	1H2	Nov 91 → Dez 97	53	21	B1	48	19	B1			
VOLVO											
850 / 850 Kombi	LS / LW	Jun 91 → Okt 97	53	21	B1	53	21	B1			
940 / 940 Kombi	944 / 945	Aug 90 → Jul 95	50	20	B1	50	20	B1			
940 II / 940 II Kombi	944 / 945	Aug 94 → Okt 98	50	20	B1	50	20	B1			
960 / 960 Kombi	964 / 965	Aug 90 → Dez 96	53	21	B1	53	21	B1			
C30		Okt 06 → Jul 10	65	26	TL	50	20	TL	F40	F16	R0
		Aug 10 →	65	26	TL	50	20	TL			
C70 Coupe		Jan 97 → Jul 02	53	21	B1	53	21	B1			
C70 I Cabriolet		Feb 98 → Mrz 06	53	21	B1	53	21	B1			
C70 II Cabriolet		Mrz 06 → Jul 10	65	26	TL	48	19	TL			
S40 I	VS	Sep 95 → Dez 03	53	21	B1	50	20	B1			
S40 II	MS	Dez 03 → Jul 05	65	26	SL	50	20	SL			
		Aug 05 → Dez 12	65	26	TL	50	20	TL			
S60 I		Nov 00 → Jul 04	60	24	B1	53	21	B1			
		Aug 04 → Jul 09	60	24	PT	53	21	PT			
S60 II		Aug 10 →	65	26	TL	50	20	TL			
S70	LS	Jan 97 → Jul 00	53	21	B1	53	21	B1			
S80 I	TS, XY	Aug 98 → Jul 04	60	24	B1	56	22	B1			
		Mrz 04 → Jul 06	60	24	PT	53	21	PT			
S80 II	AS	Aug 06 →	65	26	TL	50	20	TL			
S90		Jan 97 → Mai 98	53	21	B1	53	21	B1			
		234	Jan 16 →	60	24	ST	50	20	ST		
V 40 Cross Country		Jan 13 →	65	26	TL	48	19	TL	F25	F10	R3
V40 I		Jan 95 → Jun 04	50	20	B1	50	20	B1			
V40 II		Sep 12 →	65	26	TL	48	19	TL	F25	F10	R3
V50	MW	Apr 04 → Jul 05	65	26	SL	50	20	SL			

СПЕЦИФИКАЦИЯ ФÜR FAHRZEUGE / Specification for cars • Спецификация автомобилей

Autemarke / car-type марка автомобиля		Baujahr year of manufacture год выпуска	Fahrer / Driver водитель			Beifahrer Passenger пассажир			Heck / Rear заднее стекло C=CLASSIC / F=FLAT		
			cm	inch	Ad	cm	inch	Ad	cm	inch	Ad
V50	MW	Aug 05 → Dez 12	65	26	TL	50	20	TL			
V60		Sep 10 → Jun 15	65	26	TL	50	20	TL			
		Jul 15 →	65	26	TL	50	20	TL	C30	C12	RD
V70 II	SW	Mrz 00 → Jul 04	60	24	B1	53	21	B1	C35	C14	RD
		Aug 04 → Jul 07	60	24	PT	53	21	PT	C35	C14	RD
V70 III	BW	Aug 07 →	65	26	TL	50	20	TL	F35	F14	R0
V90	235, 236	Nov 96 → Dez 98	53	21	B1	53	21	B1			
		Mrz 16 →	60	24	ST	50	20	ST	C35	C14	R0
XC40	536	Okt 17 →	60	24	ST	50	20	ST	F35	F14	R0
XC60 I		Mrz 09 → Jul 10	65	26	TL	50	20	TL	F38	F15	R0
		Aug 10 → Jul 17	65	26	TL	50	20	TL	C35	C14	RD
XC70		Nov 97 → Mrz 00	53	21	B1	53	21	B1	43	17	B1
XC70 I		Sep 00 → Jul 04	60	24	B1	53	21	B1	C40	C16	RD+
		Aug 04 → Jul 07	60	24	PT	53	21	PT	C35	C14	RD
XC70 II		Aug 07 →	65	26	TL	50	20	TL	F35	F14	R0
XC90 I		Okt 02 → Jul 04	60	24	B1	56	22	B1	C35	C14	RD
		Aug 04 → Jul 06	60	24	PT	53	21	PT	C35	C14	RD
		Aug 06 → Jul 10	60	24	PT	53	21	PT	F38	F15	R0
		Aug 10 → Jul 16	60	24	PT	53	21	PT	C35	C14	RD
XC90 II		Jun 15 →	60	24	ST	50	20	ST	F35	F14	R0

HEYNER GMBH • Kurzer Weg 1-5 • 15859 Storkow | STAND 12/2020

BITTE BEACHTEN SIE: In allen Einzelverpackungen ist der HOOK ONE-Adapter (B1) enthalten. Dieser Adapter ist geeignet für alle Fahrzeuge mit Wischerarm Typ Haken. In allen Einzelverpackungen der Größen 330mm/13", 350mm/14", 380mm/15", 500mm/20" und 530mm/21" ist außerdem ein Adapter G1 enthalten, der hauptsächlich für Fahrzeuge Typ Lada geeignet ist. Für Fahrzeuge mit anderen Wischerarmkonstruktionen sind Spezialadapter notwendig. Diese sind separat erhältlich. TOP LOCK B Adapter (TLB) ist nur für das Sortiment HYBRID, ALL SEASONS, SUPER FLAT PREMIUM & SUPER FLAT geeignet. Die Spezifikation enthält Hinweise zur Verwendung unserer Wischerblätter. Viele Fahrzeughersteller ändern jedoch häufig Bauart und Befestigung der Wischerblätter, so dass wir für die Richtigkeit nicht garantieren können. Bitte prüfen Sie vor dem Kauf, ob dieses Wischerblatt für Ihr Fahrzeug geeignet ist.

ATTENTION PLEASE: All colour boxes include HOOK ONE-adapter (B1), which is suitable for all cars with hook-type wiper-arm. All colour boxes of sizes 330mm/13", 350mm/14", 380mm/15", 500mm/20" and 530mm/21" include an additional adapter G1, which is mainly suitable for Lada cars. For cars with special wiper arm construction special adapters are required and available separately. TOP LOCK B (TLB) adapter is suitable for the HYBRID, ALL SEASONS, SUPER FLAT PREMIUM & SUPER FLAT assortments only. Specification for cars could help you to use our wiper blades. However, many car producers change construction and fixing of wiper blades frequently. That is why we cannot guarantee the correctness. Before buying, please check what sort of wiper blade is needed for your car.

ПОЖАЛУЙСТА, ОБРАТИТЕ ВНИМАНИЕ: Во всех отдельных упаковках щётки включён HOOK ONE адаптер (B1). Этот адаптер подходит для всех автомобилей с поводком стеклоочистителя типа крючок. Во всех отдельных упаковках размеров 330мм/13", 350мм/14", 380мм/15", 500мм/20" и 530мм/21" кроме того находится адаптер G1, который преимущественно подходит для автомобилей Lada. Для транспортных средств с другими конструкциями рычага стеклоочистителя необходимы специальные адаптеры. Они продаются отдельно. TOP LOCK B (TLB) адаптер подходит только для assortментов HYBRID, ALL SEASONS, SUPER FLAT PREMIUM & SUPER FLAT. Спецификация автомобилей включает указания по использованию наших щёток стеклоочистителя. Многие автопроизводители часто меняют конструкцию и вид крепления щеток стеклоочистителя, поэтому мы не всегда можем гарантировать правильность данных. Пожалуйста, проверяйте перед покупкой, подходит ли эта щётка для вашего автомобиля.

A
B
C
D
E
F
G
H
I
J
K
L
M
N
O
P
Q
R
S
T
U
V
W
X
Y
Z



Ihr Vorteil:

**Mit nur einem Sortiment
+ Adapter können Sie
99% aller Fahrzeuge bestücken**

**Your advantage:
With only one assortment + adapter
you can equip 99% of all vehicles**

**Ваше преимущество:
Только один ассортимент
+ адаптеры и Вы можете
оснастить 99% всех моделей
автомобилей**



Bitte beachten Sie: Der Scheibenwischergummi unserer Flat blade-Scheibenwischer wird durch eine Kunststoffschiene geschützt. Diese muss vor der Benutzung entfernt werden!

In case, the rubber of the new wiper blade is protected by a plastic rail, please remove it.

Если резинка щётки Вашего нового стеклоочистителя защищена пластмассовым чехлом, снимите его.







HOOK ONE Cover nur bei HYBRID, ALL SEASONS, SUPER FLAT PREMIUM & SUPER FLAT anwendbar • HOOK ONE Cover can be used on HYBRID, ALL SEASONS, SUPER FLAT PREMIUM & SUPER FLAT only • HOOK ONE Cover можно использовать только на HYBRID, ALL SEASONS, SUPER FLAT PREMIUM & SUPER FLAT.





nur bei HYBRID, ALL SEASONS, SUPER FLAT PREMIUM & SUPER FLAT anwendbar • can be used on HYBRID, ALL SEASONS, SUPER FLAT PREMIUM & SUPER FLAT only • можно использовать только на HYBRID, ALL SEASONS, SUPER FLAT PREMIUM & SUPER FLAT

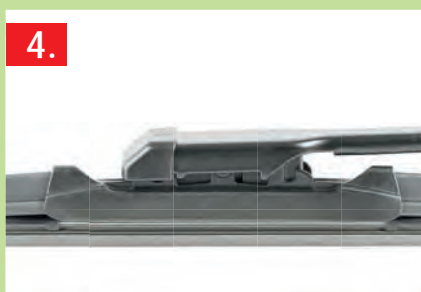
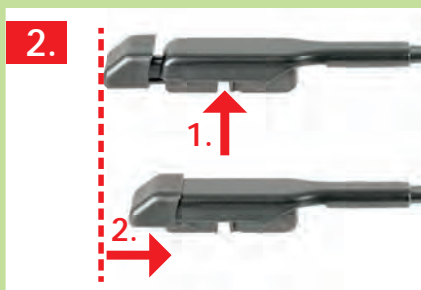





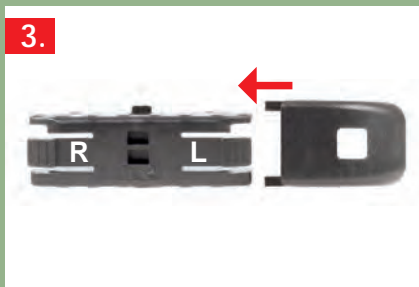
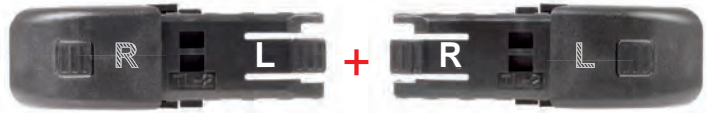

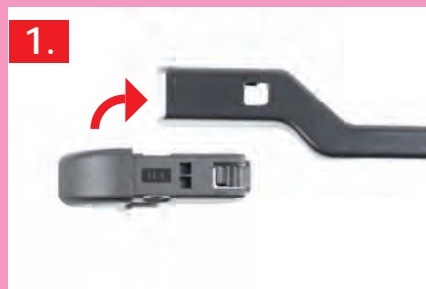



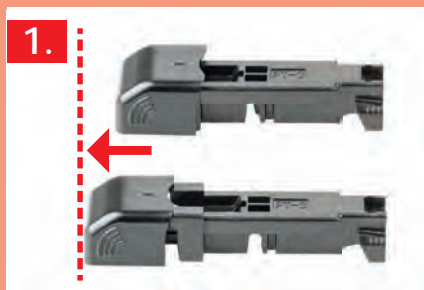
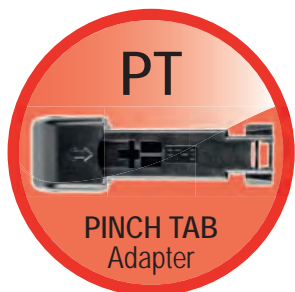



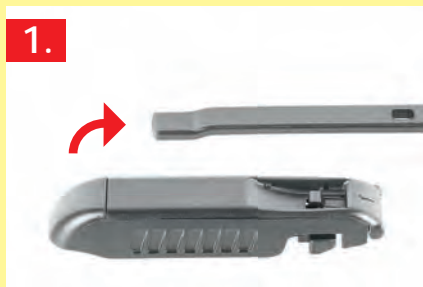







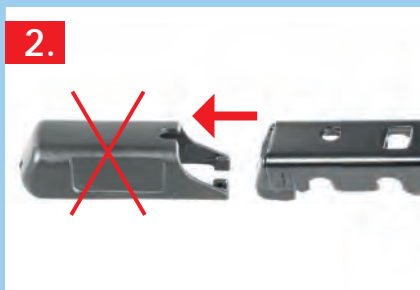
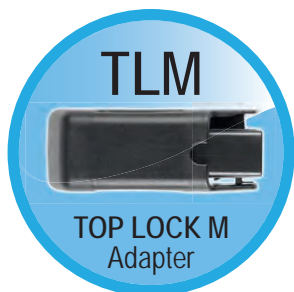





Spezifikation für Fahrzeuge 2021/2022
specification for cars • спецификация автомобилей



AUCH ONLINE! FIND ON WEBSITE!
ТАКЖЕ НА САЙТЕ!

Scheibenwischer finden - ganz einfach.
The easy way to find a wiper blade.
Простой способ найти щётку.

www.alca-germany.com